



Product Catalog

2024



Medical Solutions

I N T E R N A T I O N A L





Medical Solutions International has been privileged to serve the dialysis community since 1989. We designed and manufactured the first commercial Bicarbonate Mixing and Distribution System, the first commercial Acidified Distribution systems and the first dialysis specific commercial Patient Wall Station.

We have built our business on the faith and trust of our dialysis customers. Our innovative equipment designs were improved over the years by listening to our customers needs and performance expectations.

We will continue to strive to be innovative and reactive to our customers. Please feel free to contact us if you have an idea that you feel could be developed to better serve the dialysis community.



Medical Solutions

I N T E R N A T I O N A L

TABLE OF CONTENTS

Call: 1-800-326-5275
 Available Monday thru
 Friday 8:00AM-4:00PM CST

Email: sales@medicalsolutionskc.com
 Customer support available
 Monday thru Friday 8:00AM-4:00pm CST

Catalog also available on-line
www.medicalsolutionskc.com

SDS-CB200 DUAL TANK BICARB SYSTEM	1
NEW PRODUCTS -RACK, BLEACH CAP, ETC	2
CITRIC JUG TEE, JUG CAP & JUG TAP	3
ACID CABINET & CHLORINE TIMER	4
MR. ACID	5
CRANK HOLDER/SAMPLE CENTER	6
OZONE ACCESSORIES	7
WALL TECH STATION	8-12
WALL TECH STATION ADAPTERS	13-16
CLEAR SCREEN PROTECTOR	17
BICARB SYSTEM ACCESSORIES	18-20
FUSES / SWITCHES / SENSORS	21
ELECTRICAL	22
PRESSURIZED PRODUCTS	23
CAMLOCKS / BANJO BULKHEAD	24
FILTERS	25
PUMPS	26-27
HOSE / CLAMPS / CLICS	28
TUBING	29
PVC SCHEDULE 80 FITTINGS	30-41
NIPPLES	42-44
BALL VALVES	45
CHECK VALVES / GATE VALVES	46
BARBED FITTINGS	47
QUICK DISCONNECT FITTINGS	48-59
PARKER FITTINGS	60-62
MUR-LOK	63-66
GARDEN HOSE FITTINGS	67
TANKS	68
ORDER FORM	69

Medical Solutions

INTERNATIONAL

Bicarbonate Mixing & Distribution System



Dual Tank Bicarbonate Mixing and Pressurized Distribution System

These systems have 25 to 100 gallon mixing capacity, with electronic fill and dispense options, variable batch size, internally balanced agitation, sanitization/disinfection mode, a .2 micron air filter, and timed cycle processing, they employ two 100 gallon tanks, one for mixing and one for distribution. With this system, you may effectively reconstitute dialysate powders in a closed system with a managed fill to accomplish predictable/reproducible batch quality.

The systems are designed for low volume, low pressure dynamic distribution of mixed Bicarb concentrate to patient stations. The systems lend themselves to simple, complete sanitization and effective rapid rinse. The system is

SDS-CB200 DUAL TANK BICARBONATE MIXING & DISTRIBUTION 1

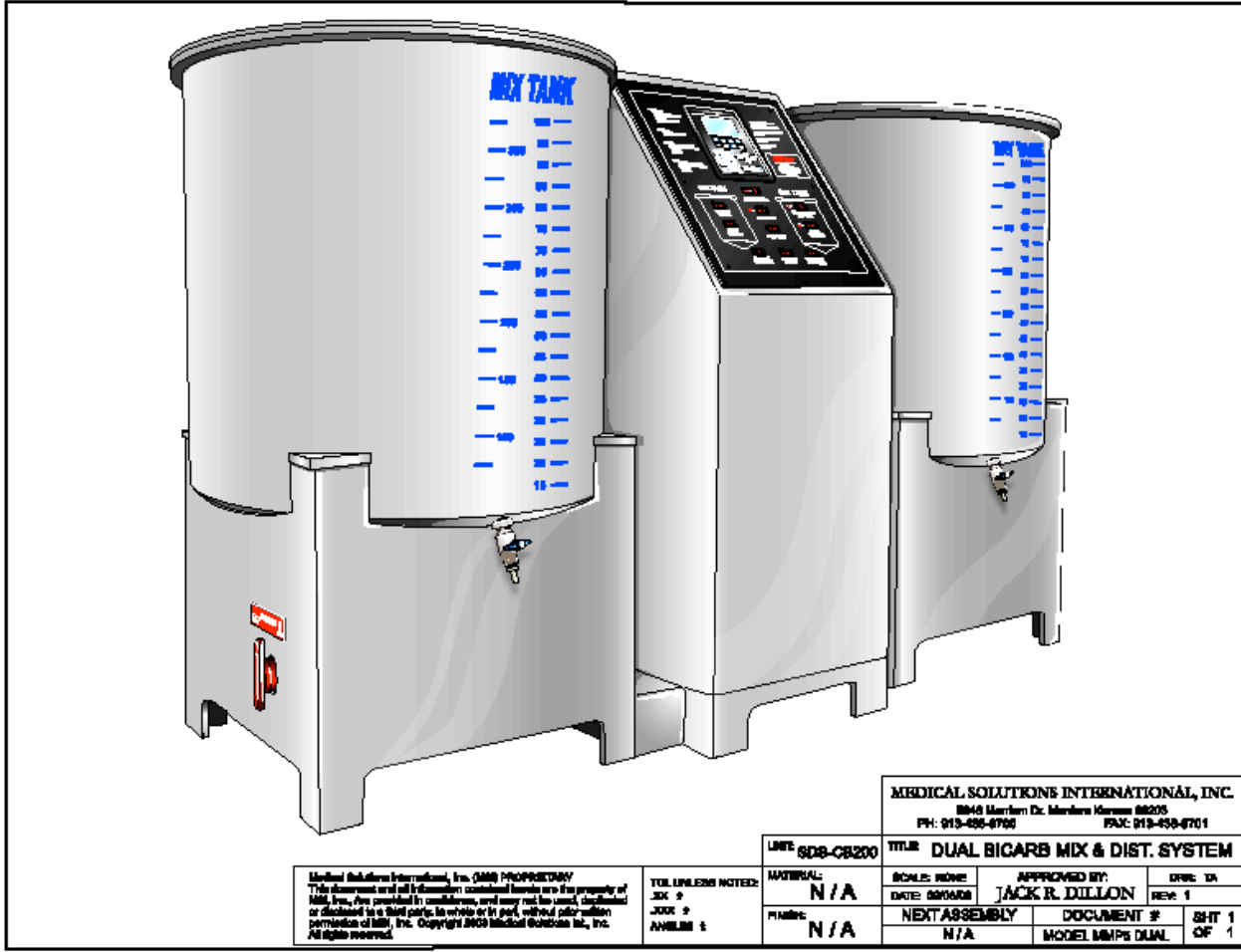

CALL FOR BICARBONATE SYSTEMS QUOTATIONS

ELECTRICAL CONTROL BOXES		
PART NUMBER	PRODUCT DESCRIPTION	PRICE \$
M-RA02	Bicarb Remote Alarm with Reset Mute	641.25



MEDICAL SOLUTIONS INTERNATIONAL
 5646 MERRIAM DRIVE
 MERRIAM, KS 66203
www.medicalsolutionskc.com

800.326.5275
 913.438.9700
 FAX K

NEW PRODUCTS

2

We Create Solutions

THE PROBLEM



Your Bottle...
No Stand...
Your Mess...

THE SOLUTION



Your Bottle...
Our Stand... CCS-1
No Mess...

But Wait, There's More



Your Bottle...
Our Stand... CCS-1
Plus our "Y"
Connector... CAT-4

CitruClean Stand

"It Just Keeps Getting Better"



medicalsolutionskc.com 800-326-5275

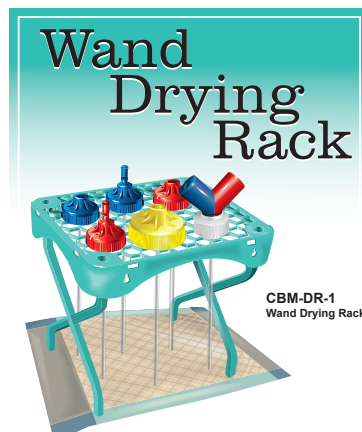

Wand Drying Rack

CBM-DR-1
Wand Drying Rack



medicalsolutionskc.com 800-326-5275

PROTECT YOUR SWITCHES

We have all experienced a PANIC 5am call when a machine won't come up!!!
Avoid early calls because housekeeping turned off a switch when moving a machine.
Protect the switch, Protects your sleep! Try this easy see through cover!!



Part #
SP-VD100



medicalsolutionskc.com 800-326-5275, 913-438-9700

DRAIN HOSE CONTROL FOR ACUTE TREATMENT

Butterfly Hose Holder



DHH-1

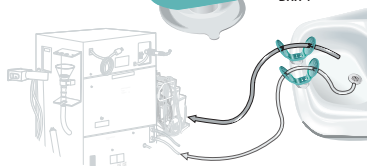

medicalsolutionskc.com 800-326-5275

Bleach Cap

Cap Only
(Bottle not included)



K-FRE-BC
Bleach Cap



medicalsolutionskc.com 800-326-5275

Concentrate Neutralization and Disposal System



Part Number: CND-010



medicalsolutionskc.com
913-438-9700

NEW PRODUCTS

PART NUMBER	PRODUCT DESCRIPTION	PRICE \$
CBM-DR-1	Wand Drying Rack	29.36
SP-VD100	Switch Protector	11.70
DHH-1	Butterfly Hose Holder	12.90
CCS-1	CitruClean Stand	14.95
K-FRE-BC	Bleach Cap-All Plastic	26.60
K-FRE-BOTTLE	500 ml Bottle (cap not included)	14.06
CND-010	Concentrate Neutralization/Disposal System	
M-ETED	End to End Disinfection Cart	1,498.78

End to End Cleaning Device

For Acute
Dialysis Machines

Dialysis Machine
Drain line
connections



Disinfectant
Recirculation
Tank

Wheels on back
for easy relocation

Internal pump

Dialysis machine
feed line connection



MEDICAL SOLUTIONS INTERNATIONAL
5646 MERRIAM DRIVE
MERRIAM, KS 66203
www.medicalsolutionskc.com

800.326.5275
913.438.9700
FAX 913.438.9701

JUG CAPS, TAPS & TEES

Red Jug Cap



M-JC-R
FOR FRESenius
ACIDIFIED CONNECTORS

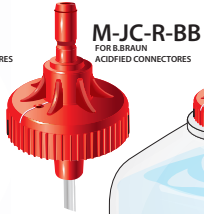

M-JC-R-BB
FOR B.BRAUN
ACIDIFIED CONNECTORS



Blue Jug Cap



M-JC-B
FOR FRESenius
BICARBONATE CONNECTORS

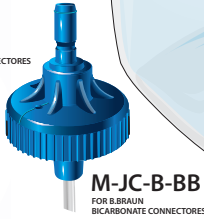

M-JC-B-BB
FOR B.BRAUN
BICARBONATE CONNECTORS

"Clean, Neat, No Mess".



medicalsolutionskc.com 800-326-5275



CAT-3
Citric Acid
Jug Tee

CAT-2
Vinegar
Jug Tee



medicalsolutionskc.com 800-326-5275

Red Jug Tap

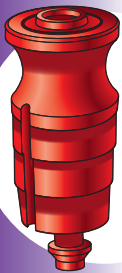

M-JT-R

Blue Jug Tap



M-JT-B



"Clean, Neat, No Mess".

JUG CAP, TAP & TEES

PART NUMBER	PRODUCT DESCRIPTION	PRICE \$
CAT-3	Citric Acid Jug Tee	49.20
CAT-2	Vinegar Jug Tee	49.20
M-JC-R	Red Acid Jug Cap (Fresenius)	24.95
M-JC-B	Blue Bicarb Jug Cap (Fresenius)	24.95
M-JC-R-BB	Red Acid Cap (BBraun)	26.60
M-JC-B-BB	Blue Bicarb Cap (BBraun)	26.60
M-JT-R	Red Acid Jug Tap (Fresenius)	25.50
M-JT-B	Blue Bicarb Jug Tap (Fresenius)	25.50

MEDICAL SOLUTIONS INTERNATIONAL
5646 MERRIAM DRIVE
MERRIAM, KS 66203
www.medicalsolutionskc.com

800.326.5275
913.438.9700
FAX 913.438.9701

MEDICAL SOLUTIONS INTERNATIONAL



ACIDIFIED CONCENTRATE DISTRIBUTION SYSTEM

We use all corrosion resistant materials as well as FDA registered process piping, tanks, controls, etc. The system is designed to transfer acidified concentrate from bulk storage to the patient stations by controlled low pressure pump. The system consists of transfer pumps, valves, fittings, and a complete electronic control. Includes pressurized jug fill.

"It won't let you forget".

Chlorine timer

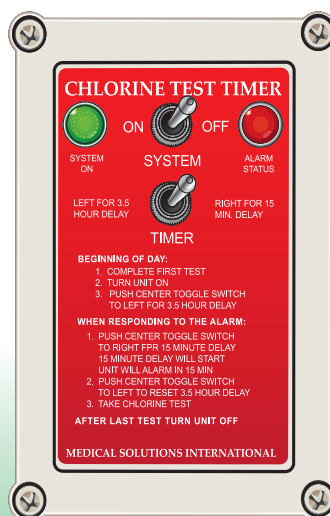

M-CT02

Remote Alarm

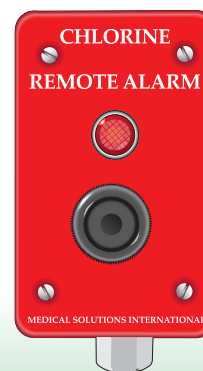

M-RA03



medicalsolutionskc.com 800-326-5275

ACIDIFIED DISTRIBUTION AND CHLORINE TIMER/REMOTE

PART NUMBER	PRODUCT DESCRIPTION	PRICE \$
APDS-CAB3	Acidified Distribution Cabinet	3136.50
M-CT02	Chlorine Timer	795.95
M-RA03	Remote Alarm for Chlorine Timer	129.95

MEDICAL SOLUTIONS INTERNATIONAL
 5646 MERRIAM DRIVE
 MERRIAM, KS 66203
www.medicalsolutionskc.com

800.326.5275
 913.438.9700
 FAX 913.438.9701



MR. ACID

If They Want You To Fill Jugs The Old Way...
JUST SAY NO!



*This Is Just Too Easy!
Automatic Jug Filling!
Clean, Spill Free, Easy*

Shuts Itself Off When Full...

Just place the jug, push the button, walk away... Mr. Acid! Will fill the jug and automatically shut off when full. Mr. Acid! Works on any dialysis machine and works with any acidified concentrate or with bicarb.

Mr. Acid! Is clean, spill free and easy. No more slick dangerous floors. No more spilling and sliding. No more ruined shoes and floors.

This system is made to fit right on the acid drum or can be ordered for carts to fill from bulk storage tanks.

This Patent Applied For

ADU-55



medicalsolutionskc.com 800-326-5275

MR. ACID		
PART NUMBER	PRODUCT DESCRIPTION	PRICE \$
M-ADU-55	Mr. Acid	1565.32
M-A-DW01	Mr. Acid Drum Wand	35.64



MEDICAL SOLUTIONS INTERNATIONAL
5646 MERRIAM DRIVE
MERRIAM, KS 66203
www.medicalsolutionskc.com

800.326.5275
913.438.9700
FAX 913.438.9701

"Don't be caught with out your crank".

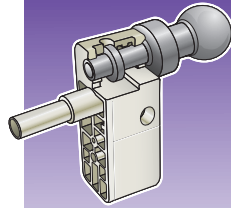

Machine Crank Holder



M-FCH-001

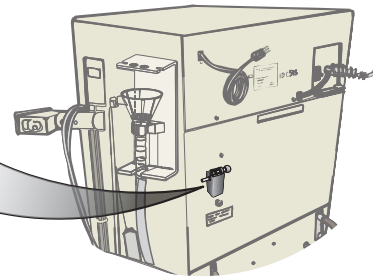
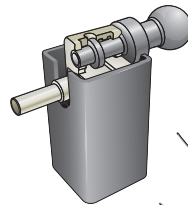

SAMPLE— —CENTER

- EASY
- SIMPLE
- CONVENIENT
- CLEAN

STORE YOUR TESTING EQUIPMENT
CONVENIENTLY AWAY...

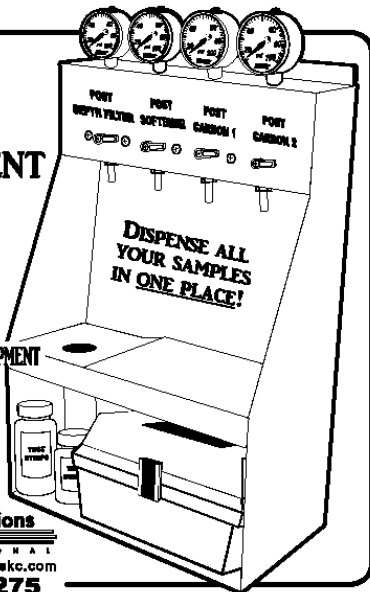

Medical Solutions
INTERNATIONAL
www.medicalsolutionskc.com
800-326-5275



medicalsolutionskc.com 800-326-5275

SAMPLE STATION

PART NUMBER	PRODUCT DESCRIPTION	PRICE \$
M-FCH-001	Machine Crank Holder	11.94
SS-101	Pre-Treatment Sample Station w/out Gauges	636.40
SS-101-PG	Pre-Treatment Sample Station w/ Gauges	985.25

MEDICAL SOLUTIONS INTERNATIONAL
5646 MERRIAM DRIVE
MERRIAM, KS 66203
www.medicalsolutionskc.com

800.326.5275
913.438.9700
FAX 913.438.9701



Z-C30ZX

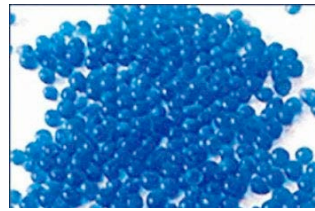

O3-DRF-8



BEFORE AFTER



O3-T

PART NUMBER	PRODUCT DESCRIPTION	PRICE \$
O3-DRF-H1	Ozone Dessicant Filter Housing	39.95
O3-DRF-8	Ozone Air Drying Dessicant Refill	11.91
Z-C-30ZX	Ozone Ambient Air Monitor	695.75
Z-CX01	Exchange Cell for Ozone Unit	269.98
O3-T	Test Strips for Ozone (1 Bottle)	29.95
CV-14000	1/4" Check Valve	24.46

MEDICAL SOLUTIONS INTERNATIONAL
 5646 MERRIAM DRIVE
 MERRIAM, KS 66203
www.medicalsolutionskc.com

800.326.5275
 913.438.9700
 FAX 913.438.9701

WALL TECH DRAIN ISOLATION STATIONS

Drain Isolation Wall Station

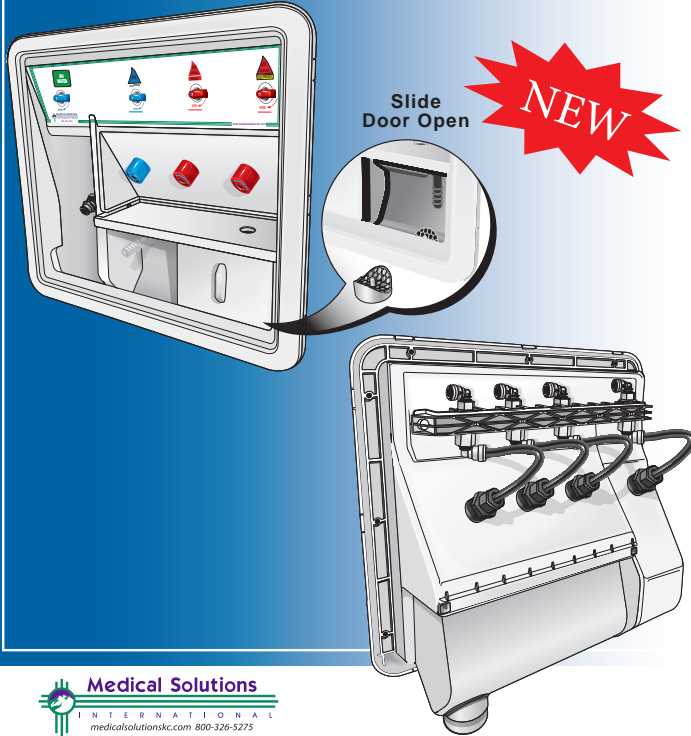

8

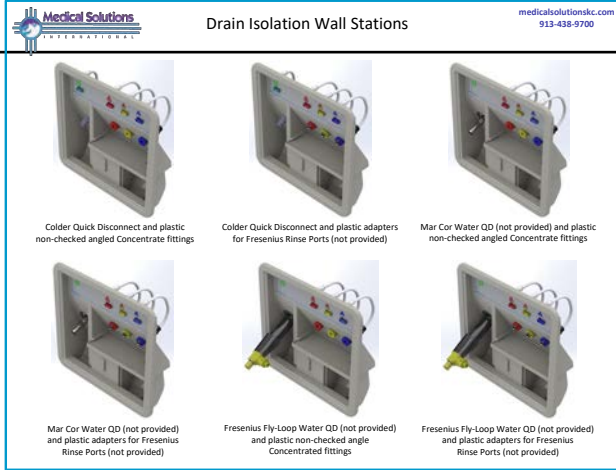

Medical Solutions
INTERNATIONAL
medicalsolutionskc.com 800-326-5275

ADAPTERS

PART NUMBER	PRODUCT DESCRIPTION	PRICE \$
W-FRE-AAP-B	Blue Angled All Plastic Fresenius Checkless Housing and Jam Nut	\$18.76
W-FRE-AAP-O	Orange Angled All Plastic Fresenius Checkless Housing and Jam Nut	\$18.76
W-FRE-AAP-R	Red Angled All Plastic Fresenius Checkless Housing and Jam Nut	\$18.76
W-FRE-AAP-Y	Yellow Angled All Plastic Fresenius Checkless Housing and Jam Nut	\$18.76
W-FRE-ARB-B	Blue Angled All Plastic Fresenius Housing and Jam Nut	\$18.76
W-FRE-ARB-R	Red Angled All Plastic Fresenius Housing and Jam Nut	\$18.76
W-FRE-ARB-Y	Yellow Angled All Plastic Fresenius Housing and Jam Nut	\$18.76

CALL FOR PRICING ON NEW WALLSTATION,
MULTIPLE CONFIGURATIONS TO MEET YOUR NEEDS!

MEDICAL SOLUTIONS INTERNATIONAL
5646 MERRIAM DRIVE
MERRIAM, KS 66203
www.medicationsolutionskc.com

800.326.5275
913.438.9700
FAX 913.438.9701

Medical Solutions International



Wall Station for Dialysis

Our recessed dialysis wall stations include a solutions distribution center and drain. Each is 18" wide by 18" high, and made of high quality molded polystyrene. The durable material can be fitted with a variety of valves, fittings, pressure gauges and quick connects so as to accommodate the installation of compatible dispensing with any dialysis delivery system on the market today. The easily cleaned, chemical resistant wall station also receives the drainage from the dialysis machine. The drip-proof cantilever valve block keeps the unit free of spills and stains. All valving is color coded and signage designated.

- A. P6FC8
- B. ML-T0620666
- C. ML-G0620625
- D. W-M11X4 (4 SLOT MANIFOLD)
- E. W-FRE-850 (RED, BLUE, YELLOW, WHITE)
- F. QD-HFCD24812
- G. QD-HFCD101235GHT
- H. HM001(BLUE, RED, GREEN, ORANGE, YELLOW)
- I. W-CNC-AGD (AIR GAP DRAIN ASSEMBLY)

NOTE:
TYPING (NOT IN DRAW) BLANK FROM
A) TO D), TYPICAL 4 PLACES.

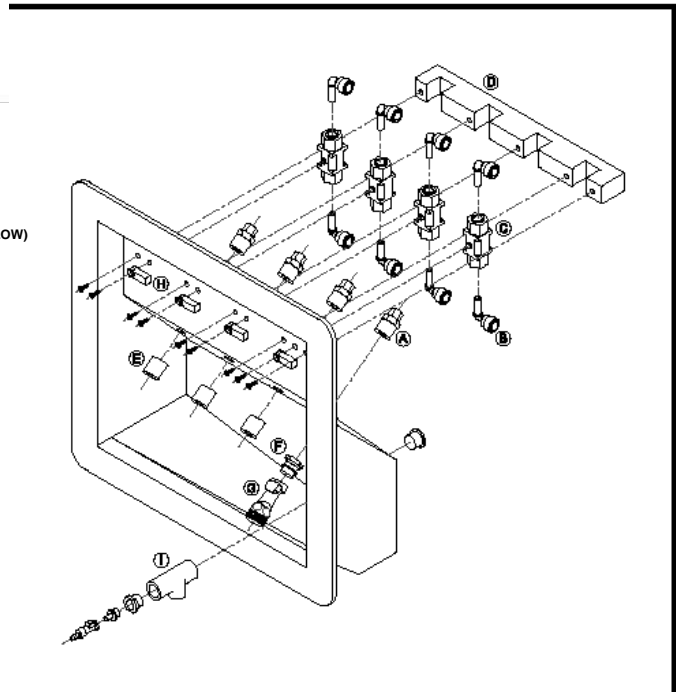

MEDICAL SOLUTIONS INTERNATIONAL
5646 MERRIAM DRIVE
MERRIAM, KS 66203
www.medicalsolutionskc.com

800.326.5275
913.438.9700
FAX 913.438.9701

WALL TECH STATIONS-BEIGE

10

BEIGE WALL STATIONS

PART NUMBER	PRODUCT DESCRIPTION	PRICE \$
W-RPWS-B000	Beige Wallstation Blank	214.65
W-RPWS-B012	Beige Wallstation with 1 Bicarb and 2 Acid Fittings	389.14
W-RPWS-B100	Beige Wallstation with 1 Water Fitting	324.56
W-RPWS-B101	Beige Wallstation with 1 Water and 1 Acid Fitting	336.96
W-RPWS-B102	Beige Wallstation with 1 Water and 2 Acid Fittings	389.14
W-RPWS-B103	Beige Wallstation with 1 Water and 3 Acid Fittings	443.88
W-RPWS-B104	Beige Wallstation with 1 Water and 4 Acid Fittings	497.81
W-RPWS-B111	Beige Wallstation with 1 Water, 1 Bicarb and 1 Acid Fitting	389.95
W-RPWS-B112	Beige Wallstation with 1 Water, 1 Bicarb and 2 Acid Fittings	443.88
W-RPWS-B113	Beige Wallstation with 1 Water, 1 Bicarb and 3 Acid Fittings	497.81
W-RPWS-B114	Beige Wallstation with 1 Water, 1 Bicarb and 4 Acid Fittings	551.75
W-RPWS-B200	Beige Wallstation with 2 Water Fittings	350.86
W-RPWS-B202	Beige Wallstation with 2 Water and 2 Acid Fittings	457.38
W-RPWS-B212	Beige Wallstation with 2 Water, 1 Bicarb and 2 Acid Fittings	478.58
W-RPWS-B222	Beige Wallstation with 2 Water, 2 Bicarb and 2 Acid Fittings	565.25
W-RPWS-B300	Beige Wallstation with 3 Water Fittings	416.95
W-RPWS-B400	Beige Wallstation with 4 Water Fittings	443.88

REFER TO PAGE 9

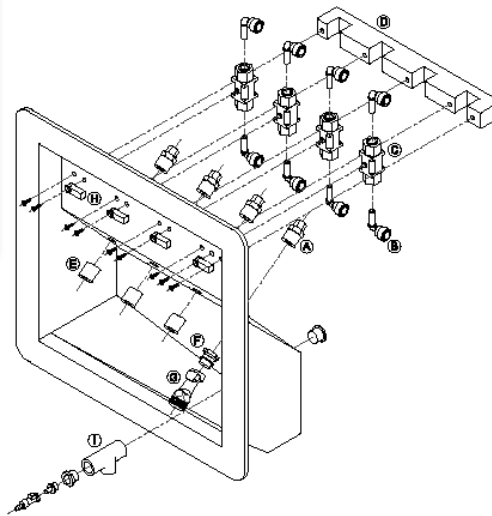

NOTE:
THERM (MAY BE CHNG) BLANK FROM
AS TO OIL TYPICAL 4 PLACES

MEDICAL SOLUTIONS INTERNATIONAL
 5646 MERRIAM DRIVE
 MERRIAM, KS 66203
www.medicalsolutionskc.com

800.326.5275
 913.438.9700
 FAX 913.438.9701

WALL TECH STATIONS-GRAY

11

GRAY WALL STATIONS

PART NUMBER	PRODUCT DESCRIPTION	PRICE \$
W-RPWS-G000	Gray Wallstation Blank	214.65
W-RPWS-G012	Gray Wallstation with 1 Bicarb and 2 Acid Fittings	389.14
W-RPWS-G100	Gray Wallstation with 1 Water Fitting	324.56
W-RPWS-G101	Gray Wallstation with 1 Water and 1 Acid Fitting	336.96
W-RPWS-G102	Gray Wallstation with 1 Water and 2 Acid Fittings	389.95
W-RPWS-G103	Gray Wallstation with 1 Water and 3 Acid Fittings	443.88
W-RPWS-G104	Gray Wallstation with 1 Water and 4 Acid Fittings	497.81
W-RPWS-G111	Gray Wallstation with 1 Water, 1 Bicarb and 1 Acid Fitting	389.95
W-RPWS-G112	Gray Wallstation with 1 Water, 1 Bicarb and 2 Acid Fittings	443.88
W-RPWS-G113	Gray Wallstation with 1 Water, 1 Bicarb and 3 Acid Fittings	497.81
W-RPWS-G114	Gray Wallstation with 1 Water, 1 Bicarb and 4 Acid Fittings	551.75
W-RPWS-G200	Gray Wallstation with 2 Water Fittings	350.86
W-RPWS-G202	Gray Wallstation with 2 Water and 2 Acid Fittings	457.38
W-RPWS-G212	Gray Wallstation with 2 Water, 1 Bicarb and 2 Acid Fittings	478.58
W-RPWS-G222	Gray Wallstation with 2 Water, 2 Bicarb and 2 Acid Fittings	565.24
W-RPWS-G300	Gray Wallstation with 3 Water Fittings	416.95
W-RPWS-G400	Gray Wallstation with 4 Water Fittings	443.88

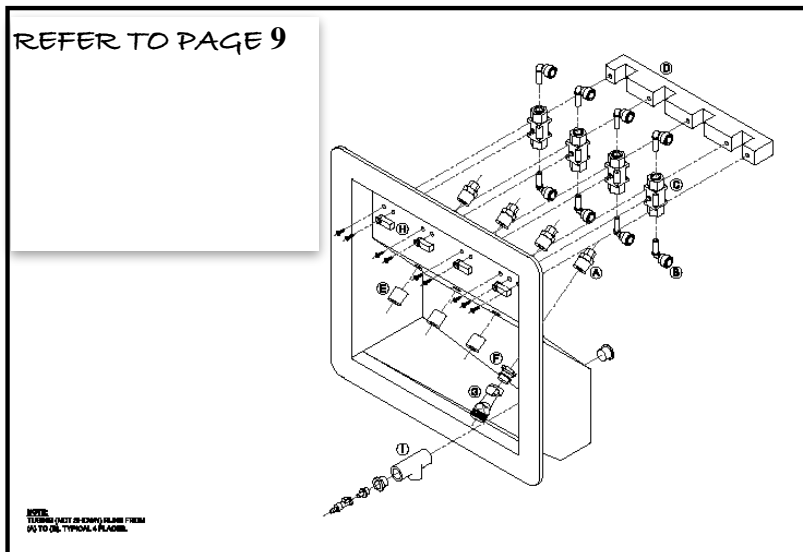

MEDICAL SOLUTIONS INTERNATIONAL
 5646 MERRIAM DRIVE
 MERRIAM, KS 66203
www.medicalsolutionskc.com

800.326.5275
 913.438.9700
 FAX 913.438.9701

WHITE WALL STATIONS		
PART NUMBER	PRODUCT DESCRIPTION	PRICE \$
W-RPWS-W000	White Wallstation Blank	214.65
W-RPWS-W100	White Wallstation with 1 Water Fitting	324.56
W-RPWS-W101	White Wallstation with 1 Water and 1 Acid Fitting	336.96
W-RPWS-W102	White Wallstation with 1 Water and 2 Acid Fittings	389.95
W-RPWS-W103	White Wallstation with 1 Water and 3 Acid Fittings	443.88
W-RPWS-W111	White Wallstation with 1 Water, 1 Bicarb and 1 Acid Fitting	389.95
W-RPWS-W112	White Wallstation with 1 Water, 1 Bicarb and 2 Acid Fittings	443.88
W-RPWS-W113	White Wallstation with 1 Water, 1 Bicarb and 3 Acid Fittings	497.81
W-RPWS-W114	White Wallstation with 1 Water, 1 Bicarb and 4 Acid Fittings	551.75
W-RPWS-W200	White Wallstation with 2 Water Fittings	349.52
W-RPWS-W202	White Wallstation with 2 Water and 2 Acid Fittings	457.38
W-RPWS-W212	White Wallstation with 2 Water, 1 Bicarb and 2 Acid Fittings	478.58
W-RPWS-W222	White Wallstation with 2 Water, 2 Bicarb and 2 Acid Fittings	565.24
W-RPWS-W300	Gray Wallstation with 3 Water Fittings	416.95
W-RPWS-W400	Gray Wallstation with 4 Water Fittings	443.88

SMALL WHITE WALL STATIONS		
PART NUMBER	PRODUCT DESCRIPTION	PRICE \$
W-RPWS-SW000	Small White Wallstation Blank	214.65
W-RPWS-SW00AG	Small White Wallstation with Air Gap Drain Assembly	244.60
W-RPWS-SW100	Small White Wallstation with 1 Water Fitting	324.56
W-RPWS-SW102	Small White Wallstation with 1 Water and 2 Acid Fittings	389.95
W-RPWS-SW110	Small White Wallstation with 1 Water and 1 Bicarb Fitting	336.96
W-RPWS-SW111	Small White Wallstation with 1 Water, 1 Bicarb and 1 Acid Fitting	389.95
W-RPWS-SW112	Small White Wallstation with 1 Water, 1 Bicarb and 2 Acid Fittings	443.88
W-RPWS-SW200	Small White Wallstation with 2 Water Fittings	348.97

MEDICAL SOLUTIONS INTERNATIONAL
5646 MERRIAM DRIVE
MERRIAM, KS 66203
www.medicalsolutionskc.com

800.326.5275
913.438.9700
FAX 913.438.9701

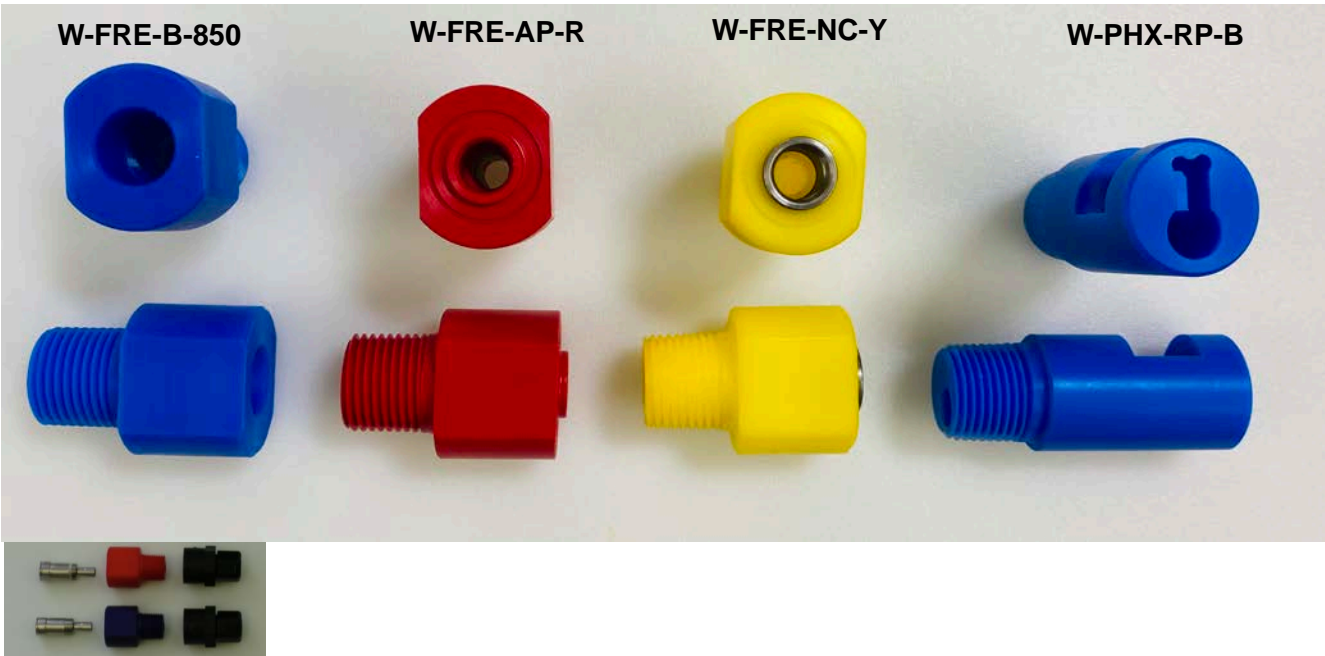

ADAPTERS		
PART NUMBER	PRODUCT DESCRIPTION	PRICE \$
W-FRE-R-850	Red 1/2" Male NPT X Fresenius Reducer Bushing	16.50
W-FRE-B-850	Blue 1/2" Male NPT X Fresenius Reducer Bushing	16.50
W-FRE-W-850	White 1/2" Male NPT X Fresenius Reducer Bushing	16.50
W-FRE-AP-R	Red All Plastic Checkless Fresenius Reducer Bushing	22.46
W-FRE-AP-B	Blue All Plastic Checkless Fresenius Reducer Bushing	22.46
W-FRE-NC-R	Red Checkless Male NPT X Fresenius Reducer Bushing w/SS Ring	33.95
W-FRE-NC-B	Blue Checkless Male NPT X Fresenius Reducer Bushing w/SS Ring	33.95
W-PHX-RP-R	Red Phoenix Rinse Port	29.95
W-PHX-RP-B	Blue Phoenix Rinse Port	29.95
W-PHX-RP-W	White Phoenix Rinse Port	29.95
W-FRE-RS	Rubber Seal for Fresenius Rinse Port for W-FRE-850's	1.10

MEDICAL SOLUTIONS INTERNATIONAL
 5646 MERRIAM DRIVE
 MERRIAM, KS 66203
www.medicalsolutionskc.com

800.326.5275
 913.438.9700
 FAX 913.438.9701

WALL TECH STATION ADAPTERS

14

ITEMS FOR ADAPTING FRESENIUS FITTINGS

PART NUMBER	PRODUCT DESCRIPTION	PRICE \$
W-FRE-W5-B	Fresenius Assembly Washer Blue	0.78
W-FRE-W5-R	Fresenius Assembly Washer Red	0.78
W-FRE-W5-W	Fresenius Assembly Washer White	0.78
W-FRE-W5-Y	Fresenius Assembly Washer Yellow	0.78
W-FRE-W.50	Fresenius Bushing Spacer White	0.38



WALL STATION VALVE HANDLES

PART NUMBER	PRODUCT DESCRIPTION	PRICE \$
HB001	Blue Handle SMC	1.69
HR001	Red Handle SMC	1.69
HC001	Clear Handle SMC	1.69
HG001	Gray Handle SMC	1.69
HGR001	Green Handle SMC	1.69
HBL001	Black Handle SMC	1.69
HMB001	Blue Handle Murlock	1.69
HMBL001	Black Handle Murlock	1.69
HMR001	Red Handle Murlock	1.69
HMO001	Orange Handle Murlock	1.69
HMY001	Yellow Handle Murlock	1.69
HMGR001	Green Handle Murlock	1.69
HPY001	Yellow Parker Ballvalve Handle	3.94



HANDLES IN SMC



HANDLES IN MURDOCK



WALL STATION NYLON DRAIN BARBS

PART NUMBER	PRODUCT DESCRIPTION	PRICE \$
W-ATE2	Wallstation Drain 1" MNPT X 3/4" Barb Elbow	3.90
W-ATA1	Wallstation Drain 1" MNPT X 3/4" Barb Straight	3.22
436-133	Wallstation Drain 1" MNPT X 1-1/2" Socket Schedule 40	8.18

MEDICAL SOLUTIONS INTERNATIONAL
 5646 MERRIAM DRIVE
 MERRIAM, KS 66203
www.medicalsolutionskc.com

800.326.5275
 913.438.9700
 FAX 913.438.9701

WALL TECH STATION ITEMS

15



MEDICAL SOLUTIONS INTERNATIONAL 800-326-5275

35X BICARB	H2O WATER	35X ACIDIFIED	35X ACIDIFIED	35X ACIDIFIED	DRAIN	0 K 1 K 2 K 3 K 4 K 0 K 1 K 2 K 3 K 4 K 0 K 1 K 2 K 3 K 4 K
36.83X BICARB	H2O WATER	36.83X ACIDIFIED	36.83X ACIDIFIED	36.83X ACIDIFIED	DRAIN	2.0 Ca 2.25 Ca 2.5 Ca 2.75 Ca 2.0 Ca 2.25 Ca 2.5 Ca 2.75 Ca 2.0 Ca 2.25 Ca 2.5 Ca 2.75 Ca
45X BICARB	H2O WATER	45X ACIDIFIED	45X ACIDIFIED	45X ACIDIFIED	DRAIN	
36.1X BICARB	H2O WATER	36.1X ACIDIFIED	36.1X ACIDIFIED	36.1X ACIDIFIED	DRAIN	

FORM# RPWS-L1

WALL STATION ITEMS

PART NUMBER	PRODUCT DESCRIPTION	PRICE \$
W-RPWS-L1	Labels for Recessed Patient Wallstation	1.65
P6FC8	3/8" Tube Compression X 1/2" Male NPT	7.50
P-OR.6	"O"RING for P6FC8 3/8" Tube Compression	0.43
QD-HFCD101235GHT	3/4" MGHT PSF Inline coupling insert w/Shut-off	38.90
QD-HFCD24812	1/2" MNPT PP Inline coupling insert w/Shut-off	25.42
O-RING-WTR	"O" RING for Water Male QD-HFCD24812	0.34
W-ATE2	Wallstation Drain 1" MNPT X 3/4" Barb Elbow	3.90
W-ATA1	Wallstation Drain 1" MNPT X 3/4" Barb Straight	3.22
436-133	Wallstation Drain 1" MNPT x 1 1/2" Socket Schedule 40	8.18
W-M11X1	1 Slot Manifold for Wallstation	10.98
W-M11X2	2 Slot Manifold for Wallstation	12.96
W-M11X3	3 Slot Manifold for Wallstation	15.76
W-M11X4	4 Slot Manifold for Wallstation	26.81
W-M11X6	6 Slot Manifold for Wallstation	28.79

MEDICAL SOLUTIONS INTERNATIONAL
 5646 MERRIAM DRIVE
 MERRIAM, KS 66203
www.medicalsolutionskc.com

800.326.5275
 913.438.9700
 FAX 913.438.9701

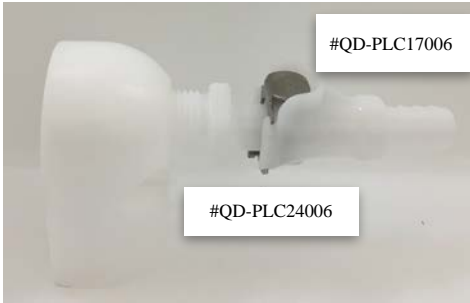

W-CNC-AGD- AIR GAP DRAIN ASSEMBLY



W-CNC-CAS

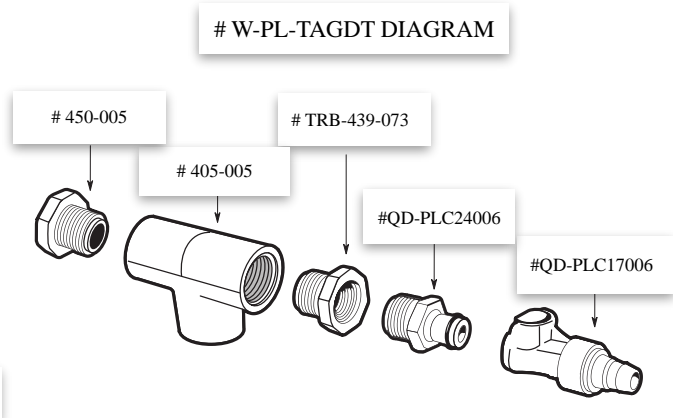

AIR GAP DRAIN ASSEMBLY

PART NUMBER	PRODUCT DESCRIPTION	PRICE \$
W-CNC-AGD	Air Gap Drain Assembly	32.70
W-CNC-CAS	Air Gap Body	19.98
W-PL-TAGD	Tee Style Sch 40 Air Gap Drain Assembly	53.30
W-PL-TAGDT	Threaded Tee Style Sch 40 Air Gap Drain Assembly	29.95

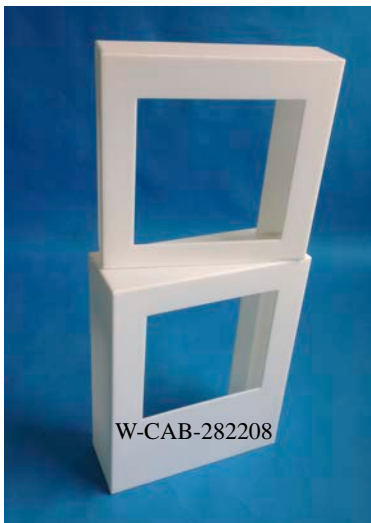

W-CAB-282208



WALL STATION CABINET

PART NUMBER	PRODUCT DESCRIPTION	PRICE \$
W-CAB-282208	Custom Wall Mounting Chase for RPWS (White)	495.25

MEDICAL SOLUTIONS INTERNATIONAL
 5646 MERRIAM DRIVE
 MERRIAM, KS 66203
www.medicalsolutionskc.com

800.326.5275
 913.438.9700
 FAX 913.438.9701

CLEAR SCREEN Protection

Protect your new monitor.... Refurbish your old....

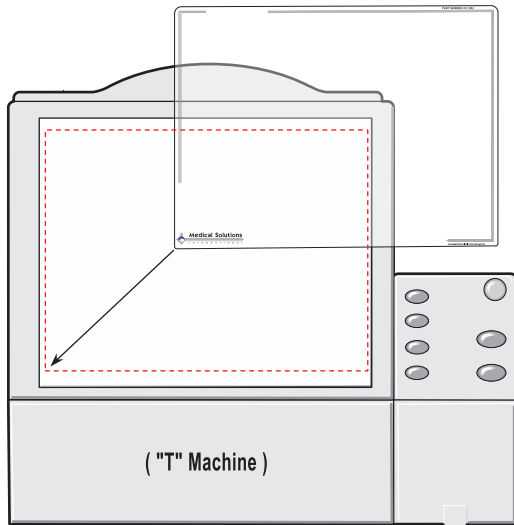

Clear Screen for T Machine

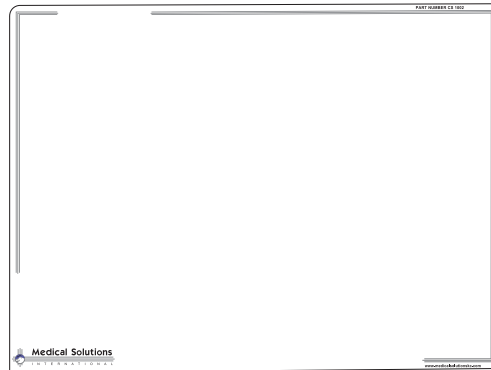

CS1002

\$19.95

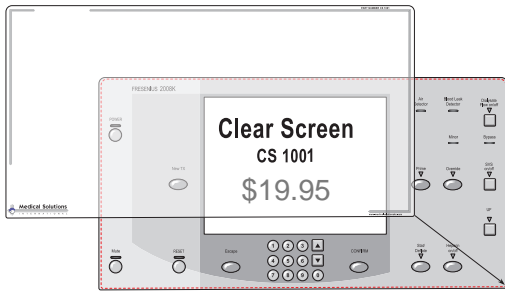

Fresenius 2008K

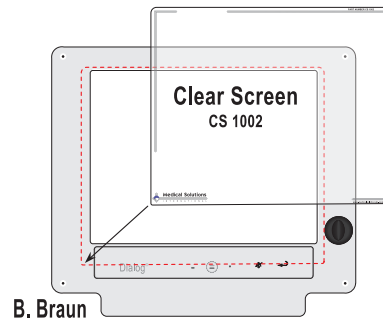

B. Braun

"Save your "T" screen". "Stops cloudy screens".



medicalsolutionskc.com 800-326-5275

MEDICAL SOLUTIONS INTERNATIONAL
5646 MERRIAM DRIVE
MERRIAM, KS 66203
www.medicalsolutionskc.com

800.326.5275
913.438.9700
FAX 913.438.9701

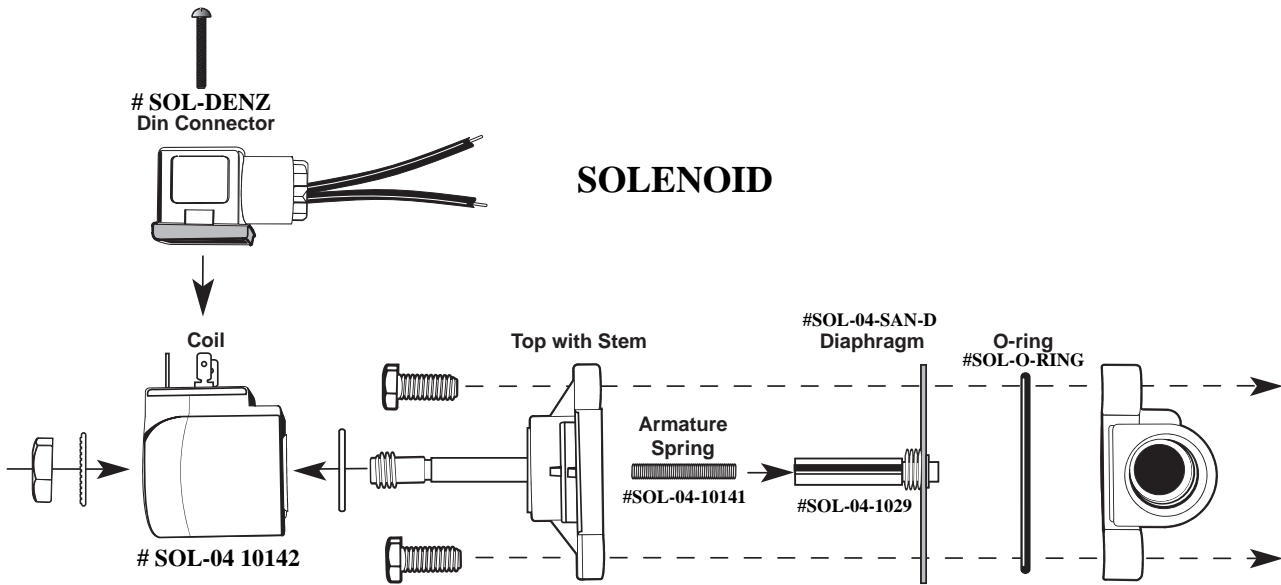

NOTE COLLAR

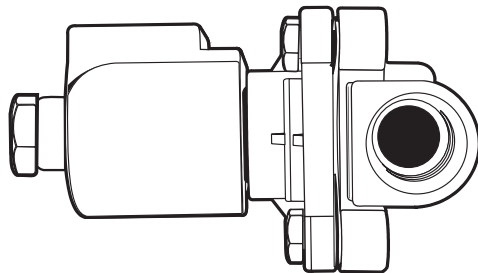

SOLENOID
Normally Open

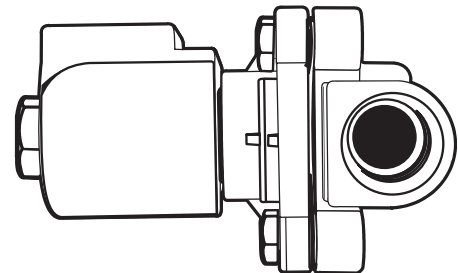

SOLENOID
Normally Closed

SOLENOIDS		
PART NUMBER	PRODUCT DESCRIPTION	PRICE \$
SOL-7524VNC	Solenoid 3/4" 24 VT Normally Closed AC	159.62
SOL-7524VNO	Solenoid 3/4" 24 VT Normally Open AC	265.62
SOL-S201Z1003NC	Stainless Steel 3/4" Normally Closed AC	408.70
SOL-75DC-VNC	Solenoid 3/4" 24 VT Normally Closed DC	165.30
SOL-75DC-VNO	Solenoid 3/4" 24 VT Normally Open DC	307.72
SOL-04-SAN-D	Santilite Diaphragm	32.65
SOL-DENZ	Solenoid Den Connector	22.52
SOL-KIT	Solenoid Santoprene Kit	46.50
SOL-O-RING	"O"RINGS for all Solenoids	5.83

NOTE COLLAR FOR NORMALLY OPEN



*SDS-CB200 2020 or after have DC solenoids

INJECTORS		
PART NUMBER	PRODUCT DESCRIPTION	PRICE \$
INJ-484	1/2" Injector Venturi-Kynar	121.43



EDUCTORS		
PART NUMBER	PRODUCT DESCRIPTION	PRICE \$
ED-4927OPP	Eductor	64.49



SPRAY NOZZLES		
PART NUMBER	PRODUCT DESCRIPTION	PRICE \$
SN-17020	1/4" Spiral Jet Spray Nozzle	31.36
SN-4814T84	1/4" Blue Spray Nozzle 120 degree	27.90



MEDICAL SOLUTIONS INTERNATIONAL
 5646 MERRIAM DRIVE
 MERRIAM, KS 66203
www.medicalsolutionskc.com

800.326.5275
 913.438.9700
 FAX 913.438.9701

BICARB SYSTEM ACCESSORIES

20

HATCH COVER

PART NUMBER	PRODUCT DESCRIPTION	PRICE \$
HHC-711	Hinged Hatch Cover-Cam Latch	105.64
HHC-25	Hinged Gasket Cord Kit	13.33
HHC-RETRO KIT	Kit Switching from HHC-912 to HHC-711	46.95



TANK LABELS

PART NUMBER	PRODUCT DESCRIPTION	PRICE \$
LDT-100	Day Tank Label	11.81
LMT-100	Mix Tank Label	11.81
LDT-50	Day Tank Label	11.81
LMT-50	Mix Tank Label	11.81



KENT METERS

PART NUMBER	PRODUCT DESCRIPTION	PRICE \$
KM-CA-CONV-KIT	Kent Meter to Carlon Meter	779.90
KM-CA-50	Carlon 1/2" Water Meter	382.00
KM-CA-75	Carlon 3/4" Water Meter	382.00
KM-CA-WL	Wire Lead for Meter	128.40



WAND

PART NUMBER	PRODUCT DESCRIPTION	PRICE \$
M-MXR-WD	Wand Assembly for 100 Gallon Tank	259.00
M-MXR-WB	Bicarb Wand Block/Knob for 100 Gallon Tank	35.00



HYDROMETERS

PART NUMBER	PRODUCT DESCRIPTION	PRICE \$
HYDRO-C-08265	Plastic Specific Gravity Hydrometer	221.00
HYDRO-E-6135-6	Hydrometer Jar 500 ml	104.00



MEDICAL SOLUTIONS INTERNATIONAL
5646 MERRIAM DRIVE
MERRIAM, KS 66203
www.medicalsolutionskc.com

800.326.5275
913.438.9700
FAX 913.438.9701

FUSES

PART NUMBER	PRODUCT DESCRIPTION	PRICE \$
FU-MXR-20	20 AMP Fuse (120 vt. sys)	39.98
FU-MXR-6.25	6.25 AMP Fuse (24 vt. sys)	39.98
FU-BU-FRN-R-2	Bullet Fuse 20 AMP	32.00
FU-BU-ECNR6.25	Bullet Fuse 6.25 AMP	28.95



SWITCHES

PART NUMBER	PRODUCT DESCRIPTION	PRICE \$
SWT-24RS	24 Volt Rocker Switch (#1,2,3,4,5)	13.43
SWT-24RS/BR	SMALL 24v Rocker Switch (2020+)	17.24
SWT-120RS	120 Volt Rocker Switch (#6, #7 Switches)	13.43
SWT-120TGL	120 Volt Toggle Switch (not for CB200)	18.00
SWT-1092D5	Green Indicator Light (Chlorine Timer)	13.43
SWT-53413-5	Green Indicator Light (MM1PD Fill Mix)	13.43
SWT-53413-6	Green Indicator Light (MM1PD Recirc, ACID)	13.43
SWT-53415-5	Red Indicator Light (MM1PD Recirc)	13.43
SWT-1092D1	Red Indicator Light (Chlorine Timer)	13.43
SWT-SAFETY	Safety Switch	128.26



SENSORS

PART NUMBER	PRODUCT DESCRIPTION	PRICE \$
FS-50195k94	Vertical Mount Level Switch	57.70
FS-46515k41	Horizontal Float Switch Side Mount	49.95
FS-135815	Flow Sensor 1"	245.00

PROXIMITY SWITCH

PART NUMBER	PRODUCT DESCRIPTION	PRICE \$
SWT-PROX	Proximity Switch-Hartfiel	299.36



CIRCUIT BREAKER

PART NUMBER	PRODUCT DESCRIPTION	PRICE \$
CB-L881C	Circuit Breaker	38.95



TRANSFORMER

PART NUMBER	PRODUCT DESCRIPTION	PRICE \$
TR-50	Transformer 120 VT- 24 AC	65.95
TRC-C-120V	Transformer LVS-150	90.00
SOLA-12549334	SOLA Transformer	195.85



STATIC INLINE MIXER

PART NUMBER	PRODUCT DESCRIPTION	PRICE \$
STATIC MIXER	Static Inline Mixer	384.74



ELECTRICAL CONTROL BOXES

PART NUMBER	PRODUCT DESCRIPTION	PRICE \$
M-RA02	Bicarb Remote Alarm with Reset Mute	641.25
M-MXR-BICFM	Dual Pump Control Box on Single 100 gallon mixers	943.00
M-MXR-RPC	Recirculation Pump Control on Single 100 gallon	499.98
PP-24VT	Piezo Buzzer	17.48
M-CT02	Time Delay Chlorine Test Timer	795.96
M-RA03	Remote Alarm for Chlorine Test Timer	129.95
M-RA-W	18 Gauge 2 Conductor Sheathed Wire	1.58 ft



medicalsolutionskc.com 800-326-5275

MEDICAL SOLUTIONS INTERNATIONAL
 5646 MERRIAM DRIVE
 MERRIAM, KS 66203
www.medicalsolutionskc.com

800.326.5275
913.438.9700
FAX 913.438.9701

PRESSURE GAUGE

PART NUMBER	PRODUCT DESCRIPTION	PRICE \$
PG-B254	Pressure Gauge Brass 0-100 Lower Mount	80.66
PG-AP-0-30	Plastic Pressure Gauge with Subber for APDS-CAB3	270.00
PG-S-5335CBM-100	Pressure Gauge Stainless Steel 0-100 Back Mount	117.49
PG-S-5335CLM-100	Pressure Gauge Stainless Steel 0-100 Lower Mount	117.49
PG-S-254CBM-30	Pressure Gauge Stainless Steel 0-30 Back Mount	117.49
PG-S-254CLM-30	Pressure Gauge Stainless Steel 0-30 Lower Mount	117.49



PRESSURE REGULATOR

PART NUMBER	PRODUCT DESCRIPTION	PRICE \$
PR-BHR	Pressure Regulator Bulkhead Nut	9.50
PR-R91S200AA	Pressure Regulator Norgren w/ 1/4" FNPT	144.22
PR-AAP044506	Pressure Regulator Watts w/ 1/4" FNPT	54.06
PR-R362IUY1-S1	Pressure Regulator AOP w/ 1/4" FNPT	71.40



PR-R91S200AA



PR-AAP044506



PR-R362IUY1-S1

MEDICAL SOLUTIONS INTERNATIONAL
 5646 MERRIAM DRIVE
 MERRIAM, KS 66203
www.medicalsolutionskc.com

800.326.5275
 913.438.9700
 FAX 913.438.9701

CAMLOCKS		
PART NUMBER	PRODUCT DESCRIPTION	PRICE \$
CL-B075	Camlock Female Coupler x 3/4" Male NPT	22.94
CL-B100	Camlock Female Coupler x 1" Male NPT	26.44
CL-C075	Camlock Female Coupler x 3/4" Barb	24.94
CL-C100	Camlock Female Coupler x 1" Barb	26.22
CL-E075	Camlock Male Adapter x 3/4" Barb	13.48
CL-E100	Camlock Male Adapter x 1" Barb	12.80
CL-F075	Camlock Male Adapter x 3/4" Male NPT	13.48
CL-F100	Camlock Male Adapter x 1" Male NPT	12.70
CL-DC075	Camlock Dust Cap 3/4"	26.44
CL-DC100	Camlock Dust Cap 1"	27.10
CL-DP075	Camlock Dust Plug 3/4"	22.62
CL-DP100	Camlock Dust Plug 1"	26.28



Series B



Series C



Series E



Series F



Series DC



Series DP



BULKHEAD FITTINGS		
PART NUMBER	PRODUCT DESCRIPTION	PRICE \$
BH-50	1/2" TXT Banjo Bulkhead Fitting	27.84
BH-75	3/4" TXT Banjo Bulkhead Fitting	29.62
BH-16439	1/2" White Bulkhead Fitting	62.72



FILTERS		
PART NUMBER	PRODUCT DESCRIPTION	PRICE \$
FIL-CAP 2	.2 Micron Air Filter	116.65
FIL-CAP2/GAC	.2 Micron Air Filter w/Granulated Activated Carbon	127.65
FIL-DCP02000	.2 Micron Air Filter for Bicarb System	149.99
FIL-5-GAC-H	Blue 1/2" Housing for 5" Carbon Filter	30.68
FIL-5-GAC	Granulated Activated Carbon Filter	18.60
FIL-50H-SS	1/2" Clear Bulb, Filter Housing and Filter Screen	38.48
FIL-50-BH	1/2" Clear Bulb	28.50
FIL-50X100	Filter for 1/2" Housing	13.43
FIL-75H-SS	3/4" Clear Bulb, Filter Housing and Filter Screen	65.48
FIL-75-BH	3/4" Clear Bulb	38.50
FIL-75X100	Filter for 3/4" Housing	21.00
FIL-PO.2-10E	.2 Micron 10" RO Storage Tank Air Filter	162.00
FIL-10-H	Housing for 10" 5 micron Air Filters	63.36
FIL-AP-5-10	10" 5 Micron Air Filter	12.24
FIL-AP-5-10/24	10" 5 Micron Air Filter (24 Per Case)	293.76
FIL-AP-5-20	20" 5 Micron Fines Filter (RO Feed)	9.35
FIL-AP-5-20/20	20" 5 Micron Case (20 Per case)	200.00
FIL-PCP-10BB	10" Pentekchlor 20 BB Carbon Block	125.92
FIL-PCP-20BB	20" Pentekchlor 20 BB Carbon Block	280.50
FIL-GAC20-BB	10" Carbon Block Filter	120.25
TW30-4040	Membranes	495.00



FIL-DCP02000



FIL-5-GAC-H



FIL-5-GAC



FIL-50H-SS



FIL-75H-SS

MEDICAL SOLUTIONS INTERNATIONAL
 5646 MERRIAM DRIVE
 MERRIAM, KS 66203
www.medicalsolutionskc.com

800.326.5275
 913.438.9700
 FAX 913.438.9701

IWAKI PUMP

PART NUMBER	PRODUCT DESCRIPTION	PRICE \$
PMP-IW-55RLT	Iwaki Pump 55 RLT (complete motor and wet end kit)	855.60
PMP-IW-55RLT-WEK	Iwaki Pump Wet End Kit 55 RLT	517.20
PMP-IW-70RLZT	Iwaki Pump 70 RLZT	1247.40
PMP-IW-70RLZT-WEK	Iwaki Pump Wet End Kit-70 RLZT	586.58
PMP-IW-70RLT	Iwaki Pump 70 RLT	1112.40
PMP-IW-70RLT-WEK	Iwaki Pump Wet End Kit 70 RLT	586.58
PMP-IW-30RLT	Iwaki Pump 30 RLT **special order	778.00
PMP-IW-100RLT	Iwaki Pump 100 RLT **special order	1346.40

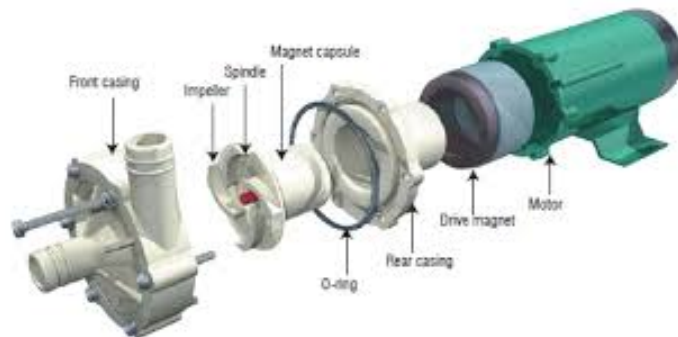

MEDICAL SOLUTIONS INTERNATIONAL
 5646 MERRIAM DRIVE
 MERRIAM, KS 66203
www.medicalsolutionskc.com

800.326.5275
 913.438.9700
 FAX 913.438.9701

MARCH PUMP TE-7R			
PART NUMBER	DIAGRAM #	PRODUCT DESCRIPTION	PRICE \$
PMP-M-TE7R		TE7R Large March Pump (Motor and Wet End Kit)	1460.34
PMP-M-TE7R-WEK	#1- #8	TE7R Wet End Kit	688.43
PMP-M-0124-01	ALT #8	Rear Magnet Housing Kynar	249.60

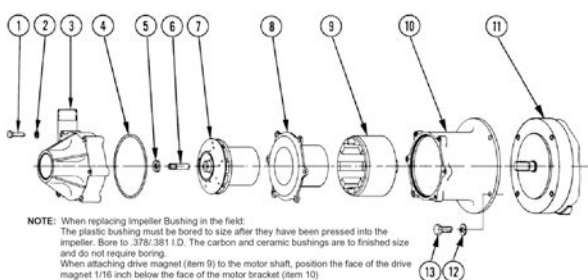

PUMPS		
PART NUMBER	PRODUCT DESCRIPTION	PRICE \$
PMP-M-AC5C	March Pump AC5C-MD	975.42
PMP-SF-2088	Shur Flo Pump 3.3 GPM 115VT	275.12
PMP-SF-2088-PA	Shur Flo Pump including purge assembly	650.36



MEDICAL SOLUTIONS INTERNATIONAL
 5646 MERRIAM DRIVE
 MERRIAM, KS 66203
www.medicalsolutionskc.com

800.326.5275
 913.438.9700
 FAX 913.438.9701

HOSE AND HOSE CLAMPS

PART NUMBER	PRODUCT DESCRIPTION	PRICE \$
HC-100	Hose Clamp for 1" Hose OD	4.40
HC-3/4	Hose Clamp for 3/4" Hose OD	4.24
HC-1/2	Hose Clamp for 1/2" Hose OD	4.14
HC-3/8	Hose Clamp for 3/8" Hose OD	4.04
HC-BLACK	Black Hose Clamp for 3/8" OD	2.38
HC-BLUE	Blue Hose Clamp for 3/8" OD	2.38
H-PB-1-G	1" ID Poly Braided Hose Gray	4.60
H-PB-3/4-G	3/4" ID Poly Braided Hose Gray	4.34
H-PB-1/2-G	1/2" ID Poly Braided Hose Gray	3.50
H-PB-1/2-CL	1/2" ID Poly Braided Hose Clear	2.98
H-PB-3/8-G	3/8" ID Poly Braided Hose Gray	2.74
H-PB-3/8-CL	3/8" ID Poly Braided Hose Clear	2.98
H-PV-3/4-CL	3/4" ID Clear Poly Vinyl Hose	4.74
H-PV-3/8	3/8" ID Clear Poly Vinyl Hose	2.74
H-PV-1/4	1/4" ID Clear Poly Vinyl Hose	2.74



CLICKS

PART NUMBER	PRODUCT DESCRIPTION	PRICE \$
CLIC-12	#12 Click for Drain Hose	3.48
CLIC-15	#15 Click for Drain Hose	3.70
CLIC-17	#17 Click for 3/8" PVC	3.48
CLIC-20	#20 Click for 1/2" PVC	3.70
CLIC-25	#25 Click for 3/4" PVC	5.32
CLIC-32	#32 Click for 1" PVC	7.12
CLIC-47	#47 Click for 1-1/2" PVC	12.98



MEDICAL SOLUTIONS INTERNATIONAL
 5646 MERRIAM DRIVE
 MERRIAM, KS 66203
www.medicalsolutionskc.com

800.326.5275
 913.438.9700
 FAX 913.438.9701

TUBING		
PART NUMBER	PRODUCT DESCRIPTION	PRICE \$
1/2" BLUE	1/2" Poly Tubing Blue	0.66
1/2" ORANGE	1/2" Poly Tubing Orange (not stock)	0.80
1/2" RED	1/2" Poly Tubing Red	0.66
1/2" YELLOW	1/2" Poly Tubing Yellow	0.66
1/4" BLACK	1/4" Poly Tubing Black	0.66
1/4" BLUE	1/4" Poly Tubing Blue	0.66
1/4" RED	1/4" Poly Tubing Red	0.66
1/4" YELLOW	1/4" Poly Tubing Yellow	0.66
1/4" ORANGE	1/4" Poly Tubing Orange	0.66
1/4" WHITE	1/4" Poly Tubing White	0.66
3/8" BLUE	3/8" Poly Tubing Blue	0.65
3/8" GREEN	3/8" Poly Tubing Green	0.65
3/8" ORANGE	3/8" Poly Tubing Orange	0.65
3/8" RED	3/8" Poly Tubing Red	0.65
3/8" WHITE	3/8" Poly Tubing White	0.65
3/8" YELLOW	3/8" Poly Tubing Yellow	0.65
5/8" YELLOW	5/8" Poly Tubing Yellow	0.94
5/8" BLUE	5/8" Poly Tubing Blue	0.94
5/8" RED	5/8" Poly Tubing Red	0.94



COILED CONCENTRATED TUBING		
PART NUMBER	PRODUCT DESCRIPTION	PRICE \$
C80550	Red Coiled Concentrated Tubing	23.91
C80553	Blue Coiled Concentrated Tubing	23.91
C80558	Clear Coiled Concentrated Tubing	23.91



MEDICAL SOLUTIONS INTERNATIONAL
 5646 MERRIAM DRIVE
 MERRIAM, KS 66203
www.medicalsolutionskc.com

800.326.5275
 913.438.9700
 FAX 913.438.9701

COUPLING SOC

PART NUMBER	PRODUCT DESCRIPTION	PRICE \$
829-002	1/4" SXS Coupling	9.42
829-003	3/8" SXS Coupling	9.42
829-005	1/2" SXS Coupling	5.88
829-007	3/4" SXS Coupling	7.96
829-010	1" SXS Coupling	8.20
829-012	1-1/4" SXS Coupling	12.48
829-015	1-1/2" SXS Coupling	13.92
829-020	2" SXS Coupling	14.73



FEMALE ADAPTER SOC X FIPT

PART NUMBER	PRODUCT DESCRIPTION	PRICE \$
835-002	1/4" SXT Female Adapter	9.95
835-003	3/8" SXT Female Adapter	10.26
835-005	1/2" SXT Female Adapter	6.45
835-007	3/4" SXT Female Adapter	9.98
835-010	1" SXT Female Adapter	14.26
835-012	1-1/4" SXT Female Adapter	19.54
835-015	1-1/2" SXT Female Adapter	23.96
835-020	2" SXT Female Adapter	45.26



MALE ADAPTER MIPT X SOC

PART NUMBER	PRODUCT DESCRIPTION	PRICE \$
836-005	1/2" SXT Male Adapter	7.96
836-007	3/4" SXT Male Adapter	7.57
836-010	1" SXT Male Adapter	13.98
836-012	1-1/4" SXT Male Adapter	17.74
836-015	1-1/2" SXT Male Adapter	19.96
836-020	2" SXT Male Adapter	28.94



MEDICAL SOLUTIONS INTERNATIONAL
5646 MERRIAM DRIVE
MERRIAM, KS 66203
www.medicalsolutionskc.com

800.326.5275
913.438.9700
FAX 913.438.9701

COUPLING FIPT

PART NUMBER	PRODUCT DESCRIPTION	PRICE \$
830-002	1/4" TXT Coupling	7.06
830-003	3/8" TXT Coupling	7.06
830-005	1/2" TXT Coupling	9.40
830-007	3/4" TXT Coupling	11.13
830-010	1" TXT Coupling	12.24
830-012	1-1/4" TXT Coupling	14.96
830-015	1-1/2" TXT Coupling	35.68
830-020	2" TXT Coupling	32.89



90° ELBOW SOC

PART NUMBER	PRODUCT DESCRIPTION	PRICE \$
806-002	1/4" SXS 90° Elbow	4.98
806-003	3/8" SXS 90° Elbow	4.98
806-005	1/2" SXS 90° Elbow	3.94
806-007	3/4" SXS 90° Elbow	4.26
806-010	1" SXS 90° Elbow	6.70
806-012	1-1/4" SXS 90° Elbow	8.96
806-015	1-1/2" SXS 90° Elbow	10.10
806-020	2" SXS 90° Elbow	15.53



90° ELBOW LONG SWEEP SOC

PART NUMBER	PRODUCT DESCRIPTION	PRICE \$
806-005LSF	1/2" SXS 90° Long Sweep	83.58
806-007LSF	3/4" SXS 90° Long Sweep	93.82
806-010LSF	1" SXS 90° Long Sweep	104.88
806-012LSF	1-1/4" SXS 90° Long Sweep	177.36
806-015LSF	1-3/4" SXS 90° Long Sweep	179.82
806-020LSF	2" SXS 90° Long Sweep	198.96

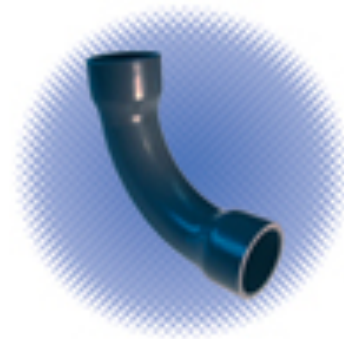

MEDICAL SOLUTIONS INTERNATIONAL
 5646 MERRIAM DRIVE
 MERRIAM, KS 66203
www.medicalsolutionskc.com

800.326.5275
 913.438.9700
 FAX 913.438.9701

90° ELBOW SWEEP SOC X SOC

PART NUMBER	PRODUCT DESCRIPTION	PRICE \$
806-005S	1/2" SXS 90° Sweep	12.23
806-007S	3/4" SXS 90° Sweep	14.39
806-010S	1" SXS 90° Sweep	16.90
806-012S	1-1/4" SXS 90° Sweep	22.38
806-015S	1-3/4" SXS 90° Sweep	24.02
806-020S	2" SXS 90° Sweep	26.43



90° SOC X FIPT

PART NUMBER	PRODUCT DESCRIPTION	PRICE \$
807-002	1/4" SXT 90° Elbow	12.93
807-003	3/8" SXT 90° Elbow	12.78
807-005	1/2" SXT 90° Elbow	12.78
807-007	3/4" SXT 90° Elbow	15.04
807-010	1" SXT 90° Elbow	16.38
807-012	1-1/4" SXT 90° Elbow	19.96
807-015	1-1/2" SXT 90° Elbow	23.26
807-020	2" SXT 90° Elbow	34.99



90° ELBOW FIPT

PART NUMBER	PRODUCT DESCRIPTION	PRICE \$
808-002	1/4" TXT 90° Elbow	8.06
808-003	3/8" TXT 90° Elbow	8.06
808-005	1/2" TXT 90° Elbow	7.52
808-007	3/4" TXT 90° Elbow	10.89
808-010	1" TXT 90° Elbow	12.26
808-012	1-1/4" TXT 90° Elbow	13.56
808-015	1-1/2" TXT 90° Elbow	18.02
808-020	2" TXT 90° Elbow	22.56



MEDICAL SOLUTIONS INTERNATIONAL
5646 MERRIAM DRIVE
MERRIAM, KS 66203
www.medicalsolutionskc.com

800.326.5275
913.438.9700
FAX 913.438.9701

90° STREET ELBOW SPRIG X SOC

PART NUMBER	PRODUCT DESCRIPTION	PRICE \$
809-005	1/2" 90° Street Elbow	4.96
809-007	3/4" 90° Street Elbow	5.87
809-010	1" 90° Street Elbow	12.26
809-012	1-1/4" 90° Street Elbow	12.91
809-015	1-1/2" 90° Street Elbow	12.20
809-020	2" 90° Street Elbow	15.88



45° ELBOW SOC

PART NUMBER	PRODUCT DESCRIPTION	PRICE \$
817-002	1/4" SXS 45° Elbow	11.68
817-003	3/8" SXS 45° Elbow	11.68
817-005	1/2" SXS 45° Elbow	6.12
817-007	3/4" SXS 45° Elbow	9.90
817-010	1" SXS 45° Elbow	14.98
817-012	1-1/4" SXS 45° Elbow	19.34
817-015	1-1/2" SXS 45° Elbow	23.49
817-020	2" SXS 45° Elbow	29.94



45° ELBOW FIPT

PART NUMBER	PRODUCT DESCRIPTION	PRICE \$
819-002	1/4" TXT 45° Elbow	15.57
819-003	3/8" TXT 45° Elbow	16.92
819-005	1/2" TXT 45° Elbow	15.96
819-007	3/4" TXT 45° Elbow	16.85
819-010	1" TXT 45° Elbow	17.57
819-012	1-1/4" TXT 45° Elbow	24.84
819-015	1-1/2" TXT 45° Elbow	31.24
819-020	2" TXT 45° Elbow	46.32



MEDICAL SOLUTIONS INTERNATIONAL
 5646 MERRIAM DRIVE
 MERRIAM, KS 66203
www.medicalsolutionskc.com

800.326.5275
 913.438.9700
 FAX 913.438.9701

45° STREET ELBOW SPIG X SOC

PART NUMBER	PRODUCT DESCRIPTION	PRICE \$
827-005	1/2" 45° Street Elbow	7.56
827-007	3/4" 45° Street Elbow	11.49
827-010	1" 45° Street Elbow	14.73
827-012	1-1/4" 45° Street Elbow	17.86
827-015	1-1/2" 45° Street Elbow	21.12
827-020	2" 45° Street Elbow	27.38



TEE SOC

PART NUMBER	PRODUCT DESCRIPTION	PRICE \$
801-002	1/4" SXSXS Tee	9.96
801-003	3/8" SXSXS Tee	9.96
801-005	1/2" SXSXS Tee	9.35
801-007	3/4" SXSXS Tee	9.60
801-010	1" SXSXS Tee	12.02
801-012	1-1/4" SXSXS Tee	33.04
801-015	1-1/2" SXSXS Tee	33.04
801-020	2" SXSXS Tee	41.30



TEE SOC X FIPT

PART NUMBER	PRODUCT DESCRIPTION	PRICE \$
802-002	1/4" SXSXT Tee	21.20
802-005	1/2" SXSXT Tee	14.50
802-007	3/4" SXSXT Tee	22.12
802-010	1" SXSXT Tee	21.96
802-012	1-1/4" SXSXT Tee	23.46
802-015	1-1/2" SXSXT Tee	27.58
802-020	2" SXSXT Tee	34.02



MEDICAL SOLUTIONS INTERNATIONAL
 5646 MERRIAM DRIVE
 MERRIAM, KS 66203
www.medicalsolutionskc.com

800.326.5275
 913.438.9700
 FAX 913.438.9701

TEE FIPT

PART NUMBER	PRODUCT DESCRIPTION	PRICE \$
805-002	1/4" TXTXT Tee	10.60
805-003	3/8" TXTXT Tee	13.45
805-005	1/2" TXTXT Tee	10.60
805-007	3/4" TXTXT Tee	13.22
805-010	1" TXTXT Tee	26.04
805-012	1-1/4" TXTXT Tee	29.38
805-015	1-1/2" TXTXT Tee	34.68
805-020	2" TXTXT Tee	35.98



CROSS SOC

PART NUMBER	PRODUCT DESCRIPTION	PRICE \$
820-002	1/4" SXS Cross	45.22
820-005	1/2" SXS Cross	45.22
820-007	3/4" SXS Cross	47.56
820-010	1" SXS Cross	57.56
820-012	1-1/4" SXS Cross	66.84
820-015	1-1/2" SXS Cross	72.04
820-020	2" SXS Cross	89.22



CAP SOC

PART NUMBER	PRODUCT DESCRIPTION	PRICE \$
847-002	1/4" Cap Socket	8.79
847-003	3/8" Cap Socket	8.79
847-005	1/2" Cap Socket	7.23
847-007	3/4" Cap Socket	7.51
847-010	1" Cap Socket	11.79
847-012	1-1/4" Cap Socket	13.81
847-015	1-1/2" Cap Socket	13.81
847-020	2" Cap Socket	23.31



CAP FIPT

PART NUMBER	PRODUCT DESCRIPTION	PRICE \$
848-002	1/4" Threaded Cap	7.53
848-003	3/8" Threaded Cap	7.53
848-005	1/2" Threaded Cap	9.38
848-007	3/4" Threaded Cap	10.57
848-010	1" Threaded Cap	12.56
848-012	1-1/4" Threaded Cap	12.98
848-015	1-1/2" Threaded Cap	14.54
848-020	2" Threaded Cap	19.64



PLUG SPIG

PART NUMBER	PRODUCT DESCRIPTION	PRICE \$
849-005	1/2" SPIG Plug	6.89
849-007	3/4" SPIG Plug	7.44
849-010	1" SPIG Plug	8.14
849-012	1-1/4" SPIG Plug	9.83
849-015	1-1/2" SPIG Plug	10.59
849-020	2" SPIG Plug	13.36



PLUG MIPT

PART NUMBER	PRODUCT DESCRIPTION	PRICE \$
850-002	1/4" Threaded Plug	8.46
850-003	3/8" Threaded Plug	7.84
850-005	1/2" Threaded Plug	7.46
850-007	3/4" Threaded Plug	7.75
850-010	1" Threaded Plug	8.42
850-012	1-1/4" Threaded Plug	13.81
850-015	1-1/2" Threaded Plug	15.53
850-020	2" Threaded Plug	14.76



REDUCER BUSHING FLUSH SPIG X SOC		
PART NUMBER	PRODUCT DESCRIPTION	PRICE \$
RB-837-052	3/8" X 1/4" SXS Reducer Bushing	5.72
RB-837-072	1/2" X 1/4" SXS Reducer Bushing	5.72
RB-837-073	1/2" X 3/8" SXS Reducer Bushing	5.72
RB-837-101	3/4" X 1/2" SXS Reducer Bushing	4.89
RB-837-129	1" X 3/8" SXS Reducer Bushing	10.82
RB-837-130	1" X 1/2" SXS Reducer Bushing	5.44
RB-837-131	1" X 3/4" SXS Reducer Bushing	5.44
RB-837-166	1-1/4" X 1/2" SXS Reducer Bushing	8.52
RB-837-167	1-1/4" X 3/4" SXS Reducer Bushing	8.52
RB-837-168	1-1/4" X 1" SXS Reducer Bushing	8.52
RB-837-209	1-1/2" X 1/2" SXS Reducer Bushing	15.04
RB-837-210	1-1/2" X 3/4" SXS Reducer Bushing	13.74
RB-837-211	1-1/2" X 1" SXS Reducer Bushing	11.60
RB-837-212	1-1/2" X 1-1/4" SXS Reducer Bushing	11.60
RB-837-247	2" X 1/2" SXS Reducer Bushing	14.93
RB-837-248	2" X 3/4" SXS Reducer Bushing	16.54
RB-837-249	2" X 1" SXS Reducer Bushing	16.54
RB-837-250	2" X 1-1/4" SXS Reducer Bushing	16.54
RB-837-251	2" X 1/2" SXS Reducer Bushing	16.54
RB-837-290	2-1/2" X 1-1/4" SXS Reducer Bushing	28.72
RB-837-291	2-1/2" X 1-1/2" SXS Reducer Bushing	28.72
RB-837-292	2-1/2" X 2" SXS Reducer Bushing	28.72



MEDICAL SOLUTIONS INTERNATIONAL
 5646 MERRIAM DRIVE
 MERRIAM, KS 66203
www.medicalsolutionskc.com

800.326.5275
 913.438.9700
 FAX 913.438.9701

REDUCER BUSHING FLUSH SPIG X FIPT		
PART NUMBER	PRODUCT DESCRIPTION	PRICE \$
RB-838-052	3/8"X 1/4" SXT Reducer Bushing	4.72
RB-838-071	1/2"X 1/8" SXT Reducer Bushing	5.20
RB-838-072	1/2"X 1/4" SXT Reducer Bushing	5.79
RB-838-073	1/2"X 3/8" SXT Reducer Bushing	5.72
RB-838-098	3/4"X 1/4" SXT Reducer Bushing	5.20
RB-838-099	3/4"X 3/8" SXT Reducer Bushing	7.93
RB-838-101	3/4"X 1/2" SXT Reducer Bushing	4.56
RB-838-127	1"X 1/8" SXT Reducer Bushing	5.44
RB-838-129	1"X 3/8" SXT Reducer Bushing	9.85
RB-838-130	1"X 1/2" SXT Reducer Bushing	5.44
RB-838-131	1"X 3/4" SXT Reducer Bushing	5.44
RB-838-166	1-1/4"X 1/2" SXT Reducer Bushing	11.02
RB-838-167	1-1/4"X 3/4" SXT Reducer Bushing	11.02
RB-838-168	1-1/4"X 1" SXT Reducer Bushing	11.02
RB-838-206	1-1/2"X 1/8" SXT Reducer Bushing	13.82
RB-838-207	1-1/2"X 1/4" SXT Reducer Bushing	13.14
RB-838-209	1-1/2"X 1/2" SXT Reducer Bushing	16.86
RB-838-210	1-1/2"X 3/4" SXT Reducer Bushing	12.54
RB-838-211	1-1/2"X 1" SXT Reducer Bushing	13.79
RB-838-212	1-1/2"X 1-1/4" SXT Reducer Bushing	12.54
RB-838-247	2"X 1/2" SXT Reducer Bushing	15.34
RB-838-248	2"X 3/4" SXT Reducer Bushing	16.18
RB-838-249	2"X 1" SXT Reducer Bushing	18.18
RB-838-250	2"X 1-1/4" SXT Reducer Bushing	18.34
RB-838-251	2"X 1-1/2" SXT Reducer Bushing	18.34



MEDICAL SOLUTIONS INTERNATIONAL
 5646 MERRIAM DRIVE
 MERRIAM, KS 66203
www.medicalsolutionskc.com

800.326.5275
 913.438.9700
 FAX 913.438.9701

REDUCER BUSHING FLUSH MIPT X FIPT

PART NUMBER	PRODUCT DESCRIPTION	PRICE \$
TRB-839-041	1/4" X 1/8" TXT Reducer Bushing	11.84
TRB-839-052	3/8" X 1/4" TXT Reducer Bushing	12.10
TRB-839-072	1/2" X 1/4" TXT Reducer Bushing	11.86
TRB-839-073	1/2" X 3/8" TXT Reducer Bushing	12.18
TRB-839-098	3/4" X 1/4" TXT Reducer Bushing	8.84
TRB-839-099	3/4" X 3/8" TXT Reducer Bushing	9.30
TRB-839-101	3/4" X 1/2" TXT Reducer Bushing	7.26
TRB-839-128	1" X 1/4" TXT Reducer Bushing	14.26
TRB-839-129	1" X 3/8" TXT Reducer Bushing	15.97
TRB-839-130	1" X 1/2" TXT Reducer Bushing	11.40
TRB-839-131	1" X 3/4" TXT Reducer Bushing	11.40
TRB-839-166	1-1/4" X 1/2" TXT Reducer Bushing	12.32
TRB-839-167	1-1/4" X 3/4" TXT Reducer Bushing	12.10
TRB-839-168	1-1/4" X 1" TXT Reducer Bushing	12.94
TRB-839-209	1-1/2" X 1/2" TXT Reducer Bushing	18.66
TRB-839-210	1-1/2" X 3/4" TXT Reducer Bushing	16.10
TRB-839-211	1-1/2" X 1" TXT Reducer Bushing	14.34
TRB-839-212	1-1/2" X 1-1/4" TXT Reducer Bushing	14.34
TRB-839-247	2" X 1/2" TXT Reducer Bushing	21.00
TRB-839-248	2" X 3/4" TXT Reducer Bushing	21.00
TRB-839-249	2" X 1" TXT Reducer Bushing	21.00
TRB-839-250	2" X 1-1/4" TXT Reducer Bushing	21.00
TRB-839-251	2" X 1-1/2" TXT Reducer Bushing	21.00
TRB-839-292	2-1/2" X 2" TXT Reducer Bushing	28.44



UNION (OLD STYLE) FIPT W/EDPM O-RING SEAL

PART NUMBER	PRODUCT DESCRIPTION	PRICE \$
898-005	1/2" Threaded Union EPDM	16.68
898-007	3/4" Threaded Union EPDM	21.88
898-010	1" Threaded Union EPDM	28.70
898-012	1-1/4" Threaded Union EDPM	92.52
898-015	1-1/2" Threaded Union EDPM	60.78
898-020	2" Threaded Union EDPM	106.77

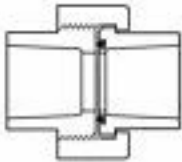
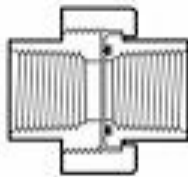

UNION (OLD STYLE) SOC W/EDPM O-RING SEAL

PART NUMBER	PRODUCT DESCRIPTION	PRICE \$
897-005	1/2" Socket Union EPDM	13.57
897-007	3/4" Socket Union EPDM	17.23
897-010	1" Socket Union EPDM	19.99
897-012	1-1/4" Socket Union EDPM	37.08
897-015	1-1/2" Socket Union EDPM	38.84
897-020	2" Socket Union EDPM	64.64
897-025	2-1/2" Socket Union EDPM	83.78
897-030	3" Socket Union EDPM	104.66
897-040	4" Socket Union EDPM	135.66



MEDICAL SOLUTIONS INTERNATIONAL
 5646 MERRIAM DRIVE
 MERRIAM, KS 66203
www.medicalsolutionskc.com

800.326.5275
 913.438.9700
 FAX 913.438.9701

TANK ADAPTER WITH EDPM GASKET SOC X F

PART NUMBER	PRODUCT DESCRIPTION	PRICE \$
871-E-005	1/2" SXT Bulkhead	54.79
871-E-007	3/4" SXT Bulkhead	55.65
871-E-010	1" SXT Bulkhead	52.99
871-E-012	1-1/4" SXT Bulkhead	70.88
871-E-015	1-1/2" SXT Bulkhead	75.66
871-E-020	2" SXT Bulkhead	91.91

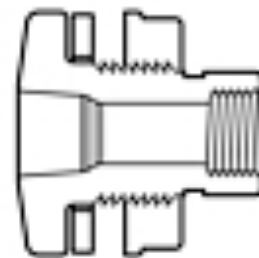

TANK ADAPTER WITH EDPM GASKET FIPT

PART NUMBER	PRODUCT DESCRIPTION	PRICE \$
872-E-005	1/2" TXT Bulkhead	62.42
872-E-007	3/4" TXT Bulkhead	66.05
872-E-010	1" TXT Bulkhead	74.71
872-E-012	1-1/4" TXT Bulkhead	71.91
872-E-015	1-1/2" TXT Bulkhead	77.78
872-E-020	2" TXT Bulkhead	101.74

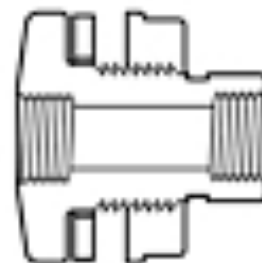

BULKHEAD FITTINGS

PART NUMBER	PRODUCT DESCRIPTION	PRICE \$
BH-50	1/2" TXT Banjo Bulkhead Fitting	27.84
BH-75	3/4" TXT Banjo Bulkhead Fitting	29.62
BH-16439	1/2" White Bulkhead	39.56



NIPPLES 1/4"

PART NUMBER	PRODUCT DESCRIPTION	PRICE \$
880-005	Close 1/4" NIPPLE	3.49
880-015	1-1/2" Long 1/4" Nipple	4.33
880-020	2" Long 1/4" Nipple	4.33
880-025	2-1/2" Long 1/4" Nipple	5.75
880-030	3" Long 1/4" Nipple	5.75



NIPPLES 3/8"

PART NUMBER	PRODUCT DESCRIPTION	PRICE \$
881-005	Close 3/8" Nipple	5.88
881-015	1-1/2" Long 3/8" Nipple	5.92
881-020	2" Long 3/8" Nipple	5.98
881-025	2-1/2" Long 3/8" Nipple	6.47
881-030	3" Long 3/8" Nipple	6.47



NIPPLES 1/2"

PART NUMBER	PRODUCT DESCRIPTION	PRICE \$
882-005	Close 1/2" Nipple	3.72
882-015	1-1/2" Long 1/2" Nipple	3.72
882-020	2" Long 1/2" Nipple	3.96
882-025	2-1/2" Long 1/2" Nipple	3.98
882-030	3" Long 1/2" Nipple	4.46
882-035	3-1/2" Long 1/2" Nipple	4.46
882-040	4" Long 1/2" Nipple	5.24
882-045	4-1/2" Long 1/2" Nipple	5.24
882-050	5" Long 1/2" Nipple	6.55
882-055	5-1/2" Long 1/2" Nipple	8.22
882-060	6" Long 1/2" Nipple	6.12
882-060M	6" Long 1/2" Nipple Machine Cut	6.35



MEDICAL SOLUTIONS INTERNATIONAL
5646 MERRIAM DRIVE
MERRIAM, KS 66203
www.medicalsolutionskc.com

800.326.5275
913.438.9700
FAX 913.438.9701

NIPPLES 3/4"

PART NUMBER	PRODUCT DESCRIPTION	PRICE \$
883-005	Close 3/4" Nipple	3.96
883-015	1-1/2" Long 3/4" Nipple	3.96
883-020	2" Long 3/4" Nipple	4.46
883-025	2-1/2" Long 3/4" Nipple	4.18
883-030	3" Long 3/4" Nipple	5.82
883-035	3-1/2" Long 3/4" Nipple	6.12
883-040	4" Long 3/4" Nipple	7.30
883-045	4-1/2" Long 3/4" Nipple	7.58
883-050	5" Long 3/4" Nipple	6.23
883-055	5-1/2" Long 3/4" Nipple	6.45
883-060	6" Long 3/4" Nipple	6.53
883-140M	14" Long x 3/4" Nipple Machine C	9.72



NIPPLES 1"

PART NUMBER	PRODUCT DESCRIPTION	PRICE \$
884-005	Close 1" Nipple	5.24
884-015	1-1/2" Long 1" Nipple	6.56
884-020	2" Long 1" Nipple	6.33
884-025	2-1/2" Long 1" Nipple	6.40
884-030	3" Long 1" Nipple	7.58
884-035	3-1/2" Long 1" Nipple	6.54
884-040	4" Long 1" Nipple	7.58
884-045	4-1/2" Long 1" Nipple	8.89
884-050	5" Long 1" Nipple	8.89
884-055	5-1/2" Long 1" Nipple	9.72
884-060	6" Long 1" Nipple	10.42



MEDICAL SOLUTIONS INTERNATIONAL
 5646 MERRIAM DRIVE
 MERRIAM, KS 66203
www.medicalsolutionskc.com

800.326.5275
 913.438.9700
 FAX 913.438.9701

NIPPLES 1-1/4"

PART NUMBER	PRODUCT DESCRIPTION	PRICE \$
885-005	Close 1-1/4" Nipple	7.58
885-015	1-1/2" Long 1-1/4" Nipple	7.70
885-020	2" Long 1-1/4" Nipple	7.80
885-025	2-1/2" Long 1-1/4" Nipple	8.84
885-030	3" Long 1-1/4" Nipple	7.53
885-035	3-1/2" Long 1-1/4" Nipple	7.72
885-040	4" Long 1-1/4" Nipple	7.72
885-045	4-1/2" Long 1-1/4" Nipple	7.97
885-050	5" Long 1-1/4" Nipple	7.97
885-055	5-1/2" Long 1-1/4" Nipple	8.48
885-060	6" Long 1-1/4" Nipple	13.00



NIPPLES 1-1/2"

PART NUMBER	PRODUCT DESCRIPTION	PRICE \$
886-005	Close 1-1/2" Nipple	8.28
886-015	1-1/2" Long 1-1/2" Nipple	6.99
886-020	2" Long 1-1/2" Nipple	8.22
886-025	2-1/2" Long 1-1/2" Nipple	10.05
886-030	3" Long 1-1/2" Nipple	10.42
886-035	3-1/2" Long 1-1/2" Nipple	12.12
886-040	4" Long 1-1/2" Nipple	13.92
886-045	4-1/2" Long 1-1/2" Nipple	15.66
886-050	5" Long 1-1/2" Nipple	16.20
886-055	5-1/2" Long 1-1/2" Nipple	17.98
886-060	6" Long 1-1/2" Nipple	16.74



MEDICAL SOLUTIONS INTERNATIONAL
5646 MERRIAM DRIVE
MERRIAM, KS 66203
www.medicalsolutionskc.com

800.326.5275
913.438.9700
FAX 913.438.9701

BALL VALVES		
PART NUMBER	PRODUCT DESCRIPTION	PRICE \$
BV-A1610-015	1-1/2" ASHAI True Union Ball Valve	173.70
BV-6621-007	3/4" Compact Ball Valve TXT	72.40
BV-2121-010	1" Compact Ball Valve TXT	103.96
BV-6622-007	3/4" Compact Ball Valve SXS	69.22
BV-2122-010	1" Compact Ball Valve SXS	103.96
BV-2122-015	1-1/2" Compact Ball Valve SXS	230.86
BV-2264F4MB	1/4" Female Thread x Male Barb Labcock Ball Valve	57.34
BV-2621-005G	1/2" Utility Ball Valve TXT (GRAY)	36.40
BV-2621-005W	1/2" Sample Port Ball Valve TXT (WHITE)	29.48
BV-2621-SAMPLE	1/2" Sample Port Ball Valve Set up	36.40
BV-ASHAI-3WAY	ASHAI 3 WAY 1/2" Ball Valve Tee TYPE 23	188.12
BV-PVC-350E	Ball Valve 1/2" 3 WAY (w/gray handle)	77.50
BV-SMC-25FF	Ball Valve 1/4" Female NPT x 1/4" Female NPT	22.99
BV-SMC-25MF	Ball Valve 1/4" Male NPT x 1/4" Female NPT	22.99
BV-SS-4F	Ball Valve Stainless Steel 1/4" Male x Female NPT	26.38



MEDICAL SOLUTIONS INTERNATIONAL
 5646 MERRIAM DRIVE
 MERRIAM, KS 66203
www.medicalsolutionskc.com

800.326.5275
 913.438.9700
 FAX 913.438.9701

CHECK VALVES

PART NUMBER	PRODUCT DESCRIPTION	PRICE \$
CV-4529-005	1/2" Check Valve True Union Ball Check	111.58
CV-4529-007	3/4" Check Valve True Union Ball Check	126.40
CV-4529-010	1" Check Valve True Union Ball Check	150.36
CV-4529-015	1-1/2" Check Valve True Union Ball Check	252.12
CV-6858F8F-E	1/2" Check Valve Black	22.85
CV-68712F12F	3/4" Check Valve Black	25.95



GATE VALVES

PART NUMBER	PRODUCT DESCRIPTION	PRICE \$
GV-2021-005	1/2" Threaded Gate Valve	66.60
GV-2021-010	1" Threaded Gate Valve	98.53
GV-2022-005	1/2" Socket Gate Valve	66.60
GV-2022-010	1" Socket Gate Valve	98.53



MEDICAL SOLUTIONS INTERNATIONAL
 5646 MERRIAM DRIVE
 MERRIAM, KS 66203
www.medicalsolutionskc.com

800.326.5275
 913.438.9700
 FAX 913.438.9701

BARBED FITTINGS

47

PVC

PART NUMBER	PRODUCT DESCRIPTION	PRICE \$
HB-P4MCB4	1/4" Male NPT x 1/4" Barb (black)	1.48
HB-P4MEB4	1/4" Male NPT x 1/4" Barb Elbow (black)	1.94
1407-010	1" Female NPT X 1" Barb Elbow	8.24
1407-131	3/4" Female NPT X 1" Barb Elbow	7.44
1413-007	3/4" Male NPT X 3/4" Barb Elbow	9.16
1413-010	1" Male NPT X 1" Barb Elbow	11.94
1413-101	1/2" Male NPT X 3/4" Barb Elbow	11.34
1435-007	3/4" Female NPT X 3/4" Barb Elbow	12.68
1436-007	3/4" Male NPT X 3/4" Barb Straight	7.82
1436-010	1" Male NPT X 1" Barb Straight	8.73
1436-074	1/2 Male NPT X 3/4" Barb Straight	8.30
1436-101	3/4" Male NPT x 1/2" Barb Straight	6.50
1436-102	3/4" Male NPT X 1" Barb Straight	8.68
1436-131	1" Male NPT X 3/4" Barb Straight	7.74

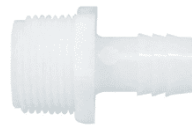

POLYPROPYLENE FITTINGS

PART NUMBER	PRODUCT DESCRIPTION	PRICE \$
POLY-64822	1/2" Male NPT X 3/8" Barb Straight	1.82
POLY-64489	1/2" Male NPT X 3/8" Barb Elbow	1.82

CUSTOM FAUCET

PART NUMBER	PRODUCT DESCRIPTION	PRICE \$
PVC-80-005	1/2" Formed Faucet	28.06



MEDICAL SOLUTIONS INTERNATIONAL
 5646 MERRIAM DRIVE
 MERRIAM, KS 66203
www.medicalsolutionskc.com

800.326.5275
 913.438.9700
 FAX 913.438.9701

QUICK DISCONNECT FITTINGS

48



GARDEN HOSE THREAD BODY POLYSULFONE (white)

PART NUMBER	FLOW	PRODUCT DESCRIPTION	PRICE \$
QD-HFCD101235GHT	3/8"	3/4" MGHT PSF Inline coupling insert w/Shut-off	38.90
QD-HFCD191235GHT	3/8"	3/4" FGHT PSF Inline coupling insert w/Shut-off	35.20
QD-HFC101235GHT	3/8"	3/8" MGHT PSF Coupler body Straight-thru	28.54
QD-HFC191235GHT	3/8"	3/4" FGHT PSF Coupler body Straight-thru	35.20



HIGH FLOW COUPLINGS BODIES POLYPROPYLENE (gray)

PART NUMBER	FLOW	PRODUCT DESCRIPTION	PRICE \$
QD-HFCD10612	3/8"	3/8" MNPT PP Coupler body w/Shut-off	25.49
QD-HFCD10812	3/8"	1/2" MNPT PP Coupler body w/Shut-off	34.95
QD-HFC10612	3/8"	3/8" MNPT PSF Coupler body Straight-thru	25.96
QD-HFC10812	3/8"	1/2" MNPT PSF Coupler body Straight-thru	24.50



HIGH FLOW COUPLINGS BODIES POLYSULFONE (white)

PART NUMBER	FLOW	PRODUCT DESCRIPTION	PRICE \$
QD-HFCD10635	3/8"	3/8" MNPT PSF Coupler body w/Shut-off	32.44
QD-HFCD10835	3/8"	1/2" MNPT PSF Coupler body w/Shut-off	34.95
QD-HFC10635	3/8"	3/8" MNPT PSF Coupler body Straight-thru	35.95
QD-HFC10835	3/8"	1/2" MNPT PSF Coupler body Straight-thru	35.22



MEDICAL SOLUTIONS INTERNATIONAL
 5646 MERRIAM DRIVE
 MERRIAM, KS 66203
www.medicalsolutionskc.com

800.326.5275
 913.438.9700
 FAX 913.438.9701

IN-LINE HOSE BARB BODY POLYPROPYLENE (gray)

PART NUMBER	FLOW	PRODUCT DESCRIPTION	PRICE \$
QD-HFCD17612	3/8"	3/8" ID PP Barbed Inline body w/Shut-off	32.36
QD-HFCD17812	3/8"	1/2" ID PP Barbed Inline body w/Shut-off	32.36
QD-HFCD171212	3/8"	3/4" ID PP Barbed Inline body w/Shut-off	32.85
QD-HFC17612	3/8"	3/8" ID PP Barbed inline body Straight-thru	26.36
QD-HFC17812	3/8"	1/2" ID PP Barbed inline body Straight-thru	26.95
QD-HFC171212	3/8"	3/4" ID PP Barbed inline body Straight-thru	28.12



IN-LINE HOSE BARB BODY POLYSULFONE (white)

PART NUMBER	FLOW	PRODUCT DESCRIPTION	PRICE \$
QD-HFCD17635	3/8"	3/8" ID PSF Barbed Inline body w/Shut-off	32.66
QD-HFCD17835	3/8"	1/2" ID PSF Barbed Inline body w/Shut-off	38.42
QD-HFCD171235	3/8"	3/4" ID PSF Barbed Inline body w/Shut-off	38.42



PANEL MOUNT HOSE BARB BODY POLYPROPYLENE (gray)

PART NUMBER	FLOW	PRODUCT DESCRIPTION	PRICE \$
QD-HFCD16612	3/8"	3/8" ID PP Panel mount body w/Shut-off	34.95
QD-HFCD16812	3/8"	1/2" ID PP Panel mount body w/Shut-off	38.42
QD-HFCD161212	3/8"	3/4" ID PP Panel mount body w/Shut-off	34.95
QD-HFC16612	3/8"	3/8" ID PP Panel mount body Straight-thru	29.95
QD-HFC16812	3/8"	1/2" ID PP Panel mount body Straight-thru	29.95
QD-HFC161212	3/8"	3/4" ID PP Panel mount body Straight-thru	29.95



PANEL MOUNT HOSE BARB BODY POLYSULFONE (white)

PART NUMBER	FLOW	PRODUCT DESCRIPTION	PRICE \$
QD-HFCD16635	3/8"	3/8" ID PSF Panel mount body w/Shut-off	39.16
QD-HFCD16835	3/8"	1/2" ID PSF Panel mount body w/Shut-off	40.14
QD-HFCD161235	3/8"	3/4" ID PSF Panel mount body w/Shut-off	44.34
QD-HFC16635	3/8"	3/8" ID PSF Panel mount body Straight-thru	39.76
QD-HFC16835	3/8"	1/2" ID PSF Panel mount body Straight-thru	39.88
QD-HFC161235	3/8"	3/4" ID PSF Panel mount body Straight-thru	38.65



MEDICAL SOLUTIONS INTERNATIONAL
 5646 MERRIAM DRIVE
 MERRIAM, KS 66203
www.medicalsolutionskc.com

800.326.5275
 913.438.9700
 FAX 913.438.9701

HIGH FLOW COUPLING INSERTS

GARDEN HOSE THREAD INSERT POLYSULFONE (white)

PART NUMBER	FLOW	PRODUCT DESCRIPTION	PRICE \$
QD-HFCD261235GHT	3/8"	3/4" FGHT PSF Inline coupling insert w/Shut-off	34.26
QD-HFC241235GHT	3/8"	3/4" MGHT PSF Inline coupling insert Straight-thru	17.82
QD-HFC261235GHT	3/8"	3/4" FGHT PSF Inline coupling insert Straight-thru	24.92
QD-HFCD241235GHT	3/8"	3/4" MGHT PSF Inline coupling insert w/Shut-off	32.26



PIPE THREAD INSERT POLYPROPYLENE (gray)

PART NUMBER	FLOW	PRODUCT DESCRIPTION	PRICE \$
QD-HFCD24612	3/8"	3/8" MNPT PP Inline coupling insert w/Shut-off	25.18
QD-HFCD24812	3/8"	1/2" MNPT PP Inline coupling insert w/Shut-off	25.42
QD-HFC24612	3/8"	3/8" MNPT PP Inline coupling insert Straight-thru	11.61
QD-HFC24812	3/8"	1/2" MNPT PP Inline coupling insert Straight-thru	10.92



PIPE THREAD INSERT POLYSULFONE (white)

PART NUMBER	FLOW	PRODUCT DESCRIPTION	PRICE \$
QD-HFCD24635	3/8"	3/8" MNPT PSF Inline coupling insert w/Shut-off	29.95
QD-HFCD24835	3/8"	1/2" MNPT PSF Inline coupling insert w/Shut-off	29.95
QD-HFC24635	3/8"	3/8" MNPT PSF Inline coupling insert Straight-thru	19.68
QD-HFC24835	3/8"	1/2" MNPT PSF Inline coupling insert Straight-thru	19.68



MEDICAL SOLUTIONS INTERNATIONAL
5646 MERRIAM DRIVE
MERRIAM, KS 66203
www.medicalsolutionskc.com

800.326.5275
913.438.9700
FAX 913.438.9701

HIGH FLOW COUPLING INSERTS

HOSE BARB INSERT POLYPROPYLENE (gray)

PART NUMBER	FLOW	PRODUCT DESCRIPTION	PRICE \$
QD-HFCD22612	3/8"	3/8" ID PP Barbed coupling insert w/Shut-off	24.72
QD-HFCD22812	3/8"	1/2" ID PP Barbed coupling insert w/Shut-off	24.95
QD-HFCD221212	3/8"	3/4" ID PP Barbed coupling insert w/Shut-off	25.50
QD-HFC22612	3/8"	3/8" ID PP Barbed coupling insert Straight-thru	11.52
QD-HFC22812	3/8"	1/2" ID PP Barbed coupling insert Straight-thru	16.56
QD-HFC221212	3/8"	3/4" ID PP Barbed coupling insert Straight-thru	12.80



HOSE BARB INSERT POLYSULFONE (white)

PART NUMBER	FLOW	PRODUCT DESCRIPTION	PRICE \$
QD-HFCD22635	3/8"	3/8" ID PSF Barbed coupling insert w/Shut-off	28.22
QD-HFCD22835	3/8"	1/2" ID PSF Barbed coupling insert w/Shut-off	28.85
QD-HFCD221235	3/8"	3/4" ID PSF Barbed coupling insert w/Shut-off	29.46
QD-HFC22635	3/8"	3/8" ID PSF Barbed coupling insert Straight-thru	12.46
QD-HFC22835	3/8"	1/2" ID PSF Barbed coupling insert Straight-thru	16.62
QD-HFC221235	3/8"	3/4" ID PSF Barbed coupling insert Straight-thru	18.76



ELBOW HOSE BARB INSERT POLYPROPYLENE (gray)

PART NUMBER	FLOW	PRODUCT DESCRIPTION	PRICE \$
QD-HFCD23612	3/8"	3/8" ID PP Barbed coupling insert w/Shut-off	29.94
QD-HFCD23812	3/8"	1/2" ID PP Barbed coupling insert w/Shut-off	28.78
QD-HFC23612	3/8"	3/8" ID PP Barbed elbow insert Straight-thru	18.58
QD-HFC23812	3/8"	1/2" ID PP Barbed elbow insert Straight-thru	18.78



ELBOW HOSE BARB INSERT POLYSULFONE (white)

PART NUMBER	FLOW	PRODUCT DESCRIPTION	PRICE \$
QD-HFCD23635	3/8"	3/8" ID PSF Barbed coupling insert w/Shut-off	35.22
QD-HFCD23835	3/8"	1/2" ID PSF Barbed coupling insert w/Shut-off	31.56
QD-HFC23635	3/8"	3/8" ID PSF Barbed elbow insert Straight-thru	19.44
QD-HFC23835	3/8"	1/2" ID PSF Barbed elbow insert Straight-thru	19.35



MEDICAL SOLUTIONS INTERNATIONAL
 5646 MERRIAM DRIVE
 MERRIAM, KS 66203
www.medicalsolutionskc.com

800.326.5275
 913.438.9700
 FAX 913.438.9701

LOW FLOW COUPLING INSERTS

MALE PIPE THREAD ACETAL (white)

PART NUMBER	FLOW	PRODUCT DESCRIPTION	PRICE \$
QD-PMC1002	1/8"	1/8" MT Pipe thread body Straight-thru	17.42
QD-PMC1004	1/8"	1/4" MT Pipe thread body Straight-thru	13.55
QD-PLC10004	1/4"	1/4" MT Pipe thread body Straight-thru	25.50
QD-PLC10006	1/4"	3/8" MT Pipe thread body Straight-thru	18.42
QD-PMCD1002	1/8"	1/8" MT Pipe thread body w/Shut-off	15.68
QD-PMCD1004	1/8"	1/4" MT Pipe thread body w/Shut-off	15.68
QD-PLCD10006	1/4"	3/8" MT Pipe thread body w/Shut-off	14.72



MALE PIPE THREAD POLYPRO (beige)

PART NUMBER	FLOW	PRODUCT DESCRIPTION	PRICE \$
QD-PMC100212	1/8"	1/8" MT Pipe thread body Straight-thru	19.28
QD-PMC100412	1/8"	1/4" MT Pipe thread body Straight-thru	15.76
QD-PLC1000412	1/4"	1/4" MT Pipe thread body Straight-thru	19.28
QD-PLC1000612	1/4"	3/8" MT Pipe thread body Straight-thru	20.18
QD-PMCD100212	1/8"	1/8" MT Pipe thread body w/Shut-off	17.33
QD-PMCD100412	1/8"	1/4" MT Pipe thread body w/Shut-off	17.93
QD-PLCD1000412	1/4"	3/8" MT Pipe thread body w/Shut-off	18.54
QD-PLCD1000612	1/4"	3/8" MT Pipe thread body w/Shut-off	20.18



MEDICAL SOLUTIONS INTERNATIONAL
 5646 MERRIAM DRIVE
 MERRIAM, KS 66203
www.medicalsolutionskc.com

800.326.5275
 913.438.9700
 FAX 913.438.9701

LOW FLOW COUPLING INSERTS

IN-LINE HOSE BARB ACETAL (white)			
PART NUMBER	FLOW	PRODUCT DESCRIPTION	PRICE \$
QD-PMC1701	1/8"	1/16" Barb inline body Straight-thru	14.84
QD-PMC1702	1/8"	1/8" Barb inline body Straight-thru	10.06
QD-PMC1704	1/8"	1/4" Barb inline body Straight-thru	9.88
QD-PLC17004	1/4"	1/4" Barb inline body Straight-thru	8.99
QD-PLC17006	1/4"	3/8" Barb inline body Straight-thru	9.99
QD-PMCD1701	1/8"	1/16" Barb inline body w/Shut-off	18.76
QD-PMCD1702	1/8"	1/8" Barb inline body w/Shut-off	19.32
QD-PMCD1704	1/8"	1/4" Barb inline body w/Shut-off	19.32
QD-PLCD17004	1/4"	1/4" Barb inline body w/Shut-off	14.02
QD-PLCD17006	1/4"	3/8" Barb inline body w/Shut-off	14.02



IN-LINE HOSE BARB POLYPRO (beige)			
PART NUMBER	FLOW	PRODUCT DESCRIPTION	PRICE \$
QD-PMC170212	1/8"	1/16" Barb inline body Straight-thru	22.70
QD-PMC170412	1/8"	1/4" Barb inline body Straight-thru	23.54
QD-PLC1700412	1/4"	1/4" Barb inline body Straight-thru	20.98
QD-PLC1700612	1/4"	3/8" Barb inline body Straight-thru	21.48
QD-PMCD170112	1/8"	1/16" Barb inline body w/Shut-off	35.18
QD-PMCD170212	1/8"	1/8" Barb inline body w/Shut-off	22.72
QD-PMCD170412	1/8"	1/4" Barb inline body w/Shut-off	31.90
QD-PLCD1700612	1/4"	3/8" Barb inline body w/Shut-off	32.54



MEDICAL SOLUTIONS INTERNATIONAL
 5646 MERRIAM DRIVE
 MERRIAM, KS 66203
www.medicalsolutionskc.com

800.326.5275
 913.438.9700
 FAX 913.438.9701

QUICK DISCONNECT FITTINGS

54

LOW FLOW COUPLING INSERTS

PANEL-MOUNT HOSE BARB ACETAL (white)

PART NUMBER	FLOW	PRODUCT DESCRIPTION	PRICE \$
QD-PMC1601NA	1/8"	1/16" Barb panel mount body Straight-thru	17.49
QD-PMC1602NA	1/8"	1/8" Barb panel mount body Straight-thru	16.11
QD-PMC1604NA	1/8"	1/4" Barb panel mount body Straight-thru	16.16
QD-PLC16004NA	1/4"	1/4" Barb panel mount body Straight-thru	19.85
QD-PMCD1601NA	1/8"	1/16" Barb panel mount body w/Shut-off	25.34
QD-PMCD1602NA	1/8"	1/8" Barb panel mount body w/Shut-off	25.35
QD-PMCD1604NA	1/8"	1/4" Barb panel mount body w/Shut-off	28.34
QD-PLCD16004NA	1/4"	1/4" Barb panel mount body w/Shut-off	23.70
QD-PLCD16006NA	1/4"	3/8" Barb panel mount body w/Shut-off	22.96



PANEL-MOUNT HOSE BARB POLYPRO (beige)

PART NUMBER	FLOW	PRODUCT DESCRIPTION	PRICE \$
QD-PMC160112NA	1/8"	1/16" Barb panel mount body Straight-thru	18.58
QD-PMC160212NA	1/8"	1/8" Barb panel mount body Straight-thru	18.73
QD-PMC16042NA	1/8"	1/4" Barb panel mount body Straight-thru	16.32
QD-PLC1600412NA	1/4"	1/4" Barb panel mount body Straight-thru	31.00
QD-PLC1600612NA	1/4"	3/8" Barb panel mount body Straight-thru	23.62
QD-PMCD160112NA	1/8"	1/16" Barb panel mount body w/Shut-off	20.63
QD-PMCD160212NA	1/8"	1/8" Barb panel mount body w/Shut-off	20.98
QD-PMCD160412NA	1/8"	1/4" Barb panel mount body w/Shut-off	21.52
QD-PLCD1600412NA	1/4"	1/4" Barb panel mount body w/Shut-off	31.30
QD-PLCD1600612NA	1/4"	3/8" Barb panel mount body w/Shut-off	35.46



MEDICAL SOLUTIONS INTERNATIONAL
5646 MERRIAM DRIVE
MERRIAM, KS 66203
www.medicalsolutionskc.com

800.326.5275
913.438.9700
FAX 913.438.9701

LOW FLOW COUPLING INSERTS

IN-LINE FERRULESS COMPRESSION FITTING ACETAL (white)			
PART NUMBER	FLOW	PRODUCT DESCRIPTION	PRICE \$
QD-PMC1304NA	1/8"	1/4" OD Inline body Straight-thru	16.76
QD-PLC13006NA	1/4"	3/8" OD Inline body Straight-thru	21.60
QD-PMCD1304NA	1/8"	1/4" OD Inline body w/Shut-off	22.20
QD-PLCD13006NA	1/4"	3/8" OD Inline body w/Shut-off	45.28



IN-LINE FERRULESS COMPRESSION FITTING POLYPRO (beige)			
PART NUMBER	FLOW	PRODUCT DESCRIPTION	PRICE \$
QD-PMC130412NA	1/8"	1/4" OD Inline body Straight-thru	28.19
QD-PLC1300612NA	1/4"	3/8" OD Inline body Straight-thru	17.24
QD-PMCD130412NA	1/8"	1/4" OD Inline body w/Shut-off	28.19
QD-PLCD1300612NA	1/4"	3/8" OD Inline body w/Shut-off	44.44

PANEL-MOUNT FERRULESS COMPRESSION FITTING ACETAL (white)			
PART NUMBER	FLOW	PRODUCT DESCRIPTION	PRICE \$
QD-PMC1204NA	1/8"	1/4" OD Panel mount body Straight-thru	18.49
QD-PLC12006NA	1/4"	3/8" OD Panel mount body Straight-thru	29.47
QD-PMCD1204NA	1/8"	1/4" OD Panel mount body w/Shut-off	18.74
QD-PLCD12006NA	1/4"	3/8" OD Panel mount body w/Shut-off	28.12



PANEL-MOUNT FERRULESS COMPRESSION FITTING POLYPRO (beige)			
PART NUMBER	FLOW	PRODUCT DESCRIPTION	PRICE \$
QD-PMC120412NA	1/8"	1/4" OD Panel mount body Straight-thru	22.49
QD-PLC1200612NA	1/4"	3/8" OD Panel mount body Straight-thru	20.96
QD-PMCD120412NA	1/8"	1/4" OD Panel mount body w/Shut-off	24.28
QD-PLCD1200612NA	1/4"	3/8" OD Panel mount body w/Shut-off	32.43

MEDICAL SOLUTIONS INTERNATIONAL
 5646 MERRIAM DRIVE
 MERRIAM, KS 66203
www.medicalsolutionskc.com

800.326.5275
 913.438.9700
 FAX 913.438.9701

LOW FLOW COUPLING INSERTS

STRAIGHT HOSE BARB ACETAL (white)

PART NUMBER	FLOW	PRODUCT DESCRIPTION	PRICE \$
QD-PMC2201	1/8"	1/16" Barb CPLG INS Straight-thru	8.38
QD-PMC2202	1/8"	1/8" Barb CPLG INS Straight-thru	5.38
QD-PMC2204	1/8"	1/4" Barb CPLG INS Straight-thru	5.81
QD-PMC22004	1/8"	1/4" Barb CPLG INS Straight-thru	5.66
QD-PLC22006	1/4"	3/8" Barb CPLG INS Straight-thru	3.06
QD-PMCD2201	1/8"	1/16" Barb CPLG INS w/Shut-off	10.28
QD-PMCD2202	1/8"	1/8" Barb CPLG INS w/Shut-off	9.26
QD-PMCD2204	1/8"	1/8" Barb CPLG INS w/Shut-off	9.26
QD-PLCD22004	1/8"	1/4" Barb CPLG INS w/Shut-off	11.35
QD-PLCD22006	1/8"	3/8" Barb CPLG INS w/Shut-off	10.58



STRAIGHT HOSE BARB POLYPRO (beige)

PART NUMBER	FLOW	PRODUCT DESCRIPTION	PRICE \$
QD-PMC220112	1/8"	1/16" Barb valve hose Straight-thru	7.47
QD-PMC220212	1/8"	1/8" Barb valve hose Straight-thru	6.32
QD-PMC220412	1/8"	1/4" Barb valve hose Straight-thru	6.60
QD-PLC2200412	1/4"	1/4" Barb valve hose Straight-thru	18.48
QD-PLC2200612	1/4"	3/8" Barb valve hose Straight-thru	6.21
QD-PMCD220112	1/8"	1/16" Barb valve hose w/Shut-off	20.53
QD-PMCD220212	1/8"	1/8" Barb valve hose w/Shut-off	21.26
QD-PMCD220412	1/8"	1/4" Barb valve hose w/Shut-off	25.85
QD-PLCD2200412	1/4"	1/4" Barb valve hose w/Shut-off	18.48
QD-PLCD2200612	1/4"	3/8" Barb valve hose w/Shut-off	20.42

MEDICAL SOLUTIONS INTERNATIONAL
 5646 MERRIAM DRIVE
 MERRIAM, KS 66203
www.medicalsolutionskc.com

800.326.5275
 913.438.9700
 FAX 913.438.9701

LOW FLOW COUPLING INSERTS

STRAIGHT FERRULESS COMPRESSION FITTING ACETAL (white)

PART NUMBER	FLOW	PRODUCT DESCRIPTION	PRICE \$
QD-PMC2004NA	1/8"	1/4" OD Compression Straight-thru	16.70
QD-PMC2006NA	1/8"	3/8" OD Compression Straight-thru	10.88
QD-PLC20006NA	1/4"	3/8" OD Compression Straight-thru	10.93
QD-PMCD2004NA	1/8"	1/4" OD Compression w/Shut-off	28.42
QD-PMCD2006NA	1/8"	3/8" OD Compression w/Shut-off	37.34
QD-PLCD20006NA	1/4"	3/8" OD Compression w/Shut-off	16.48



STRAIGHT FERRULESS COMPRESSION FITTING POLYPRO (beige)

PART NUMBER	FLOW	PRODUCT DESCRIPTION	PRICE \$
QD-PMC200412NA	1/8"	1/4" OD Compression Straight-thru	11.98
QD-PLC2000612NA	1/4"	3/8" OD Compression Straight-thru	13.04
QD-PMCD200412NA	1/8"	1/4" OD Compression w/Shut-off	26.88
QD-PLCD2000612NA	1/4"	3/8" OD Compression w/Shut-off	25.70



PANEL MOUNT FERRULESS COMPRESSION FITTING ACETAL

PART NUMBER	FLOW	PRODUCT DESCRIPTION	PRICE \$
QD-PMC4004NA	1/8"	1/4" OD Panel mount compression Straight-thru	11.12
QD-PLC40004NA	1/4"	1/4" OD Panel mount compression Straight-thru	15.46
QD-PLC40006NA	1/4"	3/8" OD Panel mount compression Straight-thru	16.21
QD-PMCD4004NA	1/8"	1/4" OD Panel mount compression w/Shut-off	15.73
QD-PLCD40004NA	1/4"	1/4" OD Panel mount compression w/Shut-off	17.76
QD-PLCD40006NA	1/4"	3/8" OD Panel mount compression w/Shut-off	18.63



MEDICAL SOLUTIONS INTERNATIONAL
 5646 MERRIAM DRIVE
 MERRIAM, KS 66203
www.medicalsolutionskc.com

800.326.5275
 913.438.9700
 FAX 913.438.9701

LOW FLOW COUPLING INSERTS

ELBOW HOSE BARB ACETAL (white)

PART NUMBER	FLOW	PRODUCT DESCRIPTION	PRICE \$
QD-PMC2302	1/8"	1/8" ID Barbed elbow Straight-thru	6.47
QD-PMC2304	1/8"	1/4" ID Barbed elbow Straight-thru	7.72
QD-PLC23004	1/4"	1/4" ID Barbed elbow Straight-thru	7.98
QD-PLC23006	1/4"	3/8" ID Barbed elbow Straight-thru	6.48
QD-PMCD2302	1/8"	1/8" ID Barbed elbow w/Shut-off	12.63
QD-PMCD2304	1/8"	1/4" ID Barbed elbow w/Shut-off	12.63
QD-PLCD23004	1/4"	1/4" ID Barbed elbow w/Shut-off	12.23
QD-PLCD23006	1/4"	3/8" ID Barbed elbow w/Shut-off	12.23



ELBOW HOSE BARB POLYPRO (beige)

PART NUMBER	FLOW	PRODUCT DESCRIPTION	PRICE \$
QD-PMC230212	1/8"	1/8" ID Barbed elbow Straight-thru	10.57
QD-PMC230412	1/8"	1/4" ID Barbed elbow Straight-thru	16.98
QD-PLC2300412	1/4"	1/4" ID Barbed elbow Straight-thru	12.96
QD-PLC2300612	1/4"	3/8" ID Barbed elbow Straight-thru	24.94
QD-PMCD230212	1/8"	1/8" ID Barbed elbow w/Shut-off	25.98
QD-PMCD230412	1/8"	1/4" ID Barbed elbow w/Shut-off	15.81
QD-PLCD2300412	1/4"	1/4" ID Barbed elbow w/Shut-off	17.85
QD-PLCD2300612	1/4"	3/8" ID Barbed elbow w/Shut-off	15.52



PANEL MOUNT HOSE BARB ACETAL (white)

PART NUMBER	FLOW	PRODUCT DESCRIPTION	PRICE \$
QD-PMC4202NA	1/8"	1/8" ID Barb panel-mount Straight-thru	11.83
QD-PMC4204NA	1/8"	1/4" ID Barb panel-mount Straight-thru	11.96
QD-PLC42004NA	1/4"	1/4" ID Barb panel-mount Straight-thru	14.93
QD-PLCD42004NA	1/4"	1/4" ID Barb panel-mount w/Shut-off	16.46
QD-PLC42006NA	1/4"	3/8" ID Barb panel-mount Straight-thru	11.67



MEDICAL SOLUTIONS INTERNATIONAL
 5646 MERRIAM DRIVE
 MERRIAM, KS 66203
www.medicalsolutionskc.com

800.326.5275
 913.438.9700
 FAX 913.438.9701

LOW FLOW COUPLING INSERTS

ELBOW FERRULESS COMPRESSION FITTING ACETAL (white)

PART NUMBER	FLOW	PRODUCT DESCRIPTION	PRICE \$
QD-PMC2104NA	1/8"	1/4" OD Elbow Straight-thru	9.69
QD-PMC2106NA	1/8"	3/8" OD Elbow Straight-thru	9.66
QD-PMCD2104NA	1/8"	1/4" OD Elbow w/Shut-off	17.67
QD-PLCD21006NA	1/4"	3/8" OD Elbow w/Shut-off	17.47



ELBOW FERRULESS COMPRESSION FITTING POLYPRO (beige)

PART NUMBER	FLOW	PRODUCT DESCRIPTION	PRICE \$
QD-PLC2100612NA	1/4"	3/8" OD PP Elbow Straight-thru	14.23
QD-PMCD210412NA	1/8"	1/4" OD PP Elbow w/Shut-off	22.93
QD-PLCD2100612NA	1/4"	3/8" OD PP Elbow w/Shut-off	22.63

PIPE THREAD ACETAL (white)

PART NUMBER	FLOW	PRODUCT DESCRIPTION	PRICE \$
QD-PMC2402	1/8"	1/8" Male pipe thread Straight-thru	7.69
QD-PMC2404	1/8"	1/4" Male pipe thread Straight-thru	7.69
QD-PLC24004	1/4"	1/4" Male pipe thread Straight-thru	7.62
QD-PLC24006	1/4"	3/8" Male pipe thread Straight-thru	7.99
QD-PMCD2402	1/8"	1/8" Male pipe thread w/Shut-off	16.88
QD-PMCD2404	1/8"	1/4" Male pipe thread w/Shut-off	19.34



PIPE THREAD POLYPRO (beige)

PART NUMBER	FLOW	PRODUCT DESCRIPTION	PRICE \$
QD-PMC240212	1/8"	1/8" PP Male pipe thread Straight-thru	9.53
QD-PLC2400412	1/4"	1/8" PP Male pipe thread Straight-thru	13.08
QD-PMCD240212	1/8"	1/8" PP Male pipe thread w/Shut-off	15.93
QD-PLCD2400412	1/4"	1/4" PP Male pipe thread w/Shut-off	17.96



MEDICAL SOLUTIONS INTERNATIONAL
 5646 MERRIAM DRIVE
 MERRIAM, KS 66203
www.medicalsolutionskc.com

800.326.5275
 913.438.9700
 FAX 913.438.9701

PARKER MALE CONNECTOR		
PART NUMBER	PRODUCT DESCRIPTION	PRICE \$
P4MC2	1/4" Tube Compression X 1/8" Male NPT	3.84
P4MC4	1/4" Tube Compression X 1/4" Male NPT	3.99
P5MC2	5/16" Tube Compression X 1/8" Male NPT	7.60
P5MC4	5/16" Tube Compression X 1/4" Male NPT	4.48
P6MC2	3/8" Tube Compression X 1/8" Male NPT	5.22
P6MC4	3/8" Tube Compression X 1/4" Male NPT	4.84
P6MC6	3/8" Tube Compression X 3/8" Male NPT	5.48
P6MC8	3/8" Tube Compression X 1/2" Male NPT	5.54
P6MC12	3/8" Tube Compression X 1/8" Male NPT	8.97
P8MC2	1/2" Tube Compression X 1/8" Male NPT	8.99
P8MC4	1/2" Tube Compression X 1/4" Male NPT	5.99
P8MC6	1/2" Tube Compression X 3/8" Male NPT	6.46
P8MC8	1/2" Tube Compression X 1/2" Male NPT	6.90
P8MC12	1/2" Tube Compression X 3/4" Male NPT	7.97
P10MC2	5/8" Tube Compression X 1/8" Male NPT	9.67
P10MC4	5/8" Tube Compression X 1/4" Male NPT	9.66
P10MC6	5/8" Tube Compression X 3/8" Male NPT	8.83
P10MC8	5/8" Tube Compression X 1/2" Male NPT	8.64
P10MC12	5/8" Tube Compression X 3/4" Male NPT	9.88



PARKER FEMALE CONNECTOR		
PART NUMBER	PRODUCT DESCRIPTION	PRICE \$
P4FC2	1/4" Tube Compression X 1/8" Female NPT	8.34
P4FC4	1/4" Tube Compression X 1/4" Female NPT	6.48
P6FC4	3/8" Tube Compression X 1/4" Female NPT	6.08
P6FC6	3/8" Tube Compression X 3/8" Female NPT	9.34
P6FC8	3/8" Tube Compression X 1/2" Female NPT	8.82
P8FC6	1/2" Tube Compression X 3/8" Female NPT	13.40
P8FC8	1/2" Tube Compression X 1/2" Female NPT	11.30
P10FC8	5/8" Tube Compression X 1/2" Female NPT	9.66



MEDICAL SOLUTIONS INTERNATIONAL
 5646 MERRIAM DRIVE
 MERRIAM, KS 66203
www.medicalsolutionskc.com

800.326.5275
 913.438.9700
 FAX 913.438.9701

PARKER MALE BRANCH TEE

PART NUMBER	PRODUCT DESCRIPTION	PRICE \$
P4MT2	1/4" Tube Compression X 1/8" Male NPT	10.80
P4MT4	1/4" Tube Compression X 1/4" Male NPT	9.54
P5MT2	5/16" Tube Compression X 1/8" Male NPT	14.98
P5MT4	5/16" Tube Compression X 1/4" Male NPT	16.32
P6MT4	3/8" Tube Compression X 1/4" Male NPT	10.68
P6MT6	3/8" Tube Compression X 3/8" Male NPT	12.74
P8MT6	1/2" Tube Compression X 3/8" Male NPT	18.54
P8MT8	1/2" Tube Compression X 1/2" Male NPT	19.66
P10MT8	5/8" Tube Compression X 1/2" Male NPT	14.64



PARKER MALE ELBOW

PART NUMBER	PRODUCT DESCRIPTION	PRICE \$
P4ME2	1/4" Tube Compression X 1/8" Male NPT	5.54
P4ME4	1/4" Tube Compression X 1/4" Male NPT	5.06
P4ME6	1/4" Tube Compression X 3/8" Male NPT	6.08
P5ME2	5/16" Tube Compression X 1/8" Male NPT	6.99
P5ME4	5/16" Tube Compression X 1/4" Male NPT	5.43
P5ME6	5/16" Tube Compression X 3/8" Male NPT	10.48
P6ME4	3/8" Tube Compression X 1/4" Male NPT	6.80
P6ME6	3/8" Tube Compression X 3/8" Male NPT	7.18
P6ME8	3/8" Tube Compression X 1/2" Male NPT	5.29
P8ME12	1/2" Tube Compression X 3/4" Male NPT	10.88
P8ME8	1/2" Tube Compression X 1/2" Male NPT	8.98
P10ME8	5/8" Tube Compression X 1/2" Male NPT	9.30



PARKER FEMALE ELBOW

PART NUMBER	PRODUCT DESCRIPTION	PRICE \$
P4FE2	1/4" Tube Compression X 1/8" Female NPT	7.58
P4FE4	1/4" Tube Compression X 1/4" Female NPT	7.98
P5FE2	1/4" Tube Compression X 5/16" Female NPT	13.76
P6FE4	3/8" Tube Compression X 1/4" Female NPT	8.88
P6FE6	3/8" Tube Compression X 3/8" Female NPT	6.92
P8FE6	1/2" Tube Compression X 3/8" Female NPT	9.68
P8FE8	1/2" Tube Compression X 1/2" Female NPT	10.80
P10FE8	5/8" Tube Compression X 5/8" Female NPT	9.70



MEDICAL SOLUTIONS INTERNATIONAL
 5646 MERRIAM DRIVE
 MERRIAM, KS 66203
www.medicalsolutionskc.com

800.326.5275
 913.438.9700
 FAX 913.438.9701

PARKER TEE UNION

PART NUMBER	PRODUCT DESCRIPTION	PRICE \$
P4TU4	1/4" X 1/4" Tube Compression Tee	11.68
P5TU5	5/16" X 5/16" Tube Compression Tee	14.98
P6TU6	3/8" X 3/8" Tube Compression Tee	12.04
P6TU10	3/8" X 5/8" Tube Compression Tee	18.82
P8TU6	1/2" X 3/8" Tube Compression Tee	12.99
P8TU8	1/2" X 1/2" Tube Compression Tee	13.17
P10TU6	5/8" X 3/8" Tube Compression Tee	19.99
P10TU10	5/8" X 5/8" Tube Compression Tee	19.99



PARKER UNION CONNECTOR

PART NUMBER	PRODUCT DESCRIPTION	PRICE \$
P4UC4	1/4" X 1/4" Tube Compression Union	5.84
P5UC4	5/16" X 1/4" Tube Compression Union	7.74
P5UC5	5/16" X 5/16" Tube Compression Union	7.30
P6UC4	3/8" X 1/4" Tube Compression Union	7.44
P6UC5	3/8" X 5/16" Tube Compression Union	8.46
P6UC6	3/8" X 3/8" Tube Compression Union	7.26
P8UC6	1/2" X 3/8" Tube Compression Union	8.84
P8UC8	1/2" X 1/2" Tube Compression Union	8.96
P10UC6	5/8" X 3/8" Tube Compression Union	10.42
P10UC8	5/8" X 1/2" Tube Compression Union	10.86
P10UC10	5/8" X 5/8" Tube Compression Union	11.58



PARKER ELBOW UNION

PART NUMBER	PRODUCT DESCRIPTION	PRICE \$
P4EU4	1/4" X 1/4" Tube Comp Elbow Union	8.24
P5EU4	5/16" X 1/4" Tube Comp Elbow Union	14.14
P5EU5	5/16" X 5/16" Tube Comp Elbow Union	14.24
P6EU4	3/8" X 1/4" Tube Comp Elbow Union	12.60
P6EU5	3/8" X 5/16" Tube Comp Elbow Union	12.77
P6EU6	3/8" X 3/8" Tube Comp Elbow Union	10.54
P8EU6	1/2" X 3/8" Tube Comp Elbow Union	10.99
P8EU8	1/2" X 1/2" Tube Comp Elbow Union	12.86
P10EU10	5/8" X 5/8" Tube Comp Elbow Union	13.99



MEDICAL SOLUTIONS INTERNATIONAL
 5646 MERRIAM DRIVE
 MERRIAM, KS 66203
www.medicalsolutionskc.com

800.326.5275
 913.438.9700
 FAX 913.438.9701

MUR-LOK COMPRESSION TEE

PART NUMBER	PRODUCT DESCRIPTION	PRICE \$
ML-A0630405	3/8" Compression X 1/4" Female NPT	20.94
ML-A0630425	3/8" Compression X 1/4" ML	24.44
ML-A0630625	3/8" Compression X 3/8" ML	24.96
ML-A0630825	3/8" Compression X 1/2" ML	27.02
ML-A0830405	1/2" Compression X 1/4" Female NPT	20.94
ML-A0830425	1/2" Compression X 1/4" ML	24.44
ML-A0830625	1/2" Compression X 3/8" ML	24.96
ML-A0830825	1/2" Compression X 1/2" ML	27.02
ML-A1030405	5/8" Compression X 1/4" Female NPT	21.26
ML-A1030425	5/8" Compression X 1/4" ML	24.82
ML-A1030625	5/8" Compression X 3/8" ML	25.34
ML-A1030825	5/8" Compression X 1/2" ML	27.56



MUR-LOK IN-LINE BALL VALVES

PART NUMBER	PRODUCT DESCRIPTION	PRICE \$
ML-G0400405	1/4" Female NPT X 1/4" Female NPT	16.56
ML-G0400415	1/4" Female NPT X 1/4" Male NPT	16.56
ML-G0420405	1/4" ML X 1/4" Female NPT	22.04
ML-G0420415	1/4" ML X 1/4" Male NPT	14.25
ML-G0420425	1/4" ML X 1/4" ML	14.25
ML-G0420625	1/4" ML X 3/8" ML	14.38
ML-G0420825	1/4" ML X 1/2" ML	19.46
ML-G0600605	3/8" Female NPT X 3/8" Female NPT	17.78
ML-G0600615	3/8" Female NPT X 3/8" Male NPT	17.78
ML-G0620405	3/8" ML X 1/4" Female NPT	18.92
ML-G0620415	3/8" ML X 1/4" Male NPT	18.92
ML-G0620615	3/8" ML X 3/8" Male NPT	14.25
ML-G0620625	3/8" ML X 3/8" ML	14.25
ML-G0620825	3/8" ML X 1/2" ML	19.90
ML-G0820615	1/2" ML X 3/8" Male NPT	17.08
ML-G0820825	1/2" ML X 1/2" ML	17.78



MEDICAL SOLUTIONS INTERNATIONAL
 5646 MERRIAM DRIVE
 MERRIAM, KS 66203
www.medicalsolutionskc.com

800.326.5275
 913.438.9700
 FAX 913.438.9701

MURLOK MALE NPTF CONNECTORS

PART NUMBER	PRODUCT DESCRIPTION	PRICE \$
ML-O0420216	1/4" ML X 1/8" Male NPT	3.12
ML-O0420416	1/4" ML X 1/4" Male NPT	3.40
ML-O0420616	1/4" ML X 3/8" Male NPT	4.90
ML-O0520416	5/16" ML X 1/4" Male NPT	3.78
ML-O0620216	3/8" ML X 1/8" Male NPT	7.16
ML-O0620416	3/8" ML X 1/4" Male NPT	5.38
ML-O0620616	3/8" ML X 3/8" Male NPT	6.16
ML-O0620816	3/8" ML X 1/2" Male NPT	9.56
ML-O0820616	1/2" ML X 3/8" Male NPT	8.34
ML-O0820816	1/2" ML X 1/2" Male NPT	8.98



MUR-LOK FIXED NPTF ELBOWS

PART NUMBER	PRODUCT DESCRIPTION	PRICE \$
ML-P0420206	1/4" ML X 1/8" Female NPT	6.64
ML-P0420216	1/4" ML X 1/8" Male NPT	4.88
ML-P0420416	1/4" ML X 1/4" Male NPT	5.52
ML-P0420616	1/4" ML X 3/8" Male NPT	6.65
ML-P0520416	5/16" ML X 1/4" Male NPT	6.94
ML-P0620416	3/8" ML X 1/4" Male NPT	7.34
ML-P0620616	3/8" ML X 3/8" Male NPT	7.52



MUR-LOK UNION & REDUCING ELBOWS

PART NUMBER	PRODUCT DESCRIPTION	PRICE \$
ML-Q0420426	1/4" ML X 1/4" ML	5.52
ML-Q0520426	5/16" ML X 1/4" ML	7.06
ML-Q0520526	5/16" ML X 5/16" ML	6.38
ML-Q0620426	3/8" ML X 1/4" ML	9.18
ML-Q0620526	3/8" ML X 5/16" ML	9.18
ML-Q0620626	3/8" ML X 3/8" ML	8.34
ML-Q0820626	1/2" ML X 3/8" ML	10.84
ML-Q0820826	1/2" ML X 1/2" ML	9.90



MEDICAL SOLUTIONS INTERNATIONAL
 5646 MERRIAM DRIVE
 MERRIAM, KS 66203
www.medicalsolutionskc.com

800.326.5275
 913.438.9700
 FAX 913.438.9701

MUR-LOK FITTINGS

65

MUR-LOK REDUCERS

PART NUMBER	PRODUCT DESCRIPTION	PRICE \$
ML-S0420566	1/4" ML X 5/16" Stem	4.66
ML-S0420666	1/4" ML X 3/8" Stem	5.36
ML-S0520666	5/16" ML X 3/8" Stem	5.87
ML-S0620866	3/8" ML X 1/2" Stem	6.43



MUR-LOK NPTF STEM ADAPTERS

PART NUMBER	PRODUCT DESCRIPTION	PRICE \$
ML-S0460216	1/4" Stem X 1/8" Male NPT	1.98
ML-S0460416	1/4" Stem X 1/4" Male NPT	1.98
ML-S0660416	3/8" Stem X 1/4" Male NPT	3.12
ML-S0660616	3/8" Stem X 3/8" Male NPT	3.98
ML-S0860816	1/2" Stem X 1/2" Male NPT	4.34



MUR-LOK TUBE TO HOSE STEM ELBOWS

PART NUMBER	PRODUCT DESCRIPTION	PRICE \$
ML-S0460448	1/4" Stem X 1/4" BARB	3.98



MUR-LOK TUBE TO HOSE STEMS

PART NUMBER	PRODUCT DESCRIPTION	PRICE \$
ML-S0460446	1/4" Stem X 1/4" BARB	3.12
ML-S0660646	3/8" Stem X 3/8" BARB	4.88
ML-S0660846	3/8" Stem X 1/2" BARB	6.64
ML-S0860846	1/2" Stem X 1/2" BARB	6.48



MEDICAL SOLUTIONS INTERNATIONAL
 5646 MERRIAM DRIVE
 MERRIAM, KS 66203
www.medicalsolutionskc.com

800.326.5275
 913.438.9700
 FAX 913.438.9701

MUR-LOK FITTINGS-PLUG IN ELBOWS

PART NUMBER	PRODUCT DESCRIPTION	PRICE \$
ML-T0420466	1/4" ML X 1/4" Stem	4.96
ML-T0420666	1/4" ML X 3/8" Stem	6.72
ML-T0520566	5/16" ML X 5/16" Stem	7.46
ML-T0620666	3/8" ML X 3/8" Stem	8.52
ML-T0820866	1/2" ML X 1/2" Stem	10.18



MUR-LOK FITTINGS-UNION TEES

PART NUMBER	PRODUCT DESCRIPTION	PRICE \$
ML-V0420426	1/4" ML X 1/4" ML X 1/4" ML	6.92
ML-V0420526	1/4" ML X 1/4" ML X 5/16" ML	8.08
ML-V0520526	5/16" ML X 5/16" ML X 5/16" ML	7.26
ML-V0620426	3/8" ML X 3/8" ML X 1/4" ML	9.70
ML-V0620626	3/8" ML X 3/8" ML X 3/8" ML	6.32
ML-V0820426	1/2" ML X 1/2" ML X 1/4" ML	15.74
ML-V0820626	1/2" ML X 1/2" ML X 3/8" ML	8.86
ML-V0820826	1/2" ML X 1/2" ML X 1/2" ML	7.98
ML-V0820866	1/2" ML X 1/2" ML X 1/2" Stem	6.56



MUR-LOK FITTINGS-FEMALE CONNECTORS

PART NUMBER	PRODUCT DESCRIPTION	PRICE \$
ML-U0420206	1/4" ML X 1/8" Female NPTF	7.02
ML-U0420406	1/4" ML X 1/4" Female NPTF	7.62
ML-U0620406	3/8" ML X 1/4" Female NPTF	8.78



MEDICAL SOLUTIONS INTERNATIONAL
 5646 MERRIAM DRIVE
 MERRIAM, KS 66203
www.medicalsolutionskc.com

800.326.5275
 913.438.9700
 FAX 913.438.9701

NYLON GARDEN HOSE FITTINGS

PART NUMBER	PRODUCT DESCRIPTION	PRICE \$
GH-TVW7	"O" RING for Garden Hose Fitting	0.50
GH-TA772	3/4" Male Garden Hose X 1/4" Male NPT	4.44
GH-TA774	3/4" Male Garden Hose X 1/2" Male NPT	3.95
GH-TA776	3/4" Male Garden Hose X 3/4" Male NPT	4.05
GH-TA792	3/4" Male Garden Hose X 1/4" Female NPT	6.78
GH-TA793	3/4" Female Garden Hose X 3/8" Male NPT	5.10
GH-TCF72	3/4" Female Garden Hose X 1/4" Barb	7.61
GH-TCF73	3/4" Female Garden Hose X 3/8" Barb	7.61
GH-TCF76	3/4" Female Garden Hose X 3/4" Barb	8.79
GH-TCM72	3/4" Male Garden Hose X 1/4" Barb	4.93
GH-TCM73	3/4" Male Garden Hose X 3/8" Barb	3.95
GH-TTA-776	3/4" Female Garden Hose X 3/4" Male NPT	7.32



NYLON WALL STATION DRAIN BARBS

PART NUMBER	PRODUCT DESCRIPTION	PRICE \$
W-ATE2	Wallstation Drain Barb 1" Male NPT X 3/4" Barb Elbow	3.70
W-ATA1	Wallstation Drain Barb 1" Male NPT X 3/4" Barb Straight	3.22



MEDICAL SOLUTIONS INTERNATIONAL
 5646 MERRIAM DRIVE
 MERRIAM, KS 66203
www.medicalsolutionskc.com

800.326.5275
 913.438.9700
 FAX 913.438.9701

TANKS		
PART NUMBER	PRODUCT DESCRIPTION	PRICE \$
T-SSTA-120	120 Gallon stackable tank	QUOTE
T-ST220	220 Gallon stackable tank w/ colored base	QUOTE
T-ST225	225 Gallon stackable tank w/colored base	QUOTE
T-SSTA-240	240 Gallon stackable tank	QUOTE
T-ST330	330 Gallon stackable tank w/colored base	QUOTE
T-10250-B	250 Gallon Conical Bottom w/ Blue Base	QUOTE
T-10250-O	250 Gallon Conical Bottom w/ Orange Base	QUOTE
T-10250-R	250 Gallon Conical Bottom w/ Red Base	QUOTE
T-10250-Y	250 Gallon Conical Bottom w/ Yellow Base	QUOTE
T-10300	300 Gallon storage tank	QUOTE
T-10500-FB	500 Gallon storage tank flat bottom	QUOTE
T-10500-CB	500 Gallon storage tank conical bottom	QUOTE
T-VC-200	Ventilation Cap for square stackable tank	47.56



ALL FORMS OF TANKS ARE AVAILABLE, WE ARE PLEASED TO QUOTE CUSTOM ORDERS.



Medical Solutions

I N T E R N A T I O N A L

5646 Merriam Drive Merriam, Kansas 66203
913-438-9700 Fax 913-438-9701 800-326-5275
www.medicalsolutionskc.com

