



# Product Catalog

# 2026



**Medical Solutions**

I N T E R N A T I O N A L





Medical Solutions International has been privileged to serve the dialysis community since 1989. We designed and manufactured the first commercial Bicarbonate Mixing and Distribution System, the first commercial Acidified Distribution systems and the first dialysis specific commercial Patient Wall Station.

We have built our business on the faith and trust of our dialysis customers. Our innovative equipment designs were improved over the years by listening to our customers needs and performance expectations.

We will continue to strive to be innovative and reactive to our customers. Please feel free to contact us if you have an idea that you feel could be developed to better serve the dialysis community.



# TABLE OF CONTENTS

Call: 1-800-326-5275  
Available Monday thru  
Friday 8:00AM-4:00PM CST

**913-438-9700**

Email: [sales@medicalsolutionskc.com](mailto:sales@medicalsolutionskc.com)  
Customer support available  
Monday thru Friday 8:00AM-4:00pm CST

**Catalog also available on-line**  
[www.medicalsolutionskc.com](http://www.medicalsolutionskc.com)

<b>SDS-CB200 DUAL TANK BICARB SYSTEM</b>	<b>1</b>
<b>NEW PRODUCTS -RACK, BLEACH CAP, ETC</b>	<b>2</b>
<b>CITRIC JUG TEE, JUG CAP &amp; JUG TAP</b>	<b>3</b>
<b>ACID CABINET &amp; CHLORINE TIMER</b>	<b>4</b>
<b>MR. ACID</b>	<b>5</b>
<b>CRANK HOLDER/SAMPLE CENTER</b>	<b>6</b>
<b>OZONE ACCESSORIES</b>	<b>7</b>
<b>WALL TECH STATION</b>	<b>8-12</b>
<b>WALL TECH STATION ADAPTERS</b>	<b>13-16</b>
<b>CLEAR SCREEN PROTECTOR</b>	<b>17</b>
<b>BICARB SYSTEM ACCESSORIES</b>	<b>18-20</b>
<b>FUSES / SWITCHES / SENSORS</b>	<b>21</b>
<b>ELECTRICAL</b>	<b>22</b>
<b>PRESSURIZED PRODUCTS</b>	<b>23</b>
<b>CAMLOCKS / BANJO BULKHEAD</b>	<b>24</b>
<b>FILTERS</b>	<b>25</b>
<b>PUMPS</b>	<b>26-27</b>
<b>HOSE / CLAMPS / CLICS</b>	<b>28</b>
<b>TUBING</b>	<b>29</b>
<b>PVC SCHEDULE 80 FITTINGS</b>	<b>30-41</b>
<b>NIPPLES</b>	<b>42-44</b>
<b>BALL VALVES</b>	<b>45</b>
<b>CHECK VALVES / GATE VALVES</b>	<b>46</b>
<b>BARBED FITTINGS</b>	<b>47</b>
<b>QUICK DISCONNECT FITTINGS</b>	<b>48-59</b>
<b>PARKER FITTINGS</b>	<b>60-62</b>
<b>MUR-LOK</b>	<b>63-66</b>
<b>GARDEN HOSE FITTINGS</b>	<b>67</b>
<b>TANKS</b>	<b>68</b>
<b>ORDER FORM</b>	<b>69</b>

# Medical Solutions

INTERNATIONAL

## Bicarbonate Mixing & Distribution System



### Dual Tank Bicarbonate Mixing and Pressurized Distribution System

These systems have 25 to 100 gallon mixing capacity, with electronic fill and dispense options, variable batch size, internally balanced agitation, sanitization/disinfection mode, a .2 micron air filter, and timed cycle processing, they employ two 100 gallon tanks, one for mixing and one for distribution. With this system, you may effectively reconstitute dialysate powders in a closed system with a managed fill to accomplish predictable/reproducible batch quality.

The systems are designed for low volume, low pressure dynamic distribution of mixed Bicarb concentrate to patient stations. The systems lend themselves to simple, complete sanitization and effective rapid rinse. The system is

# SDS-CB200 DUAL TANK BICARBONATE MIXING & DISTRIBUTION 1

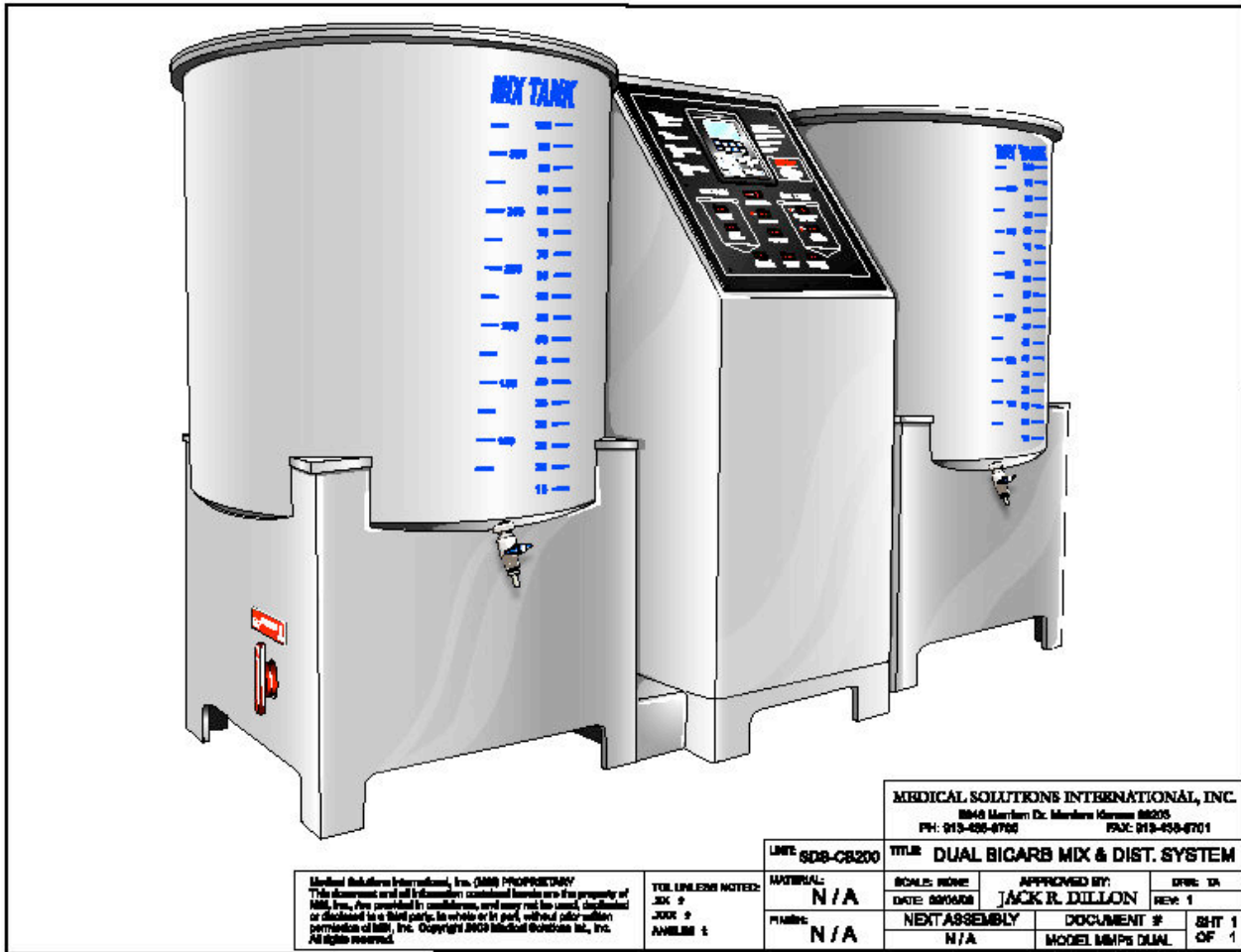

CALL FOR BICARBONATE SYSTEMS QUOTATIONS

ELECTRICAL CONTROL BOXES		
PART NUMBER	PRODUCT DESCRIPTION	PRICE \$
M-RA02	Bicarb Remote Alarm with Reset Mute	641.25



**MEDICAL SOLUTIONS INTERNATIONAL**  
 5646 MERRIAM DRIVE  
 MERRIAM, KS 66203  
[www.medicalsolutionskc.com](http://www.medicalsolutionskc.com)

800.326.5275  
 913.438.9700  
 FAX K

## We Create Solutions

THE PROBLEM...



Your Bottle...  
No Stand...  
Your Mess...

THE SOLUTION...



Your Bottle...  
Our Stand... CCS-1  
No Mess...

But Wait, Theres More



Your Bottle...  
Our Stand... CCS-1  
Plus our "Y"  
Connector... CAF-4

### CitruClean Stand

"It Just Keeps Getting Better"



medicalsolutionskc.com 800-326-5275

## Wand Drying Rack

**CBM-DR-1**  
Wand Drying Rack



medicalsolutionskc.com 800-326-5275

## PROTECT YOUR SWITCHES

We have all experienced a PANIC Sam call when a machine won't come up!!!  
Avoid early calls because housekeeping turned off a switch when moving a machine.  
Protect the switch, Protects your sleep! Try this easy see through cover!



medicalsolutionskc.com 800-326-5275, 913-438-9700

## DRAIN HOSE CONTROL FOR ACUTE TREATMENT

Butterfly Hose Holder

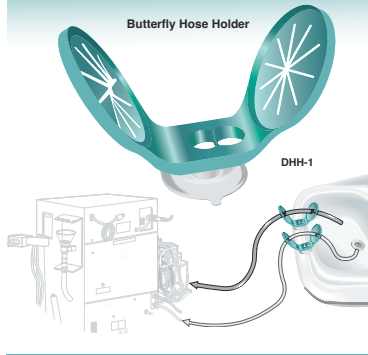

medicalsolutionskc.com 800-326-5275

## Bleach Cap

Cap Only  
(Jar not included)



medicalsolutionskc.com 800-326-5275

## End to End Cleaning Device

For Acute Dialysis Machines

Dialysis Machine  
Dram line  
connections

Wheels on back  
for easy relocation

Dialysis machine  
feed line connection

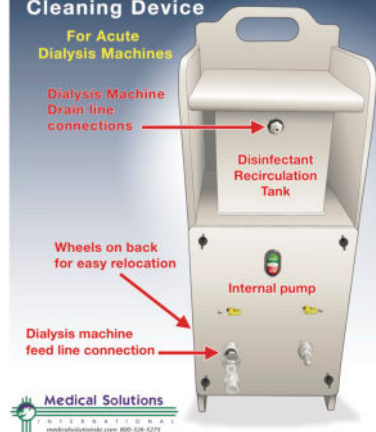

## NEW PRODUCTS

PART NUMBER	PRODUCT DESCRIPTION	PRICE \$
CBM-DR-1	Wand Drying Rack	29.95
SP-VD100	Switch Protector	11.70
DHH-1	Butterfly Hose Holder	12.90
CCS-1	CitruClean Stand	14.95
K-FRE-BC	Bleach Cap-All Plastic	26.60
K-FRE-BOTTLE	500 ml Bottle (cap not included)	14.06
M-PTD	Pressure Testing Device	843.25
CND-010	Concentrate Neutralization/Disposal System	
M-ETED	End to End Disinfection Cart	1,498.78



**MEDICAL SOLUTIONS INTERNATIONAL**  
5646 MERRIAM DRIVE  
MERRIAM, KS 66203  
[www.medicalsolutionskc.com](http://www.medicalsolutionskc.com)

800.326.5275  
913.438.9700  
FAX 913.438.9701

# JUG CAPS, TAPS & TEES

## Red Jug Cap

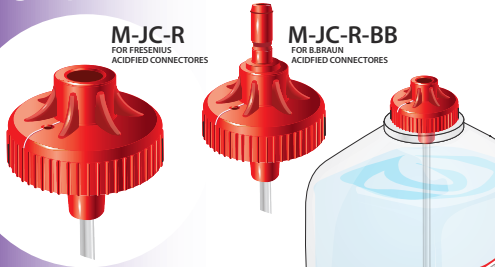

## Blue Jug Cap

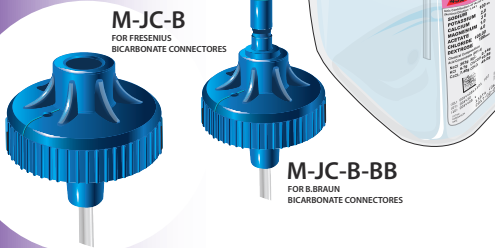

"Clean, Neat, No Mess".



medicalsolutionskc.com 800-326-5275

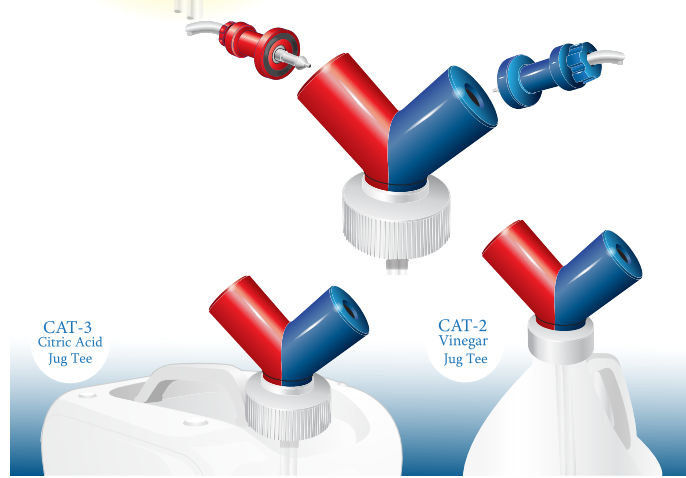

medicalsolutionskc.com 800-326-5275

## Red Jug Tap

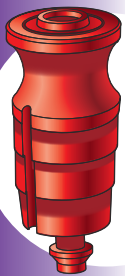

## Blue Jug Tap



"Clean, Neat, No Mess".



## JUG CAP, TAP & TEES

PART NUMBER	PRODUCT DESCRIPTION	PRICE \$
CAT-3	Citric Acid Jug Tee	49.20
CAT-2	Vinegar Jug Tee	49.20
M-JC-R	Red Acid Jug Cap (Fresenius)	24.95
M-JC-B	Blue Bicarb Jug Cap (Fresenius)	24.95
M-JC-R-BB	Red Acid Cap (BBraun)	26.60
M-JC-B-BB	Blue Bicarb Cap (BBraun)	26.60
M-JT-R	Red Acid Jug Tap (Fresenius)	25.50
M-JT-B	Blue Bicarb Jug Tap (Fresenius)	25.50

MEDICAL SOLUTIONS INTERNATIONAL  
5646 MERRIAM DRIVE  
MERRIAM, KS 66203  
[www.medicalsolutionskc.com](http://www.medicalsolutionskc.com)

800.326.5275  
913.438.9700  
FAX 913.438.9701

## MEDICAL SOLUTIONS INTERNATIONAL



### ACIDIFIED CONCENTRATE DISTRIBUTION SYSTEM

We use all corrosion resistant materials as well as FDA registered process piping, tanks, controls, etc. The system is designed to transfer acidified concentrate from bulk storage to the patient stations by controlled low pressure pump. The system consists of transfer pumps, valves, fittings, and a complete electronic control. Includes pressurized jug fill.

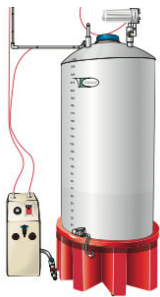

"It won't let you forget".

Chlorine timer

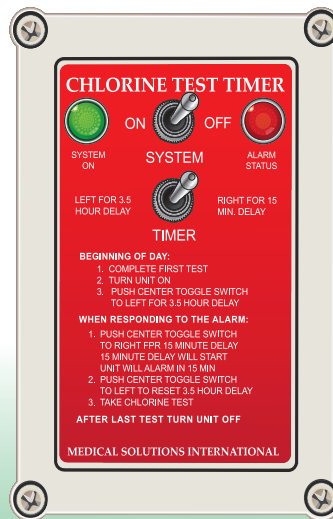

M-CT02

Remote Alarm

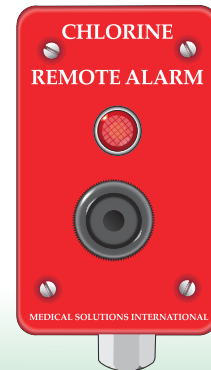

M-RA03



medicalsolutionskc.com 800-326-5275

## ACIDIFIED DISTRIBUTION AND CHLORINE TIMER/REMOTE

PART NUMBER	PRODUCT DESCRIPTION	PRICE \$
APDS-CAB3	Acidified Distribution Cabinet	3136.50
M-CT02	Chlorine Timer	806.06
M-RA03	Remote Alarm for Chlorine Timer	129.95

MEDICAL SOLUTIONS INTERNATIONAL  
 5646 MERRIAM DRIVE  
 MERRIAM, KS 66203  
[www.medicalsolutionskc.com](http://www.medicalsolutionskc.com)

800.326.5275  
 913.438.9700  
 FAX 913.438.9701



# MR. ACID

If They Want You To Fill Jugs The Old Way...  
**JUST SAY NO!**



*This Is Just Too Easy!  
Automatic Jug Filling!  
Clean, Spill Free, Easy*

***Shuts Itself Off When Full...***

Just place the jug, push the button, walk away... Mr. Acid! Will fill the jug and automatically shut off when full. Mr. Acid! Works on any dialysis machine ug and works with any acidified concentrate or with bicarb.

Mr. Acid! Is clean, spill free and easy. No more slick dangerous floors. No more spilling and sliding. No more ruined shoes and floors.

This system is made to fit right on the acid drum or can be ordered for carts to fill from bulk storage tanks.

This Patent Applied For

**ADU-55**



medicalsolutionskc.com 800-326-5275

## MR. ACID

PART NUMBER	PRODUCT DESCRIPTION	PRICE \$
M-ADU-55	Mr. Acid	1851.24
M-A-DW01	Mr. Acid Drum Wand	45.92



**MEDICAL SOLUTIONS INTERNATIONAL**  
5646 MERRIAM DRIVE  
MERRIAM, KS 66203  
[www.medicalsolutionskc.com](http://www.medicalsolutionskc.com)

800.326.5275  
913.438.9700  
FAX 913.438.9701

## SAMPLE — CENTER

- EASY
- SIMPLE
- CONVENIENT
- CLEAN

STORE YOUR TESTING EQUIPMENT  
CONVENIENTLY AWAY...

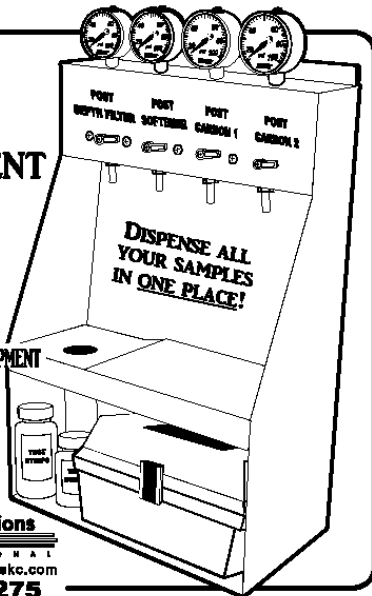

**Medical Solutions**  
INTERNATIONAL  
www.medicalsolutionskc.com  
800-326-5275

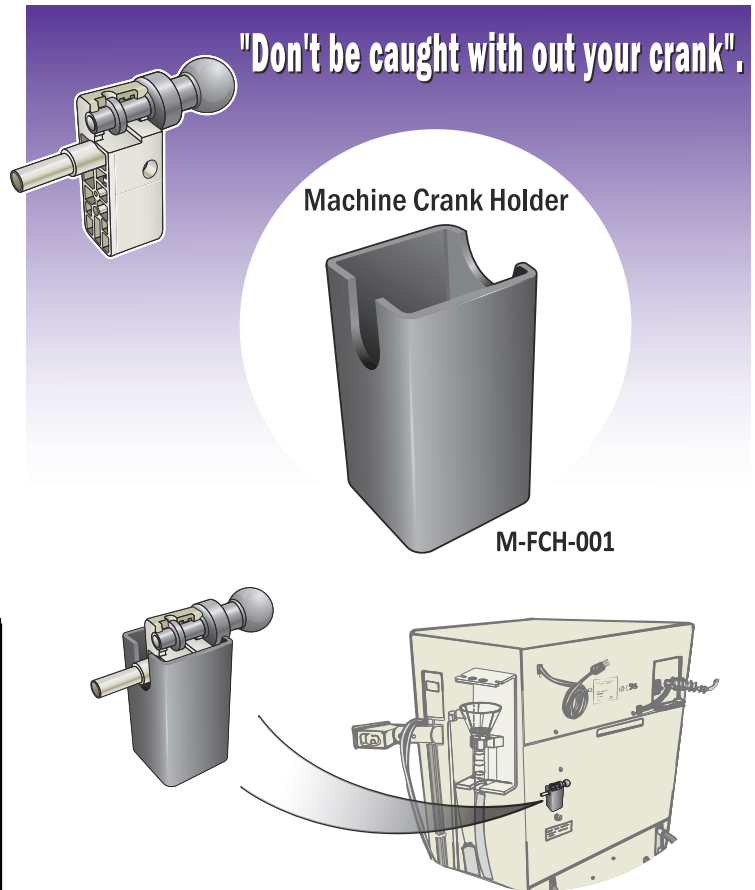

**Medical Solutions**  
INTERNATIONAL

medicalsolutionskc.com 800-326-5275

### SAMPLE STATION

PART NUMBER	PRODUCT DESCRIPTION	PRICE \$
M-FCH-001	Machine Crank Holder	11.94
SS-101	Pre-Treatment Sample Station w/out Gauges	636.40
SS-101-PG	Pre-Treatment Sample Station w/ Gauges	985.25

MEDICAL SOLUTIONS INTERNATIONAL  
5646 MERRIAM DRIVE  
MERRIAM, KS 66203  
[www.medicalsolutionskc.com](http://www.medicalsolutionskc.com)

800.326.5275  
913.438.9700  
FAX 913.438.9701



Z-C30ZX

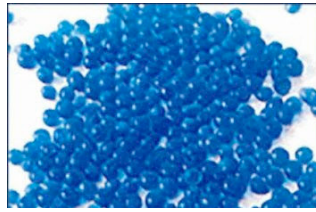

O3-DRF-8



BEFORE AFTER



O3-T



PART NUMBER	PRODUCT DESCRIPTION	PRICE \$
O3-DRF-H1	Ozone Dessicant Filter Housing	39.95
O3-DRF-8	Ozone Air Drying Dessicant Refill	11.91
Z-C-30ZX	Ozone Ambient Air Monitor	952.5
Z-CX01	Exchange Cell for Ozone Unit	269.98
O3-T	Test Strips for Ozone (1 Bottle)	29.95
CV-14000	1/4" Check Valve	24.46

MEDICAL SOLUTIONS INTERNATIONAL  
 5646 MERRIAM DRIVE  
 MERRIAM, KS 66203  
[www.medicalsolutionskc.com](http://www.medicalsolutionskc.com)

800.326.5275  
 913.438.9700  
 FAX 913.438.9701

# WALL TECH DRAIN ISOLATION STATIONS 8

## Drain Isolation Wall Station

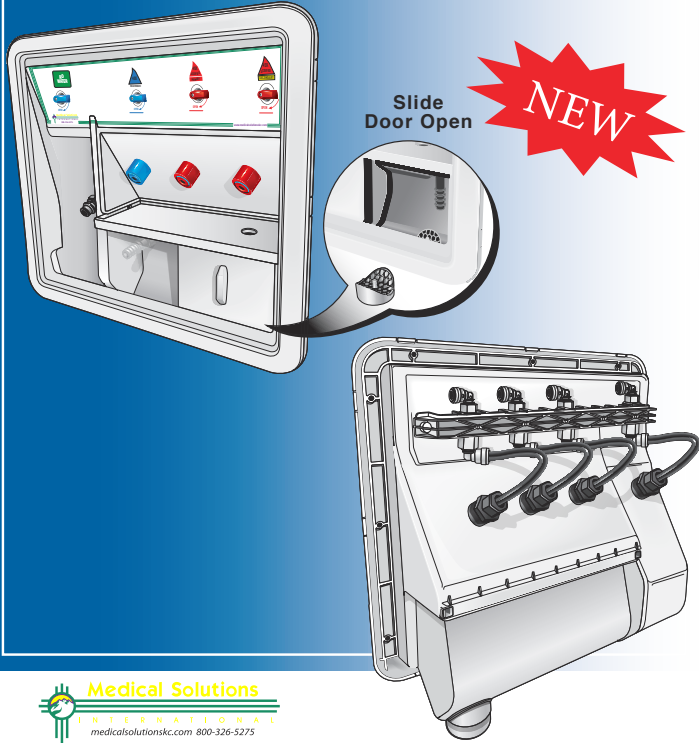

**Medical Solutions**  
INTERNATIONAL  
medicalsolutionskc.com 800-326-5275

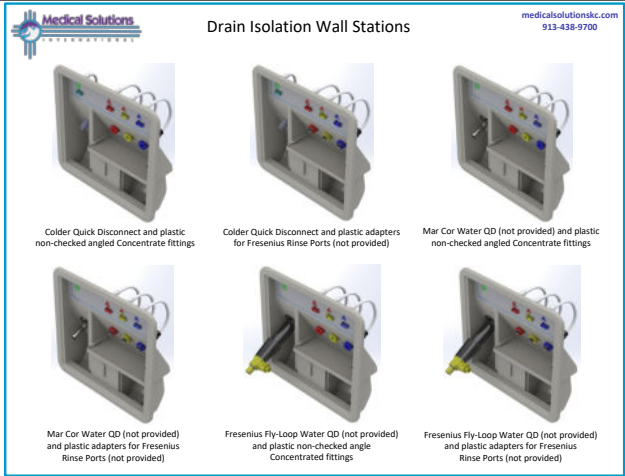

ADAPTERS		
PART NUMBER	PRODUCT DESCRIPTION	PRICE \$
W-FRE-AAP-B	Blue Angled All Plastic Fresenius Checkless Housing and Jam Nut	\$18.76
W-FRE-AAP-O	Orange Angled All Plastic Fresenius Checkless Housing and Jam Nut	\$18.76
W-FRE-AAP-R	Red Angled All Plastic Fresenius Checkless Housing and Jam Nut	\$18.76
W-FRE-AAP-Y	Yellow Angled All Plastic Fresenius Checkless Housing and Jam Nut	\$18.76
W-FRE-ARB-B	Blue Angled All Plastic Fresenius Housing and Jam Nut	\$18.76
W-FRE-ARB-R	Red Angled All Plastic Fresenius Housing and Jam Nut	\$18.76
W-FRE-ARB-Y	Yellow Angled All Plastic Fresenius Housing and Jam Nut	\$18.76

**CALL FOR PRICING ON NEW WALLSTATION,  
MULTIPLE CONFIGURATIONS TO MEET YOUR NEEDS!**

MEDICAL SOLUTIONS INTERNATIONAL  
5646 MERRIAM DRIVE  
MERRIAM, KS 66203  
[www.medicalsolutionskc.com](http://www.medicalsolutionskc.com)

800.326.5275  
913.438.9700  
FAX 913.438.9701

## Medical Solutions International



### Wall Station for Dialysis

Our recessed dialysis wall stations include a solutions distribution carrier and drain. Each is 18" wide by 18" high, and made of high quality molded polyethylene. The durable material can be fitted with a variety of valves, fittings, pressure gauges and quick connects so as to accommodate the installation of compatible dispensing with any dialysis delivery system on the market today. The easily cleaned, chemical resistant wall station also receives the drainage from the dialysis machine. The drip-proof cantilever valve block keeps the unit free of spills and stains. All valving is color coded and signage designated.

- A. P6FC8
- B. ML-T0620666
- C. ML-G0620625
- D. W-M11X4 (4 SLOT MANIFOLD)
- E. W-FRE-850 (RED, BLUE, YELLOW, WHITE)
- F. QD-HFCD24812
- G. QD-HFCD101235GHT
- H. HM001(BLUE, RED, GREEN, ORANGE, YELLOW)
- I. W-CNC-AGD (AIR GAP DRAIN ASSEMBLY)

NOTE:  
TUBING (NOT SHOWN) RUNS FROM  
G3 TO G6, TYPICAL 4 PLACES.

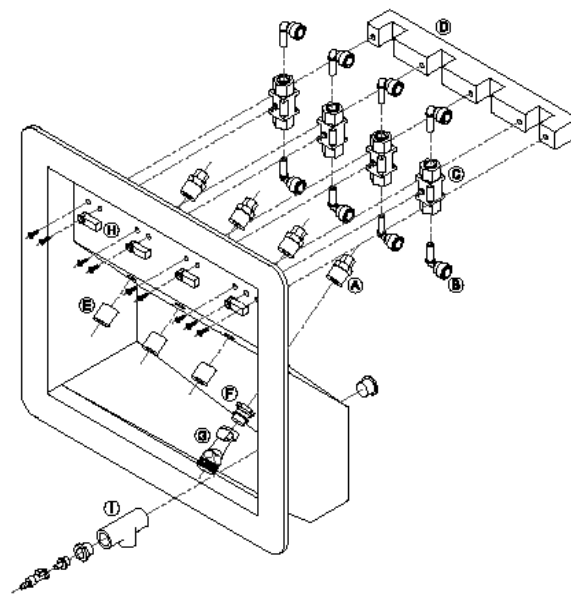

MEDICAL SOLUTIONS INTERNATIONAL  
5646 MERRIAM DRIVE  
MERRIAM, KS 66203  
[www.medicalsolutionskc.com](http://www.medicalsolutionskc.com)

800.326.5275  
913.438.9700  
FAX 913.438.9701

# WALL TECH STATIONS-BEIGE

10

## BEIGE WALL STATIONS

PART NUMBER	PRODUCT DESCRIPTION	PRICE \$
W-RPWS-B000	Beige Wallstation Blank	214.65
W-RPWS-B012	Beige Wallstation with 1 Bicarb and 2 Acid Fittings	389.14
W-RPWS-B100	Beige Wallstation with 1 Water Fitting	324.56
W-RPWS-B101	Beige Wallstation with 1 Water and 1 Acid Fitting	336.96
W-RPWS-B102	Beige Wallstation with 1 Water and 2 Acid Fittings	389.14
W-RPWS-B103	Beige Wallstation with 1 Water and 3 Acid Fittings	443.88
W-RPWS-B104	Beige Wallstation with 1 Water and 4 Acid Fittings	497.81
W-RPWS-B111	Beige Wallstation with 1 Water, 1 Bicarb and 1 Acid Fitting	389.95
W-RPWS-B112	Beige Wallstation with 1 Water, 1 Bicarb and 2 Acid Fittings	443.88
W-RPWS-B113	Beige Wallstation with 1 Water, 1 Bicarb and 3 Acid Fittings	497.81
W-RPWS-B114	Beige Wallstation with 1 Water, 1 Bicarb and 4 Acid Fittings	551.75
W-RPWS-B200	Beige Wallstation with 2 Water Fittings	350.86
W-RPWS-B202	Beige Wallstation with 2 Water and 2 Acid Fittings	457.38
W-RPWS-B212	Beige Wallstation with 2 Water, 1 Bicarb and 2 Acid Fittings	478.58
W-RPWS-B222	Beige Wallstation with 2 Water, 2 Bicarb and 2 Acid Fittings	565.25
W-RPWS-B300	Beige Wallstation with 3 Water Fittings	416.95
W-RPWS-B400	Beige Wallstation with 4 Water Fittings	443.88

REFER TO PAGE 9

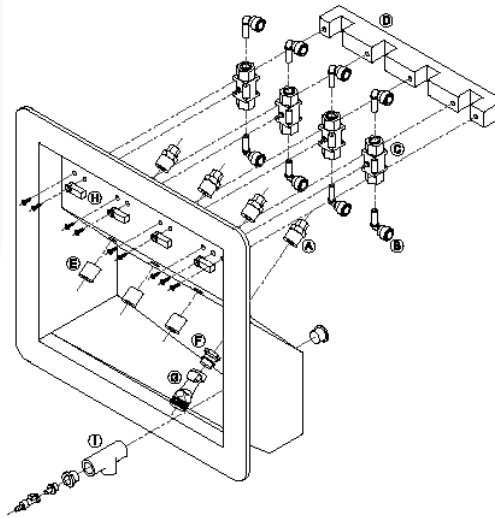

MEDICAL SOLUTIONS INTERNATIONAL  
 5646 MERRIAM DRIVE  
 MERRIAM, KS 66203  
[www.medicalsolutionskc.com](http://www.medicalsolutionskc.com)

800.326.5275  
 913.438.9700  
 FAX 913.438.9701

# WALL TECH STATIONS-GRAY

11

## GRAY WALL STATIONS

PART NUMBER	PRODUCT DESCRIPTION	PRICE \$
W-RPWS-G000	Gray Wallstation Blank	214.65
W-RPWS-G012	Gray Wallstation with 1 Bicarb and 2 Acid Fittings	389.14
W-RPWS-G100	Gray Wallstation with 1 Water Fitting	324.56
W-RPWS-G101	Gray Wallstation with 1 Water and 1 Acid Fitting	336.96
W-RPWS-G102	Gray Wallstation with 1 Water and 2 Acid Fittings	389.95
W-RPWS-G103	Gray Wallstation with 1 Water and 3 Acid Fittings	443.88
W-RPWS-G104	Gray Wallstation with 1 Water and 4 Acid Fittings	497.81
W-RPWS-G111	Gray Wallstation with 1 Water, 1 Bicarb and 1 Acid Fitting	389.95
W-RPWS-G112	Gray Wallstation with 1 Water, 1 Bicarb and 2 Acid Fittings	443.88
W-RPWS-G113	Gray Wallstation with 1 Water, 1 Bicarb and 3 Acid Fittings	497.81
W-RPWS-G114	Gray Wallstation with 1 Water, 1 Bicarb and 4 Acid Fittings	551.75
W-RPWS-G200	Gray Wallstation with 2 Water Fittings	350.86
W-RPWS-G202	Gray Wallstation with 2 Water and 2 Acid Fittings	457.38
W-RPWS-G212	Gray Wallstation with 2 Water, 1 Bicarb and 2 Acid Fittings	478.58
W-RPWS-G222	Gray Wallstation with 2 Water, 2 Bicarb and 2 Acid Fittings	565.24
W-RPWS-G300	Gray Wallstation with 3 Water Fittings	416.95
W-RPWS-G400	Gray Wallstation with 4 Water Fittings	443.88

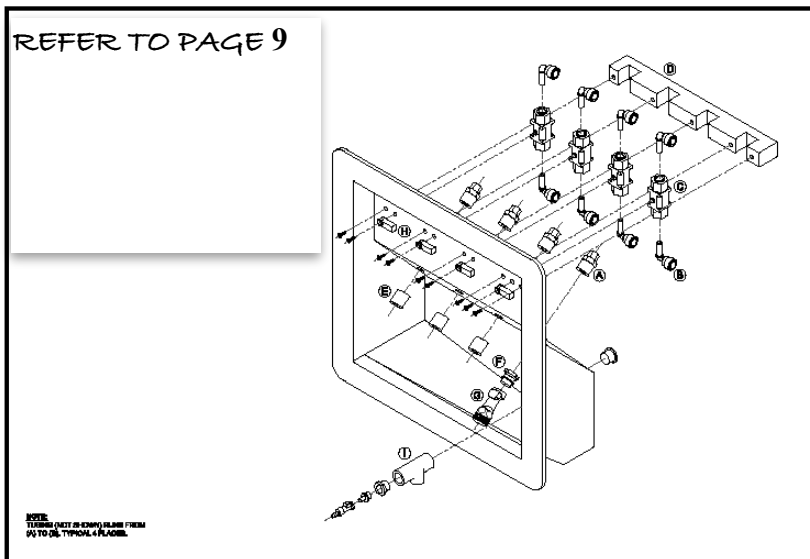

MEDICAL SOLUTIONS INTERNATIONAL  
 5646 MERRIAM DRIVE  
 MERRIAM, KS 66203  
[www.medicalsolutionskc.com](http://www.medicalsolutionskc.com)

800.326.5275  
 913.438.9700  
 FAX 913.438.9701

**WHITE WALL STATIONS**

PART NUMBER	PRODUCT DESCRIPTION	PRICE \$
W-RPWS-W000	White Wallstation Blank	214.65
W-RPWS-W100	White Wallstation with 1 Water Fitting	324.56
W-RPWS-W101	White Wallstation with 1 Water and 1 Acid Fitting	336.96
W-RPWS-W102	White Wallstation with 1 Water and 2 Acid Fittings	389.95
W-RPWS-W103	White Wallstation with 1 Water and 3 Acid Fittings	443.88
W-RPWS-W111	White Wallstation with 1 Water, 1 Bicarb and 1 Acid Fitting	389.95
W-RPWS-W112	White Wallstation with 1 Water, 1 Bicarb and 2 Acid Fittings	443.88
W-RPWS-W113	White Wallstation with 1 Water, 1 Bicarb and 3 Acid Fittings	497.81
W-RPWS-W114	White Wallstation with 1 Water, 1 Bicarb and 4 Acid Fittings	551.75
W-RPWS-W200	White Wallstation with 2 Water Fittings	349.52
W-RPWS-W202	White Wallstation with 2 Water and 2 Acid Fittings	457.38
W-RPWS-W212	White Wallstation with 2 Water, 1 Bicarb and 2 Acid Fittings	478.58
W-RPWS-W222	White Wallstation with 2 Water, 2 Bicarb and 2 Acid Fittings	565.24
W-RPWS-W300	Gray Wallstation with 3 Water Fittings	416.95
W-RPWS-W400	Gray Wallstation with 4 Water Fittings	443.88

**SMALL WHITE WALL STATIONS**

PART NUMBER	PRODUCT DESCRIPTION	PRICE \$
W-RPWS-SW000	Small White Wallstation Blank	214.65
W-RPWS-SW00AG	Small White Wallstation with Air Gap Drain Assembly	244.60
W-RPWS-SW100	Small White Wallstation with 1 Water Fitting	324.56
W-RPWS-SW102	Small White Wallstation with 1 Water and 2 Acid Fittings	389.95
W-RPWS-SW110	Small White Wallstation with 1 Water and 1 Bicarb Fitting	336.96
W-RPWS-SW111	Small White Wallstation with 1 Water, 1 Bicarb and 1 Acid Fitting	389.95
W-RPWS-SW112	Small White Wallstation with 1 Water, 1 Bicarb and 2 Acid Fittings	443.88
W-RPWS-SW200	Small White Wallstation with 2 Water Fittings	348.97

**MEDICAL SOLUTIONS INTERNATIONAL**  
5646 MERRIAM DRIVE  
MERRIAM, KS 66203  
[www.medicalsolutionskc.com](http://www.medicalsolutionskc.com)

800.326.5275  
913.438.9700  
FAX 913.438.9701

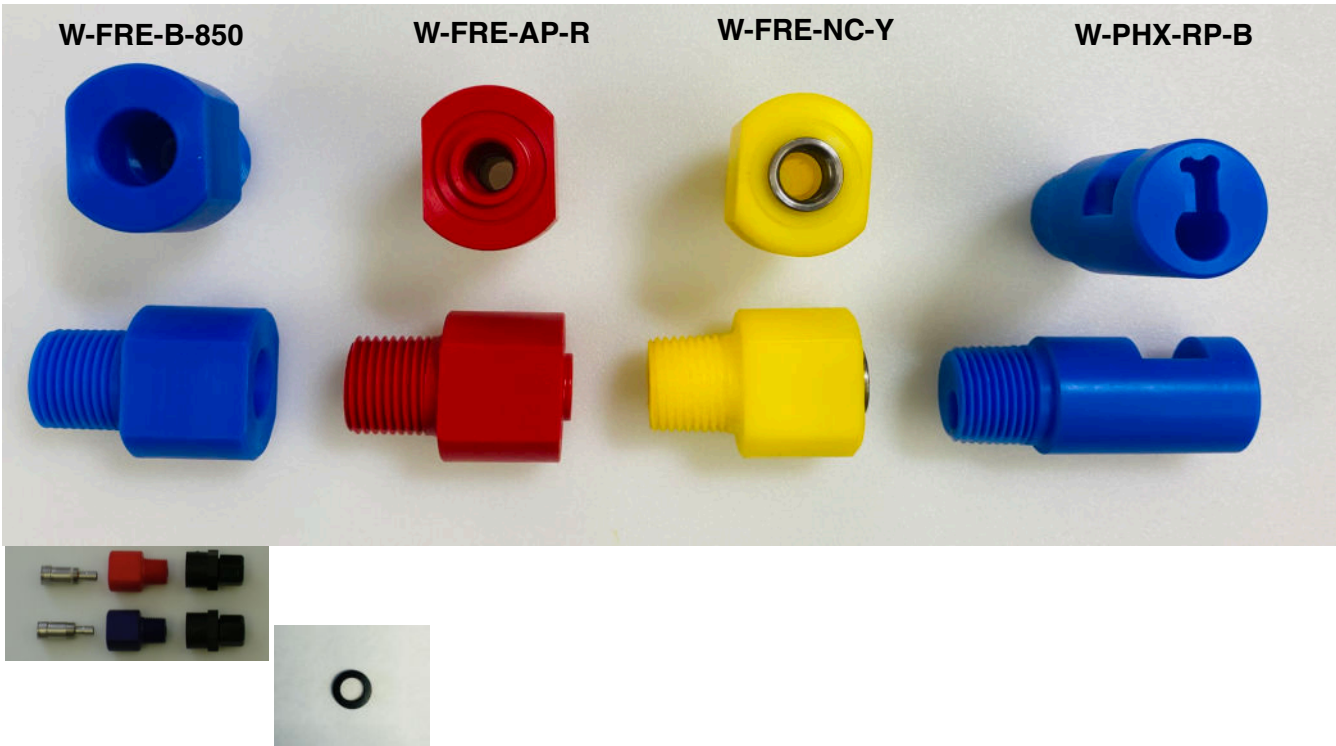

ADAPTERS		
PART NUMBER	PRODUCT DESCRIPTION	PRICE \$
W-FRE-R-850	Red 1/2" Male NPT X Fresenius Reducer Bushing	16.50
W-FRE-B-850	Blue 1/2" Male NPT X Fresenius Reducer Bushing	16.50
W-FRE-W-850	White 1/2" Male NPT X Fresenius Reducer Bushing	16.50
W-FRE-AP-R	Red All Plastic Checkless Fresenius Reducer Bushing	22.46
W-FRE-AP-B	Blue All Plastic Checkless Fresenius Reducer Bushing	22.46
W-FRE-NC-R	Red Checkless Male NPT X Fresenius Reducer Bushing w/SS Ring	33.95
W-FRE-NC-B	Blue Checkless Male NPT X Fresenius Reducer Bushing w/SS Ring	33.95
W-PHX-RP-R	Red Phoenix Rinse Port	29.95
W-PHX-RP-B	Blue Phoenix Rinse Port	29.95
W-PHX-RP-W	White Phoenix Rinse Port	29.95
W-FRE-RS	Rubber Seal for Fresenius Rinse Port for W-FRE-850's	1.10

MEDICAL SOLUTIONS INTERNATIONAL  
 5646 MERRIAM DRIVE  
 MERRIAM, KS 66203  
[www.medicalsolutionskc.com](http://www.medicalsolutionskc.com)

800.326.5275  
 913.438.9700  
 FAX 913.438.9701

# WALL TECH STATION ADAPTERS

14

## ITEMS FOR ADAPTING FRESENIUS FITTINGS

PART NUMBER	PRODUCT DESCRIPTION	PRICE \$
W-FRE-W5-B	Fresenius Assembly Washer Blue	0.78
W-FRE-W5-R	Fresenius Assembly Washer Red	0.78
W-FRE-W5-W	Fresenius Assembly Washer White	0.78
W-FRE-W5-Y	Fresenius Assembly Washer Yellow	0.78
W-FRE-W.50	Fresenius Bushing Spacer White	0.38

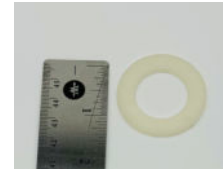

## WALL STATION VALVE HANDLES

PART NUMBER	PRODUCT DESCRIPTION	PRICE \$
HB001	Blue Handle SMC	1.69
HR001	Red Handle SMC	1.69
HC001	Clear Handle SMC	1.69
HG001	Gray Handle SMC	1.69
HGR001	Green Handle SMC	1.69
HBL001	Black Handle SMC	1.69
HMB001	Blue Handle Murlock	1.69
HMBL001	Black Handle Murlock	1.69
HMR001	Red Handle Murlock	1.69
HMO001	Orange Handle Murlock	1.69
HMY001	Yellow Handle Murlock	1.69
HMGR001	Green Handle Murlock	1.69
HPY001	Yellow Parker Ballvalve Handle	3.94



HANDLES IN SMC



HANDLES IN MURDOCK



## WALL STATION NYLON DRAIN BARBS

PART NUMBER	PRODUCT DESCRIPTION	PRICE \$
W-ATE2	Wallstation Drain 1" MNPT X 3/4" Barb Elbow	3.90
W-ATA1	Wallstation Drain 1" MNPT X 3/4" Barb Straight	3.22
436-133	Wallstation Drain 1" MNPT X 1-1/2" Socket Schedule 40	8.18

MEDICAL SOLUTIONS INTERNATIONAL  
 5646 MERRIAM DRIVE  
 MERRIAM, KS 66203

[www.medicalsolutionskc.com](http://www.medicalsolutionskc.com)

800.326.5275  
 913.438.9700  
 FAX 913.438.9701

# WALL TECH STATION ITEMS

15

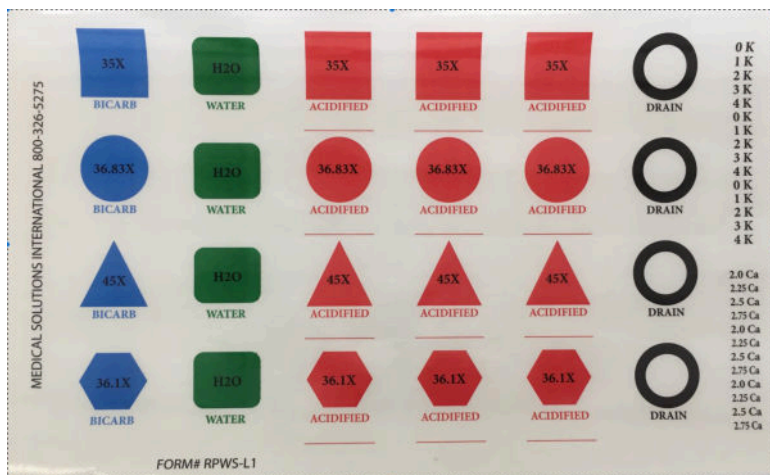

## WALL STATION ITEMS

PART NUMBER	PRODUCT DESCRIPTION	PRICE \$
W-RPWS-L1	Labels for Recessed Patient Wallstation	1.65
P6FC8	3/8" Tube Compression X 1/2" Male NPT	8.82
P-OR.6	"O"RING for P6FC8 3/8" Tube Compression	0.54
QD-HFCD101235GHT	3/4" MGHT PSF Inline coupling insert w/Shut-off	38.90
QD-HFCD24812	1/2" MNPT PP Inline coupling insert w/Shut-off	25.42
O-RING-WTR	"O" RING for Water Male QD-HFCD24812	0.34
W-ATE2	Wallstation Drain 1" MNPT X 3/4" Barb Elbow	3.90
W-ATA1	Wallstation Drain 1" MNPT X 3/4" Barb Straight	3.22
436-133	Wallstation Drain 1" MNPT x 1 1/2" Socket Schedule 40	8.18
W-M11X1	1 Slot Manifold for Wallstation	10.98
W-M11X2	2 Slot Manifold for Wallstation	12.96
W-M11X3	3 Slot Manifold for Wallstation	15.76
W-M11X4	4 Slot Manifold for Wallstation	26.81
W-M11X6	6 Slot Manifold for Wallstation	28.79

MEDICAL SOLUTIONS INTERNATIONAL  
 5646 MERRIAM DRIVE  
 MERRIAM, KS 66203  
[www.medicalsolutionskc.com](http://www.medicalsolutionskc.com)

800.326.5275  
 913.438.9700  
 FAX 913.438.9701

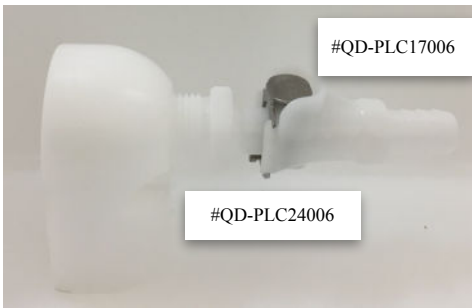

# W-CNC-AGD- AIR GAP DRAIN ASSEMBLY



# W-CNC-CAS

# W-PL-TAGDT DIAGRAM

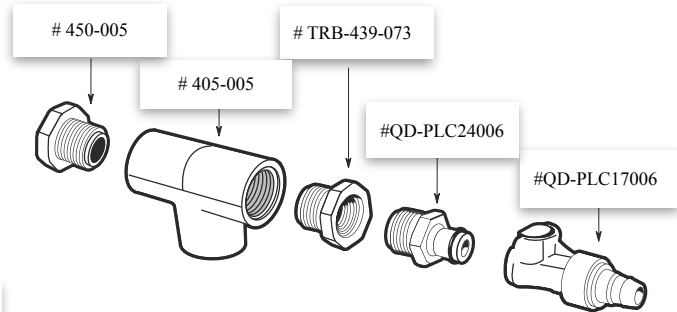

## AIR GAP DRAIN ASSEMBLY

PART NUMBER	PRODUCT DESCRIPTION	PRICE \$
W-CNC-AGD	Air Gap Drain Assembly	32.70
W-CNC-CAS	Air Gap Body	19.98
W-PL-TAGD	Tee Style Sch 40 Air Gap Drain Assembly	53.30
W-PL-TAGDT	Threaded Tee Style Sch 40 Air Gap Drain Assembly	29.95

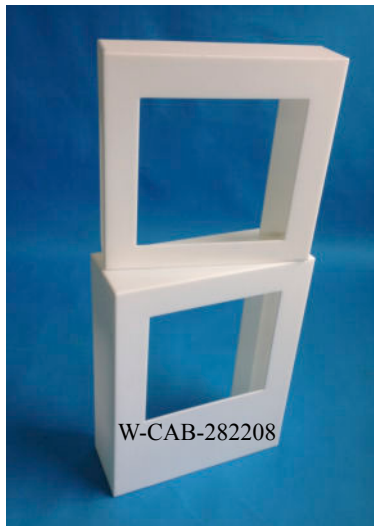

## WALL STATION CABINET

PART NUMBER	PRODUCT DESCRIPTION	PRICE \$
W-CAB-282208	Custom Wall Mounting Chase for RPWS (White)	495.25

MEDICAL SOLUTIONS INTERNATIONAL  
 5646 MERRIAM DRIVE  
 MERRIAM, KS 66203  
[www.medicalsolutionskc.com](http://www.medicalsolutionskc.com)

800.326.5275  
 913.438.9700  
 FAX 913.438.9701

## CLEAR SCREEN Protection

Protect your new monitor.... Refurbish your old....

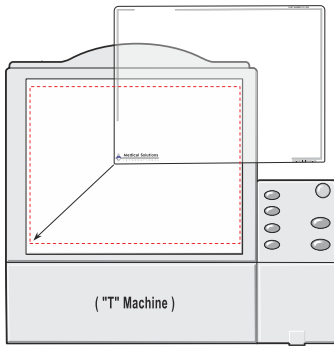

Clear Screen for T Machine

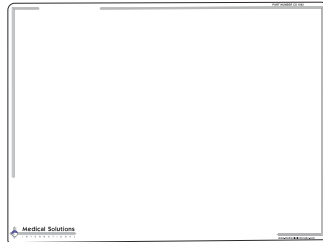

CS1002

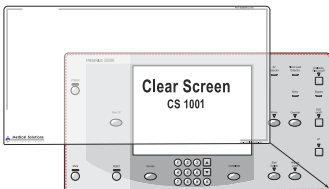

Fresenius 2008K

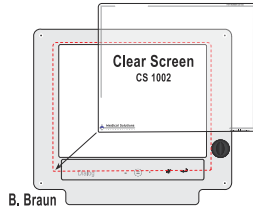

B. Braun

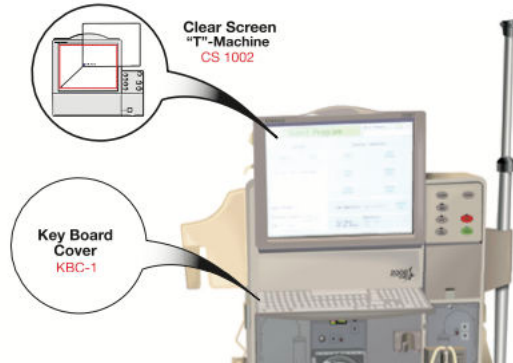

"Save your "T" screen".

"Stops cloudy screens".



medicalsolutionskc.com 800-326-5275



### CLEAR SCREENS AND KEYBOARD COVER

PART NUMBER	PRODUCT DESCRIPTION	PRICE \$
CS1002	CLEAR SCREEN T MACHINE	19.95
CS1001	CLEAR SCREEN 2008K	19.95
KBC-1	KEYBOARD COVER T MACHINE	35.56

MEDICAL SOLUTIONS INTERNATIONAL  
5646 MERRIAM DRIVE  
MERRIAM, KS 66203  
[www.medicalsolutionskc.com](http://www.medicalsolutionskc.com)

800.326.5275  
913.438.9700  
FAX 913.438.9701

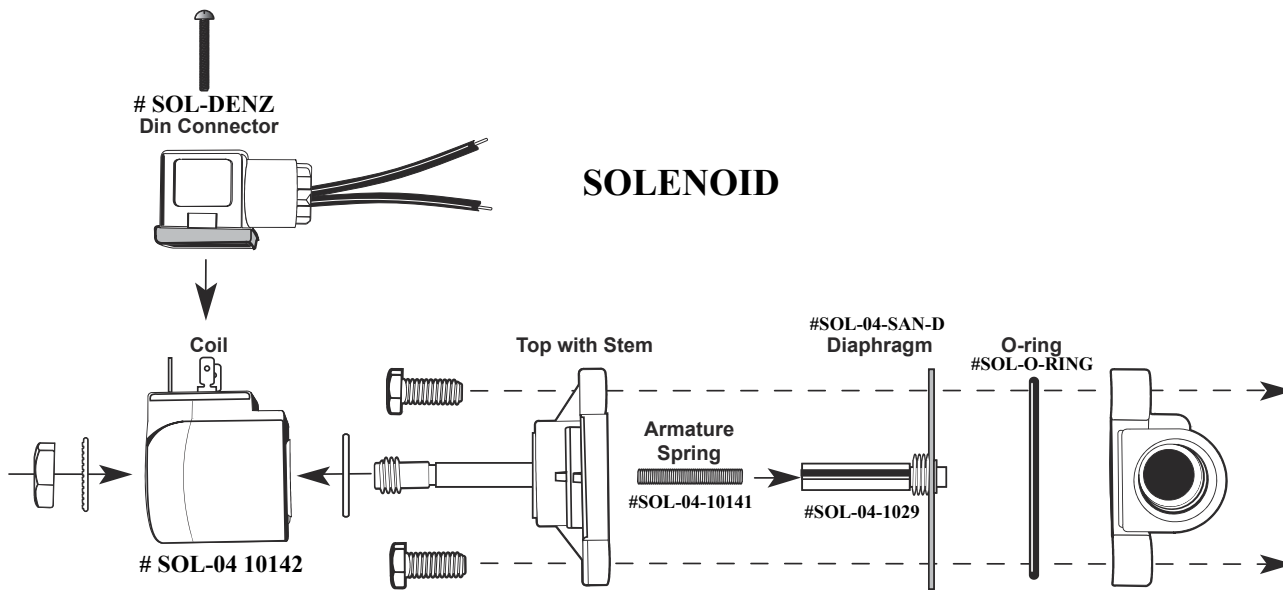

NOTE COLLAR

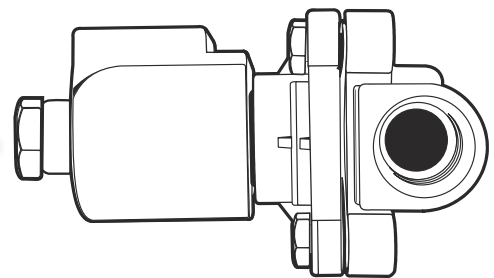

**SOLENOID**  
Normally Open

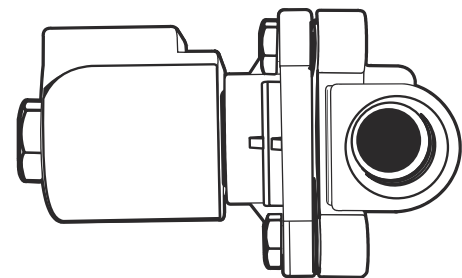

**SOLENOID**  
Normally Closed

MEDICAL SOLUTIONS INTERNATIONAL  
5646 MERRIAM DRIVE  
MERRIAM, KS 66203  
[www.medicalsolutionskc.com](http://www.medicalsolutionskc.com)

800.326.5275  
913.438.9700  
FAX 913.438.9701

## SOLENOIDS

PART NUMBER	PRODUCT DESCRIPTION	PRICE \$
SOL-7524VNC	Solenoid 3/4" 24 VT Normally Closed AC	180.44
SOL-7524VNO	Solenoid 3/4" 24 VT Normally Open AC	299.72
SOL-S201Z1003NC	Stainless Steel 3/4" Normally Closed AC	423.48
SOL-75DC-VNC	Solenoid 3/4" 24 VT Normally Closed DC	185.04
SOL-75DC-VNO	Solenoid 3/4" 24 VT Normally Open DC	348.80
SOL-04-SAN-D	Santilite Diaphragm	32.65
SOL-DENZ	Solenoid Den Connector	22.52
SOL-KIT	Solenoid Santoprene Kit	46.50
SOL-O-RING	"O"RINGS for all Solenoids	10.96

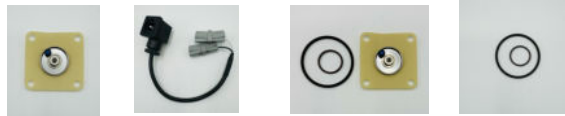

NOTE COLLAR  
FOR  
NORMALLY  
OPEN



\*SDS-CB200  
2020 or after have  
DC solenoids

## INJECTORS

PART NUMBER	PRODUCT DESCRIPTION	PRICE \$
INJ-484	1/2" Injector Venturi-Kynar	121.43



## EDUCTORS

PART NUMBER	PRODUCT DESCRIPTION	PRICE \$
ED-4927OPP	Eductor	65.82



## SPRAY NOZZLES

PART NUMBER	PRODUCT DESCRIPTION	PRICE \$
SN-17020	1/4" Spiral Jet Spray Nozzle	34.58
SN-4814T84	1/4" Blue Spray Nozzle 120 degree	34.58



MEDICAL SOLUTIONS INTERNATIONAL  
5646 MERRIAM DRIVE  
MERRIAM, KS 66203  
[www.medicalsolutionskc.com](http://www.medicalsolutionskc.com)

800.326.5275  
913.438.9700  
FAX 913.438.9701

# BICARB SYSTEM ACCESSORIES

20

## HATCH COVER

PART NUMBER	PRODUCT DESCRIPTION	PRICE \$
HHC-711	Hinged Hatch Cover-Cam Latch	105.64
HHC-25	Hinged Gasket Cord Kit	13.33
HHC-RETRO KIT	Kit Switching from HHC-912 to HHC-711	46.95



## TANK LABELS

PART NUMBER	PRODUCT DESCRIPTION	PRICE \$
LDT-100	Day Tank Label	11.81
LMT-100	Mix Tank Label	11.81
LDT-50	Day Tank Label	11.81
LMT-50	Mix Tank Label	11.81



## KENT METERS

PART NUMBER	PRODUCT DESCRIPTION	PRICE \$
KM-CA-CONV-KIT	Kent Meter to Carlon Meter	779.90
KM-CA-50	Carlon 1/2" Water Meter	382.00
KM-CA-75	Carlon 3/4" Water Meter	382.00
KM-CA-WL	Wire Lead for Meter	128.40



## WAND

PART NUMBER	PRODUCT DESCRIPTION	PRICE \$
M-MXR-WD	Wand Assembly for 100 Gallon Tank	259.00
M-MXR-WB	Bicarb Wand Block/Knob for 100 Gallon Tank	35.00



## HYDROMETERS

PART NUMBER	PRODUCT DESCRIPTION	PRICE \$
HYDRO-C-08265	Plastic Specific Gravity Hydrometer	221.00
HYDRO-E-6135-6	Hydrometer Jar 500 ml	117.8



MEDICAL SOLUTIONS INTERNATIONAL  
 5646 MERRIAM DRIVE  
 MERRIAM, KS 66203  
[www.medicalsolutionskc.com](http://www.medicalsolutionskc.com)

800.326.5275  
 913.438.9700  
 FAX 913.438.9701

## FUSES

PART NUMBER	PRODUCT DESCRIPTION	PRICE \$
FU-MXR-20	20 AMP Fuse (120 vt. sys)	39.98
FU-MXR-6.25	6.25 AMP Fuse (24 vt. sys)	39.98
FU-BU-FRN-R-2	Bullet Fuse 20 AMP	32.00
FU-BU-ECNR6.25	Bullet Fuse 6.25 AMP	28.95



## SWITCHES

PART NUMBER	PRODUCT DESCRIPTION	PRICE \$
SWT-24RS	24 Volt Rocker Switch (#1,2,3,4,5)	13.43
SWT-24RS/BR	SMALL 24v Rocker Switch (2020+)	17.24
SWT-120RS	120 Volt Rocker Switch (#6, #7 Switches)	13.43
SWT-120TGL	120 Volt Toggle Switch (not for CB200)	24.00
SWT-1092D5	Green Indicator Light (Chlorine Timer)	13.43
SWT-53413-5	Green Indicator Light (MM1PD Fill Mix)	13.43
SWT-53413-6	Green Indicator Light (MM1PD Reci, ACID)	13.43
SWT-53415-5	Red Indicator Light (MM1PD Recirc)	13.43
SWT-1092D1	Red Indicator Light (Chlorine Timer)	13.43
SWT-SAFETY	Safety Switch	131.72



## SENSORS

PART NUMBER	PRODUCT DESCRIPTION	PRICE \$
FS-50195k94	Vertical Mount Level Switch	69.82
FS-46515k41	Horizontal Float Switch Side Mount	49.95
FS-135815	Flow Sensor 1"	245.00



## PROXIMITY SWITCH

PART NUMBER	PRODUCT DESCRIPTION	PRICE \$
SWT-PROX	Proximity Switch	299.36



## CIRCUIT BREAKER

PART NUMBER	PRODUCT DESCRIPTION	PRICE \$
CB-L881C	Circuit Breaker	38.95



MEDICAL SOLUTIONS INTERNATIONAL  
 5646 MERRIAM DRIVE  
 MERRIAM, KS 66203  
[www.medicalsolutionskc.com](http://www.medicalsolutionskc.com)

800.326.5275  
 913.438.9700  
 FAX 913.438.9701

## TRANSFORMER

PART NUMBER	PRODUCT DESCRIPTION	PRICE \$
TR-50	Transformer 120 VT- 24 AC	65.95
TRC-C-120V	Transformer LVS-150	90.00
SOLA-12549334	SOLA Transformer	196.54

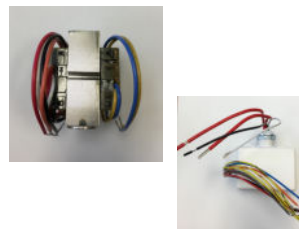

## STATIC INLINE MIXER

PART NUMBER	PRODUCT DESCRIPTION	PRICE \$
STATIC MIXER	Static Inline Mixer	384.74



## ELECTRICAL CONTROL BOXES

PART NUMBER	PRODUCT DESCRIPTION	PRICE \$
M-RA02	Bicarb Remote Alarm with Reset Mute	641.25
M-MXR-BICFM	Dual Pump Control Box on Single 100 gallon mixers	943.00
M-MXR-RPC	Recirculation Pump Control on Single 100 gallon	499.98
PP-24VT	Piezo Buzzer	17.48
M-CT02	Time Delay Chlorine Test Timer	795.96
M-RA03	Remote Alarm for Chlorine Test Timer	129.95
M-RA-W	18 Gauge 2 Conductor Sheathed Wire	1.58 ft



**MEDICAL SOLUTIONS INTERNATIONAL**  
 5646 MERRIAM DRIVE  
 MERRIAM, KS 66203  
[www.medicalsolutionskc.com](http://www.medicalsolutionskc.com)

**800.326.5275**  
**913.438.9700**  
 FAX **913.438.9701**

# PRESSURIZED PRODUCTS

PRESSURE GAUGE		
PART NUMBER	PRODUCT DESCRIPTION	PRICE \$
PG-B254	Pressure Gauge Brass 0-100 Lower Mount	81.50
PG-AP-0-30	Plastic Pressure Gauge with Subber for APDS-CAB3	270.00
PG-S-5335CBM-100	Pressure Gauge Stainless Steel 0-100 Back Mount	121.90
PG-S-5335CLM-100	Pressure Gauge Stainless Steel 0-100 Lower Mount	117.49
PG-S-254CBM-30	Pressure Gauge Stainless Steel 0-30 Back Mount	121.90
PG-S-254CLM-30	Pressure Gauge Stainless Steel 0-30 Lower Mount	117.49
PG-B204L-CLM-160	Pressure Gauge Stainless Steel 0-160 Lower Mount	117.49
PG-B254R-CBM-300	Pressure Gauge Stainless Steel 0-300 Back Mount	117.49



PRESSURE REGULATOR		
PART NUMBER	PRODUCT DESCRIPTION	PRICE \$
PR-BHR	Pressure Regulator Bulkhead Nut	9.50
PR-R91S200AA	Pressure Regulator Norgren w/ 1/4" FNPT	164.76
PR-AAP044506	Pressure Regulator Watts w/ 1/4" FNPT	60.64
PR-R362IUY1-S1	Pressure Regulator AOP w/ 1/4" FNPT	74.38



PR-R91S200AA



PR-AAP044506



PR-R362IUY1-S1

MEDICAL SOLUTIONS INTERNATIONAL  
 5646 MERRIAM DRIVE  
 MERRIAM, KS 66203  
[www.medicalsolutionskc.com](http://www.medicalsolutionskc.com)

800.326.5275  
 913.438.9700  
 FAX 913.438.9701

CAMLOCKS		
PART NUMBER	PRODUCT DESCRIPTION	PRICE \$
CL-B075	Camlock Female Coupler x 3/4" Male NPT	22.94
CL-B100	Camlock Female Coupler x 1" Male NPT	28.26
CL-C075	Camlock Female Coupler x 3/4" Barb	25.92
CL-C100	Camlock Female Coupler x 1" Barb	26.22
CL-E075	Camlock Male Adapter x 3/4" Barb	13.48
CL-E100	Camlock Male Adapter x 1" Barb	12.80
CL-F075	Camlock Male Adapter x 3/4" Male NPT	13.48
CL-F100	Camlock Male Adapter x 1" Male NPT	12.70
CL-DC075	Camlock Dust Cap 3/4"	29.78
CL-DC100	Camlock Dust Cap 1"	27.10
CL-DP075	Camlock Dust Plug 3/4"	22.62
CL-DP100	Camlock Dust Plug 1"	26.28



Series B



Series C



Series E



Series F



Series DC



Series DP



BULKHEAD FITTINGS		
PART NUMBER	PRODUCT DESCRIPTION	PRICE \$
BH-50	1/2" TXT Banjo Bulkhead Fitting	27.84
BH-75	3/4" TXT Banjo Bulkhead Fitting	29.62
BH-16439	1/2" White Bulkhead Fitting	62.72



FILTERS		
PART NUMBER	PRODUCT DESCRIPTION	PRICE \$
FIL-CAP 2	.2 Micron Air Filter	116.65
FIL-CAP2/GAC	.2 Micron Air Filter w/Granulated Activated Carbon	127.65
FIL-DCP02000	.2 Micron Air Filter for Bicarb System	149.99
FIL-5-GAC-H	Blue 1/2" Housing for 5" Carbon Filter	30.68
FIL-5-GAC	Granulated Activated Carbon Filter	18.60
FIL-50H-SS	1/2" Clear Bulb, Filter Housing and Filter Screen	38.48
FIL-50-BH	1/2" Clear Bulb	28.50
FIL-50X100	Filter for 1/2" Housing	13.43
FIL-75H-SS	3/4" Clear Bulb, Filter Housing and Filter Screen	65.48
FIL-75-BH	3/4" Clear Bulb	38.50
FIL-75X100	Filter for 3/4" Housing	21.00
FIL-PO.2-10E	.2 Micron 10" RO Storage Tank Air Filter	162.00
FIL-10-H	Housing for 10" 5 micron Air Filters	63.36
FIL-AP-5-10	10" 5 Micron Air Filter	12.24
FIL-AP-5-10/24	10" 5 Micron Air Filter (24 Per Case)	293.76
FIL-AP-5-20	20" 5 Micron Fines Filter (RO Feed)	10.60
FIL-AP-5-20/20	20" 5 Micron Case (20 Per case)	200.00
FIL-PCP-10BB	10" Pentekchlor 20 BB Carbon Block	125.92
FIL-PCP-20BB	20" Pentekchlor 20 BB Carbon Block	280.50
FIL-GAC20-BB	10" Carbon Block Filter	120.25
TW30-4040	Membranes	495.00



FIL-DCP02000



FIL-5-GAC-H



FIL-5-GAC



FIL-50H-SS



FIL-75H-SS



**MEDICAL SOLUTIONS INTERNATIONAL**  
 5646 MERRIAM DRIVE  
 MERRIAM, KS 66203  
[www.medicalsolutionskc.com](http://www.medicalsolutionskc.com)

800.326.5275  
 913.438.9700  
 FAX 913.438.9701

## IWAKI PUMP

PART NUMBER	PRODUCT DESCRIPTION	PRICE \$
PMP-IW-55RLT	Iwaki Pump 55 RLT (complete motor and wet end kit)	998.96
PMP-IW-55RLT-WEK	Iwaki Pump Wet End Kit 55 RLT	517.20
PMP-IW-70RLZT	Iwaki Pump 70 RLZT	1247.40
PMP-IW-70RLZT-WEK	Iwaki Pump Wet End Kit-70 RLZT	586.58
PMP-IW-70RLT	Iwaki Pump 70 RLT	1169.28
PMP-IW-70RLT-WEK	Iwaki Pump Wet End Kit 70 RLT	586.58
PMP-IW-30RLT	Iwaki Pump 30 RLT **special order	778.00
PMP-IW-100RLT	Iwaki Pump 100 RLT **special order	1346.40

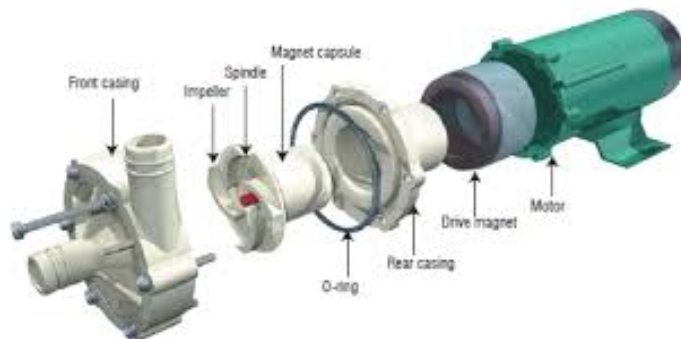

**MEDICAL SOLUTIONS INTERNATIONAL**  
 5646 MERRIAM DRIVE  
 MERRIAM, KS 66203  
[www.medicalsolutionskc.com](http://www.medicalsolutionskc.com)

800.326.5275  
 913.438.9700  
 FAX 913.438.9701

<b>MARCH PUMP TE-7R</b>			
PART NUMBER	DIAGRAM #	PRODUCT DESCRIPTION	PRICE \$
PMP-M-TE7R		TE7R Large March Pump (Motor and Wet End Kit)	1663.96
PMP-M-TE7R-WEK	#1- #8	TE7R Wet End Kit	839.36
PMP-M-0124-01	ALT #8	Rear Magnet Housing Kynar	267.42

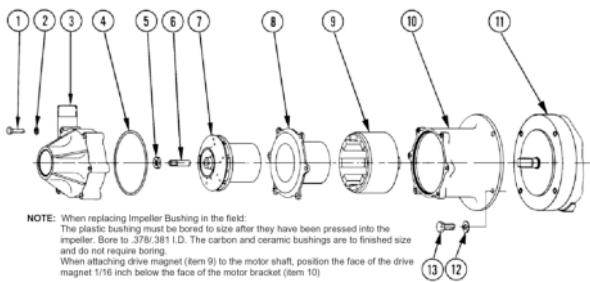

<b>PUMPS</b>		
PART NUMBER	PRODUCT DESCRIPTION	PRICE \$
PMP-M-AC5C	March Pump AC5C-MD	975.42
PMP-SF-2088	Shur Flo Pump 3.3 GPM 115VT	275.12
PMP-SF-2088-PA	Shur Flo Pump including purge assembly	650.36



**MEDICAL SOLUTIONS INTERNATIONAL**  
 5646 MERRIAM DRIVE  
 MERRIAM, KS 66203  
[www.medicalsolutionskc.com](http://www.medicalsolutionskc.com)

800.326.5275  
 913.438.9700  
 FAX 913.438.9701

## HOSE AND HOSE CLAMPS

PART NUMBER	PRODUCT DESCRIPTION	PRICE \$
HC-100	Hose Clamp for 1" Hose OD	4.40
HC-3/4	Hose Clamp for 3/4" Hose OD	4.24
HC-1/2	Hose Clamp for 1/2" Hose OD	4.14
HC-3/8	Hose Clamp for 3/8" Hose OD	4.04
HC-BLACK	Black Hose Clamp for 3/8" OD	2.38
HC-BLUE	Blue Hose Clamp for 3/8" OD	2.38
H-PB-1-G	1" ID Poly Braided Hose Gray	7.90
H-PB-3/4-G	3/4" ID Poly Braided Hose Gray	5.10
H-PB-1/2-G	1/2" ID Poly Braided Hose Gray	4.64
H-PB-1/2-CL	1/2" ID Poly Braided Hose Clear	2.98
H-PB-3/8-G	3/8" ID Poly Braided Hose Gray	2.74
H-PB-3/8-CL	3/8" ID Poly Braided Hose Clear	2.98
H-PV-3/4-CL	3/4" ID Clear Poly Vinyl Hose	4.74
H-PV-3/8	3/8" ID Clear Poly Vinyl Hose	2.74
H-PV-1/4	1/4" ID Clear Poly Vinyl Hose	2.74



## CLICKS

PART NUMBER	PRODUCT DESCRIPTION	PRICE \$
CLIC-12	#12 Click for Drain Hose	3.48
CLIC-15	#15 Click for Drain Hose	3.70
CLIC-17	#17 Click for 3/8" PVC	3.48
CLIC-20	#20 Click for 1/2" PVC	3.70
CLIC-25	#25 Click for 3/4" PVC	5.32
CLIC-32	#32 Click for 1" PVC	7.12
CLIC-47	#47 Click for 1-1/2" PVC	12.98



MEDICAL SOLUTIONS INTERNATIONAL  
 5646 MERRIAM DRIVE  
 MERRIAM, KS 66203  
[www.medicalsolutionskc.com](http://www.medicalsolutionskc.com)

800.326.5275  
 913.438.9700  
 FAX 913.438.9701

<b>TUBING</b>		
PART NUMBER	PRODUCT DESCRIPTION	PRICE \$
1/2" BLUE	1/2" Poly Tubing Blue	0.66
1/2" ORANGE	1/2" Poly Tubing Orange (not stock)	1.14
1/2" RED	1/2" Poly Tubing Red	0.66
1/2" YELLOW	1/2" Poly Tubing Yellow	0.66
1/4" BLACK	1/4" Poly Tubing Black	0.66
1/4" BLUE	1/4" Poly Tubing Blue	0.66
1/4" RED	1/4" Poly Tubing Red	0.66
1/4" YELLOW	1/4" Poly Tubing Yellow	0.66
1/4" ORANGE	1/4" Poly Tubing Orange	0.66
1/4" WHITE	1/4" Poly Tubing White	0.66
3/8" BLUE	3/8" Poly Tubing Blue	0.65
3/8" GREEN	3/8" Poly Tubing Green	0.65
3/8" ORANGE	3/8" Poly Tubing Orange	0.65
3/8" RED	3/8" Poly Tubing Red	0.65
3/8" WHITE	3/8" Poly Tubing White	0.65
3/8" YELLOW	3/8" Poly Tubing Yellow	0.65
5/8" YELLOW	5/8" Poly Tubing Yellow	0.94
5/8" BLUE	5/8" Poly Tubing Blue	0.94
5/8" RED	5/8" Poly Tubing Red	0.94



<b>COILED CONCENTRATED TUBING</b>		
PART NUMBER	PRODUCT DESCRIPTION	PRICE \$
C80550	Red Coiled Concentrated Tubing	39.90
C80553	Blue Coiled Concentrated Tubing	39.90
C80558	Clear Coiled Concentrated Tubing	39.90



MEDICAL SOLUTIONS INTERNATIONAL  
 5646 MERRIAM DRIVE  
 MERRIAM, KS 66203  
[www.medicalsolutionskc.com](http://www.medicalsolutionskc.com)

800.326.5275  
 913.438.9700  
 FAX 913.438.9701

## COUPLING SOC

PART NUMBER	PRODUCT DESCRIPTION	PRICE \$
829-002	1/4" SXS Coupling	9.42
829-003	3/8" SXS Coupling	9.42
829-005	1/2" SXS Coupling	5.88
829-007	3/4" SXS Coupling	7.96
829-010	1" SXS Coupling	8.20
829-012	1-1/4" SXS Coupling	12.48
829-015	1-1/2" SXS Coupling	13.92
829-020	2" SXS Coupling	14.73



## FEMALE ADAPTER SOC X FIPT

PART NUMBER	PRODUCT DESCRIPTION	PRICE \$
835-002	1/4" SXT Female Adapter	9.95
835-003	3/8" SXT Female Adapter	10.26
835-005	1/2" SXT Female Adapter	6.45
835-007	3/4" SXT Female Adapter	9.98
835-010	1" SXT Female Adapter	14.26
835-012	1-1/4" SXT Female Adapter	19.54
835-015	1-1/2" SXT Female Adapter	23.96
835-020	2" SXT Female Adapter	45.26



## MALE ADAPTER MIPT X SOC

PART NUMBER	PRODUCT DESCRIPTION	PRICE \$
836-005	1/2" SXT Male Adapter	7.96
836-007	3/4" SXT Male Adapter	7.58
836-010	1" SXT Male Adapter	13.98
836-012	1-1/4" SXT Male Adapter	17.74
836-015	1-1/2" SXT Male Adapter	22.04
836-020	2" SXT Male Adapter	31.88



## COUPLING FIPT

PART NUMBER	PRODUCT DESCRIPTION	PRICE \$
830-002	1/4" TXT Coupling	7.06
830-003	3/8" TXT Coupling	7.06
830-005	1/2" TXT Coupling	9.40
830-007	3/4" TXT Coupling	11.13
830-010	1" TXT Coupling	12.24
830-012	1-1/4" TXT Coupling	14.96
830-015	1-1/2" TXT Coupling	35.68
830-020	2" TXT Coupling	32.89



## 90° ELBOW SOC

PART NUMBER	PRODUCT DESCRIPTION	PRICE \$
806-002	1/4" SXS 90° Elbow	4.98
806-003	3/8" SXS 90° Elbow	4.98
806-005	1/2" SXS 90° Elbow	3.94
806-007	3/4" SXS 90° Elbow	4.26
806-010	1" SXS 90° Elbow	6.70
806-012	1-1/4" SXS 90° Elbow	10.16
806-015	1-1/2" SXS 90° Elbow	10.10
806-020	2" SXS 90° Elbow	15.53



## 90° ELBOW LONG SWEEP SOC

PART NUMBER	PRODUCT DESCRIPTION	PRICE \$
806-005LSF	1/2" SXS 90° Long Sweep	98.06
806-007LSF	3/4" SXS 90° Long Sweep	110.08
806-010LSF	1" SXS 90° Long Sweep	104.88
806-012LSF	1-1/4" SXS 90° Long Sweep	177.36
806-015LSF	1-3/4" SXS 90° Long Sweep	179.82
806-020LSF	2" SXS 90° Long Sweep	198.96



MEDICAL SOLUTIONS INTERNATIONAL  
 5646 MERRIAM DRIVE  
 MERRIAM, KS 66203  
[www.medicalsolutionskc.com](http://www.medicalsolutionskc.com)

800.326.5275  
 913.438.9700  
 FAX 913.438.9701

## 90° ELBOW SWEEP SOC X SOC

PART NUMBER	PRODUCT DESCRIPTION	PRICE \$
806-005S	1/2" SXS 90° Sweep	12.23
806-007S	3/4" SXS 90° Sweep	14.39
806-010S	1" SXS 90° Sweep	17.86
806-012S	1-1/4" SXS 90° Sweep	22.38
806-015S	1-1/2" SXS 90° Sweep	24.02
806-020S	2" SXS 90° Sweep	26.43



## 90° SOC X FIPT

PART NUMBER	PRODUCT DESCRIPTION	PRICE \$
807-002	1/4" SXT 90° Elbow	12.93
807-003	3/8" SXT 90° Elbow	14.02
807-005	1/2" SXT 90° Elbow	16.52
807-007	3/4" SXT 90° Elbow	22.24
807-010	1" SXT 90° Elbow	16.38
807-012	1-1/4" SXT 90° Elbow	19.96
807-015	1-1/2" SXT 90° Elbow	23.26
807-020	2" SXT 90° Elbow	34.99



## 90° ELBOW FIPT

PART NUMBER	PRODUCT DESCRIPTION	PRICE \$
808-002	1/4" TXT 90° Elbow	8.06
808-003	3/8" TXT 90° Elbow	8.06
808-005	1/2" TXT 90° Elbow	8.96
808-007	3/4" TXT 90° Elbow	11.68
808-010	1" TXT 90° Elbow	12.26
808-012	1-1/4" TXT 90° Elbow	13.56
808-015	1-1/2" TXT 90° Elbow	18.02
808-020	2" TXT 90° Elbow	22.56



MEDICAL SOLUTIONS INTERNATIONAL  
 5646 MERRIAM DRIVE  
 MERRIAM, KS 66203  
[www.medicalsolutionskc.com](http://www.medicalsolutionskc.com)

800.326.5275  
 913.438.9700  
 FAX 913.438.9701

## 90° STREET ELBOW SPRIG X SOC

PART NUMBER	PRODUCT DESCRIPTION	PRICE \$
809-005	1/2" 90° Street Elbow	4.96
809-007	3/4" 90° Street Elbow	6.12
809-010	1" 90° Street Elbow	12.26
809-012	1-1/4" 90° Street Elbow	14.04
809-015	1-1/2" 90° Street Elbow	12.20
809-020	2" 90° Street Elbow	16.72



## 45° ELBOW SOC

PART NUMBER	PRODUCT DESCRIPTION	PRICE \$
817-002	1/4" SXS 45° Elbow	11.68
817-003	3/8" SXS 45° Elbow	11.68
817-005	1/2" SXS 45° Elbow	7.82
817-007	3/4" SXS 45° Elbow	9.90
817-010	1" SXS 45° Elbow	14.98
817-012	1-1/4" SXS 45° Elbow	19.34
817-015	1-1/2" SXS 45° Elbow	25.94
817-020	2" SXS 45° Elbow	31.50



## 45° ELBOW FIPT

PART NUMBER	PRODUCT DESCRIPTION	PRICE \$
819-002	1/4" TXT 45° Elbow	15.57
819-003	3/8" TXT 45° Elbow	16.92
819-005	1/2" TXT 45° Elbow	16.54
819-007	3/4" TXT 45° Elbow	17.85
819-010	1" TXT 45° Elbow	17.57
819-012	1-1/4" TXT 45° Elbow	24.84
819-015	1-1/2" TXT 45° Elbow	31.24
819-020	2" TXT 45° Elbow	46.32



MEDICAL SOLUTIONS INTERNATIONAL  
 5646 MERRIAM DRIVE  
 MERRIAM, KS 66203  
[www.medicalsolutionskc.com](http://www.medicalsolutionskc.com)

800.326.5275  
 913.438.9700  
 FAX 913.438.9701

## 45° STREET ELBOW SPIG X SOC

PART NUMBER	PRODUCT DESCRIPTION	PRICE \$
827-005	1/2" 45° Street Elbow	11.49
827-007	3/4" 45° Street Elbow	12.14
827-010	1" 45° Street Elbow	14.73
827-012	1-1/4" 45° Street Elbow	17.86
827-015	1-1/2" 45° Street Elbow	21.12
827-020	2" 45° Street Elbow	27.38



## TEE SOC

PART NUMBER	PRODUCT DESCRIPTION	PRICE \$
801-002	1/4" SXSXS Tee	9.96
801-003	3/8" SXSXS Tee	9.96
801-005	1/2" SXSXS Tee	10.46
801-007	3/4" SXSXS Tee	10.10
801-010	1" SXSXS Tee	12.99
801-012	1-1/4" SXSXS Tee	37.66
801-015	1-1/2" SXSXS Tee	39.24
801-020	2" SXSXS Tee	43.48



## TEE SOC X FIPT

PART NUMBER	PRODUCT DESCRIPTION	PRICE \$
802-002	1/4" SXSXT Tee	21.20
802-005	1/2" SXSXT Tee	18.90
802-007	3/4" SXSXT Tee	22.12
802-010	1" SXSXT Tee	23.44
802-012	1-1/4" SXSXT Tee	24.68
802-015	1-1/2" SXSXT Tee	29.02
802-020	2" SXSXT Tee	34.02



MEDICAL SOLUTIONS INTERNATIONAL  
5646 MERRIAM DRIVE  
MERRIAM, KS 66203  
[www.medicalsolutionskc.com](http://www.medicalsolutionskc.com)

800.326.5275  
913.438.9700  
FAX 913.438.9701

## TEE FIPT

PART NUMBER	PRODUCT DESCRIPTION	PRICE \$
805-002	1/4" TXTXT Tee	10.60
805-003	3/8" TXTXT Tee	13.45
805-005	1/2" TXTXT Tee	10.60
805-007	3/4" TXTXT Tee	13.22
805-010	1" TXTXT Tee	26.04
805-012	1-1/4" TXTXT Tee	29.38
805-015	1-1/2" TXTXT Tee	34.68
805-020	2" TXTXT Tee	35.98



## CROSS SOC

PART NUMBER	PRODUCT DESCRIPTION	PRICE \$
820-002	1/4" SXS Cross	45.22
820-005	1/2" SXS Cross	45.22
820-007	3/4" SXS Cross	47.56
820-010	1" SXS Cross	65.34
820-012	1-1/4" SXS Cross	66.84
820-015	1-1/2" SXS Cross	72.04
820-020	2" SXS Cross	122.68



## CAP SOC

PART NUMBER	PRODUCT DESCRIPTION	PRICE \$
847-002	1/4" Cap Socket	8.79
847-003	3/8" Cap Socket	8.79
847-005	1/2" Cap Socket	7.23
847-007	3/4" Cap Socket	7.51
847-010	1" Cap Socket	11.79
847-012	1-1/4" Cap Socket	13.81
847-015	1-1/2" Cap Socket	13.81
847-020	2" Cap Socket	25.70



# PVC SCHEDULE 80 FITTINGS

36

## CAP FIPT

PART NUMBER	PRODUCT DESCRIPTION	PRICE \$
848-002	1/4" Threaded Cap	7.53
848-003	3/8" Threaded Cap	7.53
848-005	1/2" Threaded Cap	9.38
848-007	3/4" Threaded Cap	11.08
848-010	1" Threaded Cap	12.56
848-012	1-1/4" Threaded Cap	12.98
848-015	1-1/2" Threaded Cap	15.54
848-020	2" Threaded Cap	27.14



## PLUG SPIG

PART NUMBER	PRODUCT DESCRIPTION	PRICE \$
849-005	1/2" SPIG Plug	6.89
849-007	3/4" SPIG Plug	7.44
849-010	1" SPIG Plug	8.14
849-012	1-1/4" SPIG Plug	9.83
849-015	1-1/2" SPIG Plug	10.59
849-020	2" SPIG Plug	13.36



## PLUG MIPT

PART NUMBER	PRODUCT DESCRIPTION	PRICE \$
850-002	1/4" Threaded Plug	8.46
850-003	3/8" Threaded Plug	8.08
850-005	1/2" Threaded Plug	7.46
850-007	3/4" Threaded Plug	7.75
850-010	1" Threaded Plug	8.42
850-012	1-1/4" Threaded Plug	13.81
850-015	1-1/2" Threaded Plug	15.53
850-020	2" Threaded Plug	14.76



MEDICAL SOLUTIONS INTERNATIONAL  
5646 MERRIAM DRIVE  
MERRIAM, KS 66203  
[www.medicalsolutionskc.com](http://www.medicalsolutionskc.com)

800.326.5275  
913.438.9700  
FAX 913.438.9701

<b>REDUCER BUSHING FLUSH SPIG X SOC</b>		
PART NUMBER	PRODUCT DESCRIPTION	PRICE \$
RB-837-052	3/8" X 1/4" SXS Reducer Bushing	5.72
RB-837-072	1/2" X 1/4" SXS Reducer Bushing	5.72
RB-837-073	1/2" X 3/8" SXS Reducer Bushing	6.68
RB-837-101	3/4" X 1/2" SXS Reducer Bushing	4.89
RB-837-129	1" X 3/8" SXS Reducer Bushing	10.82
RB-837-130	1" X 1/2" SXS Reducer Bushing	6.28
RB-837-131	1" X 3/4" SXS Reducer Bushing	5.44
RB-837-166	1-1/4" X 1/2" SXS Reducer Bushing	8.52
RB-837-167	1-1/4" X 3/4" SXS Reducer Bushing	12.46
RB-837-168	1-1/4" X 1" SXS Reducer Bushing	8.94
RB-837-209	1-1/2" X 1/2" SXS Reducer Bushing	15.04
RB-837-210	1-1/2" X 3/4" SXS Reducer Bushing	13.74
RB-837-211	1-1/2" X 1" SXS Reducer Bushing	14.16
RB-837-212	1-1/2" X 1-1/4" SXS Reducer Bushing	13.82
RB-837-247	2" X 1/2" SXS Reducer Bushing	14.93
RB-837-248	2" X 3/4" SXS Reducer Bushing	16.54
RB-837-249	2" X 1" SXS Reducer Bushing	16.54
RB-837-250	2" X 1-1/4" SXS Reducer Bushing	16.54
RB-837-251	2" X 1/2" SXS Reducer Bushing	16.54
RB-837-290	2-1/2" X 1-1/4" SXS Reducer Bushing	28.72
RB-837-291	2-1/2" X 1-1/2" SXS Reducer Bushing	28.72
RB-837-292	2-1/2" X 2" SXS Reducer Bushing	28.72



<b>REDUCER BUSHING FLUSH SPIG X FIPT</b>		
PART NUMBER	PRODUCT DESCRIPTION	PRICE \$
RB-838-052	3/8"X 1/4" SXT Reducer Bushing	4.72
RB-838-071	1/2"X 1/8" SXT Reducer Bushing	5.20
RB-838-072	1/2"X 1/4" SXT Reducer Bushing	5.79
RB-838-073	1/2"X 3/8" SXT Reducer Bushing	5.72
RB-838-098	3/4"X 1/4" SXT Reducer Bushing	5.20
RB-838-099	3/4"X 3/8" SXT Reducer Bushing	7.93
RB-838-101	3/4"X 1/2" SXT Reducer Bushing	4.56
RB-838-127	1"X 1/8" SXT Reducer Bushing	5.44
RB-838-129	1"X 3/8" SXT Reducer Bushing	9.85
RB-838-130	1"X 1/2" SXT Reducer Bushing	5.44
RB-838-131	1"X 3/4" SXT Reducer Bushing	5.44
RB-838-166	1-1/4"X 1/2" SXT Reducer Bushing	11.02
RB-838-167	1-1/4"X 3/4" SXT Reducer Bushing	11.02
RB-838-168	1-1/4"X 1" SXT Reducer Bushing	11.02
RB-838-206	1-1/2"X 1/8" SXT Reducer Bushing	13.82
RB-838-207	1-1/2"X 1/4" SXT Reducer Bushing	13.14
RB-838-209	1-1/2"X 1/2" SXT Reducer Bushing	16.86
RB-838-210	1-1/2"X 3/4" SXT Reducer Bushing	16.14
RB-838-211	1-1/2"X 1" SXT Reducer Bushing	13.79
RB-838-212	1-1/2"X 1-1/4" SXT Reducer Bushing	12.54
RB-838-247	2"X 1/2" SXT Reducer Bushing	15.34
RB-838-248	2"X 3/4" SXT Reducer Bushing	16.18
RB-838-249	2"X 1" SXT Reducer Bushing	18.18
RB-838-250	2"X 1-1/4" SXT Reducer Bushing	18.34
RB-838-251	2"X 1-1/2" SXT Reducer Bushing	18.34



MEDICAL SOLUTIONS INTERNATIONAL  
 5646 MERRIAM DRIVE  
 MERRIAM, KS 66203  
[www.medicalsolutionskc.com](http://www.medicalsolutionskc.com)

800.326.5275  
 913.438.9700  
 FAX 913.438.9701

## REDUCER BUSHING FLUSH MIPT X FIPT

PART NUMBER	PRODUCT DESCRIPTION	PRICE \$
TRB-839-041	1/4" X 1/8" TXT Reducer Bushing	11.84
TRB-839-052	3/8" X 1/4" TXT Reducer Bushing	12.10
TRB-839-072	1/2" X 1/4" TXT Reducer Bushing	11.86
TRB-839-073	1/2" X 3/8" TXT Reducer Bushing	12.18
TRB-839-098	3/4" X 1/4" TXT Reducer Bushing	8.84
TRB-839-099	3/4" X 3/8" TXT Reducer Bushing	9.30
TRB-839-101	3/4" X 1/2" TXT Reducer Bushing	7.26
TRB-839-128	1" X 1/4" TXT Reducer Bushing	14.26
TRB-839-129	1" X 3/8" TXT Reducer Bushing	15.97
TRB-839-130	1" X 1/2" TXT Reducer Bushing	11.40
TRB-839-131	1" X 3/4" TXT Reducer Bushing	11.40
TRB-839-166	1-1/4" X 1/2" TXT Reducer Bushing	12.32
TRB-839-167	1-1/4" X 3/4" TXT Reducer Bushing	12.10
TRB-839-168	1-1/4" X 1" TXT Reducer Bushing	16.44
TRB-839-209	1-1/2" X 1/2" TXT Reducer Bushing	18.66
TRB-839-210	1-1/2" X 3/4" TXT Reducer Bushing	16.10
TRB-839-211	1-1/2" X 1" TXT Reducer Bushing	14.34
TRB-839-212	1-1/2" X 1-1/4" TXT Reducer Bushing	14.34
TRB-839-247	2" X 1/2" TXT Reducer Bushing	21.00
TRB-839-248	2" X 3/4" TXT Reducer Bushing	21.00
TRB-839-249	2" X 1" TXT Reducer Bushing	21.00
TRB-839-250	2" X 1-1/4" TXT Reducer Bushing	21.00
TRB-839-251	2" X 1-1/2" TXT Reducer Bushing	21.00
TRB-839-292	2-1/2" X 2" TXT Reducer Bushing	28.44



MEDICAL SOLUTIONS INTERNATIONAL  
 5646 MERRIAM DRIVE  
 MERRIAM, KS 66203  
[www.medicalsolutionskc.com](http://www.medicalsolutionskc.com)

800.326.5275  
 913.438.9700  
 FAX 913.438.9701

## UNION (OLD STYLE) FIPT W/EDPM O-RING SEAL

PART NUMBER	PRODUCT DESCRIPTION	PRICE \$
898-005	1/2" Threaded Union EPDM	16.68
898-007	3/4" Threaded Union EPDM	21.88
898-010	1" Threaded Union EPDM	28.70
898-012	1-1/4" Threaded Union EDPM	92.52
898-015	1-1/2" Threaded Union EDPM	60.78
898-020	2" Threaded Union EDPM	106.77

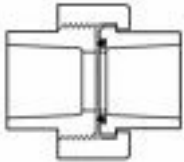
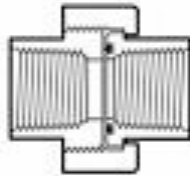

## UNION (OLD STYLE) SOC W/EDPM O-RING SEAL

PART NUMBER	PRODUCT DESCRIPTION	PRICE \$
897-005	1/2" Socket Union EPDM	13.57
897-007	3/4" Socket Union EPDM	17.23
897-010	1" Socket Union EPDM	19.99
897-012	1-1/4" Socket Union EDPM	37.08
897-015	1-1/2" Socket Union EDPM	38.84
897-020	2" Socket Union EDPM	64.64
897-025	2-1/2" Socket Union EDPM	83.78
897-030	3" Socket Union EDPM	104.66
897-040	4" Socket Union EDPM	135.66



MEDICAL SOLUTIONS INTERNATIONAL  
 5646 MERRIAM DRIVE  
 MERRIAM, KS 66203  
[www.medicalsolutionskc.com](http://www.medicalsolutionskc.com)

800.326.5275  
 913.438.9700  
 FAX 913.438.9701

## TANK ADAPTER WITH EDPM GASKET SOC X F

PART NUMBER	PRODUCT DESCRIPTION	PRICE \$
871-E-005	1/2" SXT Bulkhead	54.79
871-E-007	3/4" SXT Bulkhead	55.65
871-E-010	1" SXT Bulkhead	52.99
871-E-012	1-1/4" SXT Bulkhead	70.88
871-E-015	1-1/2" SXT Bulkhead	75.66
871-E-020	2" SXT Bulkhead	91.91

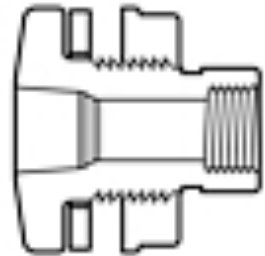

## TANK ADAPTER WITH EDPM GASKET FIPT

PART NUMBER	PRODUCT DESCRIPTION	PRICE \$
872-E-005	1/2" TXT Bulkhead	77.24
872-E-007	3/4" TXT Bulkhead	96.94
872-E-010	1" TXT Bulkhead	96.94
872-E-012	1-1/4" TXT Bulkhead	132.22
872-E-015	1-1/2" TXT Bulkhead	132.22
872-E-020	2" TXT Bulkhead	151.74

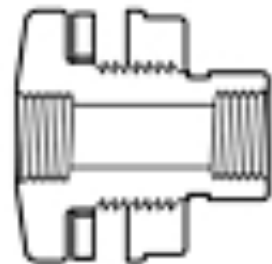

## BULKHEAD FITTINGS

PART NUMBER	PRODUCT DESCRIPTION	PRICE \$
BH-50	1/2" TXT Banjo Bulkhead Fitting	27.84
BH-75	3/4" TXT Banjo Bulkhead Fitting	29.62
BH-16439	1/2" White Bulkhead	62.72



## NIPPLES 1/4"

PART NUMBER	PRODUCT DESCRIPTION	PRICE \$
880-005	Close 1/4" NIPPLE	3.49
880-015	1-1/2" Long 1/4" Nipple	4.33
880-020	2" Long 1/4" Nipple	5.02
880-025	2-1/2" Long 1/4" Nipple	6.20
880-030	3" Long 1/4" Nipple	6.74



## NIPPLES 3/8"

PART NUMBER	PRODUCT DESCRIPTION	PRICE \$
881-005	Close 3/8" Nipple	5.88
881-015	1-1/2" Long 3/8" Nipple	5.92
881-020	2" Long 3/8" Nipple	5.98
881-025	2-1/2" Long 3/8" Nipple	6.47
881-030	3" Long 3/8" Nipple	6.47



## NIPPLES 1/2"

PART NUMBER	PRODUCT DESCRIPTION	PRICE \$
882-005	Close 1/2" Nipple	3.72
882-015	1-1/2" Long 1/2" Nipple	3.72
882-020	2" Long 1/2" Nipple	3.96
882-025	2-1/2" Long 1/2" Nipple	3.98
882-030	3" Long 1/2" Nipple	4.46
882-035	3-1/2" Long 1/2" Nipple	4.46
882-040	4" Long 1/2" Nipple	5.24
882-045	4-1/2" Long 1/2" Nipple	5.24
882-050	5" Long 1/2" Nipple	6.55
882-055	5-1/2" Long 1/2" Nipple	8.22
882-060	6" Long 1/2" Nipple	6.12
882-060M	6" Long 1/2" Nipple Machine Cut	6.35



MEDICAL SOLUTIONS INTERNATIONAL  
5646 MERRIAM DRIVE  
MERRIAM, KS 66203  
[www.medicalsolutionskc.com](http://www.medicalsolutionskc.com)

800.326.5275  
913.438.9700  
FAX 913.438.9701

## NIPPLES 3/4"

PART NUMBER	PRODUCT DESCRIPTION	PRICE \$
883-005	Close 3/4" Nipple	3.96
883-015	1-1/2" Long 3/4" Nipple	3.96
883-020	2" Long 3/4" Nipple	4.46
883-025	2-1/2" Long 3/4" Nipple	4.46
883-030	3" Long 3/4" Nipple	5.82
883-035	3-1/2" Long 3/4" Nipple	6.12
883-040	4" Long 3/4" Nipple	7.30
883-045	4-1/2" Long 3/4" Nipple	7.58
883-050	5" Long 3/4" Nipple	6.23
883-055	5-1/2" Long 3/4" Nipple	9.72
883-060	6" Long 3/4" Nipple	10.42
883-140M	14" Long x 3/4" Nipple Machine C	10.66



## NIPPLES 1"

PART NUMBER	PRODUCT DESCRIPTION	PRICE \$
884-005	Close 1" Nipple	5.24
884-015	1-1/2" Long 1" Nipple	6.56
884-020	2" Long 1" Nipple	6.33
884-025	2-1/2" Long 1" Nipple	6.40
884-030	3" Long 1" Nipple	7.58
884-035	3-1/2" Long 1" Nipple	6.54
884-040	4" Long 1" Nipple	7.58
884-045	4-1/2" Long 1" Nipple	8.89
884-050	5" Long 1" Nipple	8.89
884-055	5-1/2" Long 1" Nipple	9.72
884-060	6" Long 1" Nipple	10.42



MEDICAL SOLUTIONS INTERNATIONAL  
 5646 MERRIAM DRIVE  
 MERRIAM, KS 66203  
[www.medicalsolutionskc.com](http://www.medicalsolutionskc.com)

800.326.5275  
 913.438.9700  
 FAX 913.438.9701

## NIPPLES 1-1/4"

PART NUMBER	PRODUCT DESCRIPTION	PRICE \$
885-005	Close 1-1/4" Nipple	7.58
885-015	1-1/2" Long 1-1/4" Nipple	7.70
885-020	2" Long 1-1/4" Nipple	7.80
885-025	2-1/2" Long 1-1/4" Nipple	8.84
885-030	3" Long 1-1/4" Nipple	8.84
885-035	3-1/2" Long 1-1/4" Nipple	7.72
885-040	4" Long 1-1/4" Nipple	7.72
885-045	4-1/2" Long 1-1/4" Nipple	7.97
885-050	5" Long 1-1/4" Nipple	9.66
885-055	5-1/2" Long 1-1/4" Nipple	8.48
885-060	6" Long 1-1/4" Nipple	13.00



## NIPPLES 1-1/2"

PART NUMBER	PRODUCT DESCRIPTION	PRICE \$
886-005	Close 1-1/2" Nipple	8.28
886-015	1-1/2" Long 1-1/2" Nipple	6.99
886-020	2" Long 1-1/2" Nipple	8.22
886-025	2-1/2" Long 1-1/2" Nipple	10.05
886-030	3" Long 1-1/2" Nipple	10.42
886-035	3-1/2" Long 1-1/2" Nipple	12.12
886-040	4" Long 1-1/2" Nipple	13.92
886-045	4-1/2" Long 1-1/2" Nipple	15.66
886-050	5" Long 1-1/2" Nipple	16.20
886-055	5-1/2" Long 1-1/2" Nipple	17.98
886-060	6" Long 1-1/2" Nipple	16.74



MEDICAL SOLUTIONS INTERNATIONAL  
5646 MERRIAM DRIVE  
MERRIAM, KS 66203  
[www.medicalsolutionskc.com](http://www.medicalsolutionskc.com)

800.326.5275  
913.438.9700  
FAX 913.438.9701

BALL VALVES		
PART NUMBER	PRODUCT DESCRIPTION	PRICE \$
BV-A1610-015	1-1/2" ASHAI True Union Ball Valve	194.40
BV-6621-007	3/4" Compact Ball Valve TXT	72.40
BV-2121-010	1" Compact Ball Valve TXT	184.98
BV-6622-007	3/4" Compact Ball Valve SXS	72.4
BV-2122-010	1" Compact Ball Valve SXS	221.80
BV-2122-015	1-1/2" Compact Ball Valve SXS	230.86
BV-2264F4MB	1/4" Female Thread x Male Barb Labcock Ball Valve	57.34
BV-2621-005G	1/2" Utility Ball Valve TXT (GRAY)	36.40
BV-2621-005W	1/2" Sample Port Ball Valve TXT (WHITE)	29.48
BV-2621-SAMPLE	1/2" Sample Port Ball Valve Set up	36.40
BV-ASHAI-3WAY	ASHAI 3 WAY 1/2" Ball Valve Tee TYPE 23	221.50
BV-PVC-350E	Ball Valve 1/2" 3 WAY (w/gray handle)	83.50
BV-SMC-25FF	Ball Valve 1/4" Female NPT x 1/4" Female NPT	22.99
BV-SMC-25MF	Ball Valve 1/4" Male NPT x 1/4" Female NPT	28.84
BV-SS-4F	Ball Valve Stainless Steel 1/4" Male x Female NPT	26.38



MEDICAL SOLUTIONS INTERNATIONAL  
 5646 MERRIAM DRIVE  
 MERRIAM, KS 66203  
[www.medicalsolutionskc.com](http://www.medicalsolutionskc.com)

800.326.5275  
 913.438.9700  
 FAX 913.438.9701

## CHECK VALVES

PART NUMBER	PRODUCT DESCRIPTION	PRICE \$
CV-4529-005	1/2" Check Valve True Union Ball Check	111.58
CV-4529-007	3/4" Check Valve True Union Ball Check	126.40
CV-4529-010	1" Check Valve True Union Ball Check	158.26
CV-4529-015	1-1/2" Check Valve True Union Ball Check	252.12
CV-6858F8F-E	1/2" Check Valve Black	23.90
CV-68712F12F	3/4" Check Valve Black	26.99



## GATE VALVES

PART NUMBER	PRODUCT DESCRIPTION	PRICE \$
GV-2021-005	1/2" Threaded Gate Valve	72.12
GV-2021-010	1" Threaded Gate Valve	98.53
GV-2022-005	1/2" Socket Gate Valve	66.60
GV-2022-010	1" Socket Gate Valve	98.53



MEDICAL SOLUTIONS INTERNATIONAL  
 5646 MERRIAM DRIVE  
 MERRIAM, KS 66203  
[www.medicalsolutionskc.com](http://www.medicalsolutionskc.com)

800.326.5275  
 913.438.9700  
 FAX 913.438.9701

# BARBED FITTINGS

47

PVC		
PART NUMBER	PRODUCT DESCRIPTION	PRICE \$
HB-P4MCB4	1/4" Male NPT x 1/4" Barb (black)	1.48
HB-P4MEB4	1/4" Male NPT x 1/4" Barb Elbow (black)	1.94
1407-010	1" Female NPT X 1" Barb Elbow	8.24
1407-131	3/4" Female NPT X 1" Barb Elbow	7.44
1413-007	3/4" Male NPT X 3/4" Barb Elbow	9.16
1413-010	1" Male NPT X 1" Barb Elbow	11.94
1413-101	1/2" Male NPT X 3/4" Barb Elbow	11.34
1435-007	3/4" Female NPT X 3/4" Barb Elbow	12.68
1436-007	3/4" Male NPT X 3/4" Barb Straight	7.82
1436-010	1" Male NPT X 1" Barb Straight	8.73
1436-074	1/2 Male NPT X 3/4" Barb Straight	8.30
1436-101	3/4" Male NPT x 1/2" Barb Straight	6.50
1436-102	3/4" Male NPT X 1" Barb Straight	8.68
1436-131	1" Male NPT X 3/4" Barb Straight	7.74

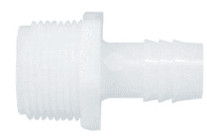

POLYPROPYLENE FITTINGS		
PART NUMBER	PRODUCT DESCRIPTION	PRICE \$
POLY-64822	1/2" Male NPT X 3/8" Barb Straight	1.82
POLY-64489	1/2" Male NPT X 3/8" Barb Elbow	1.82

CUSTOM FAUCET		
PART NUMBER	PRODUCT DESCRIPTION	PRICE \$
PVC-80-005	1/2" Formed Faucet	28.06



MEDICAL SOLUTIONS INTERNATIONAL  
 5646 MERRIAM DRIVE  
 MERRIAM, KS 66203  
[www.medicalsolutionskc.com](http://www.medicalsolutionskc.com)

800.326.5275  
 913.438.9700  
 FAX 913.438.9701

# QUICK DISCONNECT FITTINGS

48



## GARDEN HOSE THREAD BODY POLYSULFONE (white)

PART NUMBER	FLOW	PRODUCT DESCRIPTION	PRICE \$
QD-HFCD101235GHT	3/8"	3/4" MGHT PSF Inline coupling insert w/Shut-off	38.90
QD-HFCD191235GHT	3/8"	3/4" FGHT PSF Inline coupling insert w/Shut-off	49.99
QD-HFC101235GHT	3/8"	3/8" MGHT PSF Coupler body Straight-thru	44.95
QD-HFC191235GHT	3/8"	3/4" FGHT PSF Coupler body Straight-thru	54.24



## HIGH FLOW COUPLINGS BODIES POLYPROPYLENE (gray)

PART NUMBER	FLOW	PRODUCT DESCRIPTION	PRICE \$
QD-HFCD10612	3/8"	3/8" MNPT PP Coupler body w/Shut-off	40.20
QD-HFCD10812	3/8"	1/2" MNPT PP Coupler body w/Shut-off	39.99
QD-HFC10612	3/8"	3/8" MNPT PSF Coupler body Straight-thru	34.14
QD-HFC10812	3/8"	1/2" MNPT PSF Coupler body Straight-thru	31.78



## HIGH FLOW COUPLINGS BODIES POLYSULFONE (white)

PART NUMBER	FLOW	PRODUCT DESCRIPTION	PRICE \$
QD-HFCD10635	3/8"	3/8" MNPT PSF Coupler body w/Shut-off	45.56
QD-HFCD10835	3/8"	1/2" MNPT PSF Coupler body w/Shut-off	45.56
QD-HFC10635	3/8"	3/8" MNPT PSF Coupler body Straight-thru	49.26
QD-HFC10835	3/8"	1/2" MNPT PSF Coupler body Straight-thru	45.88



MEDICAL SOLUTIONS INTERNATIONAL  
 5646 MERRIAM DRIVE  
 MERRIAM, KS 66203  
[www.medicalsolutionskc.com](http://www.medicalsolutionskc.com)

800.326.5275  
 913.438.9700  
 FAX 913.438.9701

## IN-LINE HOSE BARB BODY POLYPROPYLENE (gray)

PART NUMBER	FLOW	PRODUCT DESCRIPTION	PRICE \$
QD-HFCD17612	3/8"	3/8" ID PP Barbed Inline body w/Shut-off	41.92
QD-HFCD17812	3/8"	1/2" ID PP Barbed Inline body w/Shut-off	39.96
QD-HFCD171212	3/8"	3/4" ID PP Barbed Inline body w/Shut-off	42.92
QD-HFC17612	3/8"	3/8" ID PP Barbed inline body Straight-thru	34.20
QD-HFC17812	3/8"	1/2" ID PP Barbed inline body Straight-thru	34.99
QD-HFC171212	3/8"	3/4" ID PP Barbed inline body Straight-thru	37.28



## IN-LINE HOSE BARB BODY POLYSULFONE (white)

PART NUMBER	FLOW	PRODUCT DESCRIPTION	PRICE \$
QD-HFCD17635	3/8"	3/8" ID PSF Barbed Inline body w/Shut-off	51.96
QD-HFCD17835	3/8"	1/2" ID PSF Barbed Inline body w/Shut-off	49.99
QD-HFCD171235	3/8"	3/4" ID PSF Barbed Inline body w/Shut-off	49.99



## PANEL MOUNT HOSE BARB BODY POLYPROPYLENE (gray)

PART NUMBER	FLOW	PRODUCT DESCRIPTION	PRICE \$
QD-HFCD16612	3/8"	3/8" ID PP Panel mount body w/Shut-off	49.99
QD-HFCD16812	3/8"	1/2" ID PP Panel mount body w/Shut-off	49.99
QD-HFCD161212	3/8"	3/4" ID PP Panel mount body w/Shut-off	45.56
QD-HFC16612	3/8"	3/8" ID PP Panel mount body Straight-thru	48.76
QD-HFC16812	3/8"	1/2" ID PP Panel mount body Straight-thru	48.16
QD-HFC161212	3/8"	3/4" ID PP Panel mount body Straight-thru	50.98



## PANEL MOUNT HOSE BARB BODY POLYSULFONE (white)

PART NUMBER	FLOW	PRODUCT DESCRIPTION	PRICE \$
QD-HFCD16635	3/8"	3/8" ID PSF Panel mount body w/Shut-off	49.99
QD-HFCD16835	3/8"	1/2" ID PSF Panel mount body w/Shut-off	49.99
QD-HFCD161235	3/8"	3/4" ID PSF Panel mount body w/Shut-off	49.99
QD-HFC16635	3/8"	3/8" ID PSF Panel mount body Straight-thru	59.92
QD-HFC16835	3/8"	1/2" ID PSF Panel mount body Straight-thru	58.18
QD-HFC161235	3/8"	3/4" ID PSF Panel mount body Straight-thru	50.38



MEDICAL SOLUTIONS INTERNATIONAL  
 5646 MERRIAM DRIVE  
 MERRIAM, KS 66203  
[www.medicalsolutionske.com](http://www.medicalsolutionske.com)

800.326.5275  
 913.438.9700  
 FAX 913.438.9701

## HIGH FLOW COUPLING INSERTS

### GARDEN HOSE THREAD INSERT POLYSULFONE (white)

PART NUMBER	FLOW	PRODUCT DESCRIPTION	PRICE \$
QD-HFCD261235GHT	3/8"	3/4" FGHT PSF Inline coupling insert w/Shut-off	34.26
QD-HFC241235GHT	3/8"	3/4" MGHT PSF Inline coupling insert Straight-thru	17.82
QD-HFC261235GHT	3/8"	3/4" FGHT PSF Inline coupling insert Straight-thru	32.76
QD-HFCD241235GHT	3/8"	3/4" MGHT PSF Inline coupling insert w/Shut-off	42.92



### PIPE THREAD INSERT POLYPROPYLENE (gray)

PART NUMBER	FLOW	PRODUCT DESCRIPTION	PRICE \$
QD-HFCD24612	3/8"	3/8" MNPT PP Inline coupling insert w/Shut-off	32.62
QD-HFCD24812	3/8"	1/2" MNPT PP Inline coupling insert w/Shut-off	25.42
QD-HFC24612	3/8"	3/8" MNPT PP Inline coupling insert Straight-thru	15.42
QD-HFC24812	3/8"	1/2" MNPT PP Inline coupling insert Straight-thru	25.42



### PIPE THREAD INSERT POLYSULFONE (white)

PART NUMBER	FLOW	PRODUCT DESCRIPTION	PRICE \$
QD-HFCD24635	3/8"	3/8" MNPT PSF Inline coupling insert w/Shut-off	39.76
QD-HFCD24835	3/8"	1/2" MNPT PSF Inline coupling insert w/Shut-off	29.95
QD-HFC24635	3/8"	3/8" MNPT PSF Inline coupling insert Straight-thru	26.56
QD-HFC24835	3/8"	1/2" MNPT PSF Inline coupling insert Straight-thru	19.68



MEDICAL SOLUTIONS INTERNATIONAL  
 5646 MERRIAM DRIVE  
 MERRIAM, KS 66203  
[www.medicalsolutionskc.com](http://www.medicalsolutionskc.com)

800.326.5275  
 913.438.9700  
 FAX 913.438.9701

## HIGH FLOW COUPLING INSERTS

### HOSE BARB INSERT POLYPROPYLENE (gray)

PART NUMBER	FLOW	PRODUCT DESCRIPTION	PRICE \$
QD-HFCD22612	3/8"	3/8" ID PP Barbed coupling insert w/Shut-off	32.08
QD-HFCD22812	3/8"	1/2" ID PP Barbed coupling insert w/Shut-off	32.42
QD-HFCD221212	3/8"	3/4" ID PP Barbed coupling insert w/Shut-off	33.06
QD-HFC22612	3/8"	3/8" ID PP Barbed coupling insert Straight-thru	14.99
QD-HFC22812	3/8"	1/2" ID PP Barbed coupling insert Straight-thru	16.56
QD-HFC221212	3/8"	3/4" ID PP Barbed coupling insert Straight-thru	17.72



### HOSE BARB INSERT POLYSULFONE (white)

PART NUMBER	FLOW	PRODUCT DESCRIPTION	PRICE \$
QD-HFCD22635	3/8"	3/8" ID PSF Barbed coupling insert w/Shut-off	36.22
QD-HFCD22835	3/8"	1/2" ID PSF Barbed coupling insert w/Shut-off	36.22
QD-HFCD221235	3/8"	3/4" ID PSF Barbed coupling insert w/Shut-off	38.38
QD-HFC22635	3/8"	3/8" ID PSF Barbed coupling insert Straight-thru	21.24
QD-HFC22835	3/8"	1/2" ID PSF Barbed coupling insert Straight-thru	21.66
QD-HFC221235	3/8"	3/4" ID PSF Barbed coupling insert Straight-thru	23.46



### ELBOW HOSE BARB INSERT POLYPROPYLENE (gray)

PART NUMBER	FLOW	PRODUCT DESCRIPTION	PRICE \$
QD-HFCD23612	3/8"	3/8" ID PP Barbed coupling insert w/Shut-off	37.92
QD-HFCD23812	3/8"	1/2" ID PP Barbed coupling insert w/Shut-off	38.16
QD-HFC23612	3/8"	3/8" ID PP Barbed elbow insert Straight-thru	24.90
QD-HFC23812	3/8"	1/2" ID PP Barbed elbow insert Straight-thru	24.74



### ELBOW HOSE BARB INSERT POLYSULFONE (white)

PART NUMBER	FLOW	PRODUCT DESCRIPTION	PRICE \$
QD-HFCD23635	3/8"	3/8" ID PSF Barbed coupling insert w/Shut-off	45.22
QD-HFCD23835	3/8"	1/2" ID PSF Barbed coupling insert w/Shut-off	45.26
QD-HFC23635	3/8"	3/8" ID PSF Barbed elbow insert Straight-thru	25.35
QD-HFC23835	3/8"	1/2" ID PSF Barbed elbow insert Straight-thru	28.74



MEDICAL SOLUTIONS INTERNATIONAL  
 5646 MERRIAM DRIVE  
 MERRIAM, KS 66203  
[www.medicalsolutionskc.com](http://www.medicalsolutionskc.com)

800.326.5275  
 913.438.9700  
 FAX 913.438.9701

# QUICK DISCONNECT FITTINGS

52

## LOW FLOW COUPLING INSERTS

### MALE PIPE THREAD ACETAL (white)

PART NUMBER	FLOW	PRODUCT DESCRIPTION	PRICE \$
QD-PMC1002	1/8"	1/8" MT Pipe thread body Straight-thru	17.42
QD-PMC1004	1/8"	1/4" MT Pipe thread body Straight-thru	13.55
QD-PLC10004	1/4"	1/4" MT Pipe thread body Straight-thru	25.50
QD-PLC10006	1/4"	3/8" MT Pipe thread body Straight-thru	18.42
QD-PMCD1002	1/8"	1/8" MT Pipe thread body w/Shut-off	15.68
QD-PMCD1004	1/8"	1/4" MT Pipe thread body w/Shut-off	15.68
QD-PLCD10006	1/4"	3/8" MT Pipe thread body w/Shut-off	14.72



### MALE PIPE THREAD POLYPRO (beige)

PART NUMBER	FLOW	PRODUCT DESCRIPTION	PRICE \$
QD-PMC100212	1/8"	1/8" MT Pipe thread body Straight-thru	19.28
QD-PMC100412	1/8"	1/4" MT Pipe thread body Straight-thru	15.76
QD-PLC1000412	1/4"	1/4" MT Pipe thread body Straight-thru	19.28
QD-PLC1000612	1/4"	3/8" MT Pipe thread body Straight-thru	20.18
QD-PMCD100212	1/8"	1/8" MT Pipe thread body w/Shut-off	17.33
QD-PMCD100412	1/8"	1/4" MT Pipe thread body w/Shut-off	17.93
QD-PLCD1000412	1/4"	3/8" MT Pipe thread body w/Shut-off	18.54
QD-PLCD1000612	1/4"	3/8" MT Pipe thread body w/Shut-off	20.18



MEDICAL SOLUTIONS INTERNATIONAL  
5646 MERRIAM DRIVE  
MERRIAM, KS 66203  
[www.medicalsolutionskc.com](http://www.medicalsolutionskc.com)

800.326.5275  
913.438.9700  
FAX 913.438.9701

## LOW FLOW COUPLING INSERTS

<b>IN-LINE HOSE BARB ACETAL (white)</b>			
PART NUMBER	FLOW	PRODUCT DESCRIPTION	PRICE \$
QD-PMC1701	1/8"	1/16" Barb inline body Straight-thru	14.84
QD-PMC1702	1/8"	1/8" Barb inline body Straight-thru	10.06
QD-PMC1704	1/8"	1/4" Barb inline body Straight-thru	9.88
QD-PLC17004	1/4"	1/4" Barb inline body Straight-thru	8.99
QD-PLC17006	1/4"	3/8" Barb inline body Straight-thru	9.99
QD-PMCD1701	1/8"	1/16" Barb inline body w/Shut-off	18.76
QD-PMCD1702	1/8"	1/8" Barb inline body w/Shut-off	19.32
QD-PMCD1704	1/8"	1/4" Barb inline body w/Shut-off	19.32
QD-PLCD17004	1/4"	1/4" Barb inline body w/Shut-off	14.02
QD-PLCD17006	1/4"	3/8" Barb inline body w/Shut-off	14.02



<b>IN-LINE HOSE BARB POLYPRO (beige)</b>			
PART NUMBER	FLOW	PRODUCT DESCRIPTION	PRICE \$
QD-PMC170212	1/8"	1/16" Barb inline body Straight-thru	22.70
QD-PMC170412	1/8"	1/4" Barb inline body Straight-thru	23.54
QD-PLC1700412	1/4"	1/4" Barb inline body Straight-thru	29.94
QD-PLC1700612	1/4"	3/8" Barb inline body Straight-thru	21.48
QD-PMCD170112	1/8"	1/16" Barb inline body w/Shut-off	35.18
QD-PMCD170212	1/8"	1/8" Barb inline body w/Shut-off	22.72
QD-PMCD170412	1/8"	1/4" Barb inline body w/Shut-off	31.90
QD-PLCD1700612	1/4"	3/8" Barb inline body w/Shut-off	32.54



MEDICAL SOLUTIONS INTERNATIONAL  
 5646 MERRIAM DRIVE  
 MERRIAM, KS 66203  
[www.medicalsolutionskc.com](http://www.medicalsolutionskc.com)

800.326.5275  
 913.438.9700  
 FAX 913.438.9701

# QUICK DISCONNECT FITTINGS

54

## LOW FLOW COUPLING INSERTS

### PANEL-MOUNT HOSE BARB ACETAL (white)

PART NUMBER	FLOW	PRODUCT DESCRIPTION	PRICE \$
QD-PMC1601NA	1/8"	1/16" Barb panel mount body Straight-thru	17.49
QD-PMC1602NA	1/8"	1/8" Barb panel mount body Straight-thru	16.11
QD-PMC1604NA	1/8"	1/4" Barb panel mount body Straight-thru	16.16
QD-PLC16004NA	1/4"	1/4" Barb panel mount body Straight-thru	19.85
QD-PMCD1601NA	1/8"	1/16" Barb panel mount body w/Shut-off	25.34
QD-PMCD1602NA	1/8"	1/8" Barb panel mount body w/Shut-off	25.35
QD-PMCD1604NA	1/8"	1/4" Barb panel mount body w/Shut-off	28.34
QD-PLCD16004NA	1/4"	1/4" Barb panel mount body w/Shut-off	40.70
QD-PLCD16006NA	1/4"	3/8" Barb panel mount body w/Shut-off	40.70



### PANEL-MOUNT HOSE BARB POLYPRO (beige)

PART NUMBER	FLOW	PRODUCT DESCRIPTION	PRICE \$
QD-PMC160112NA	1/8"	1/16" Barb panel mount body Straight-thru	18.58
QD-PMC160212NA	1/8"	1/8" Barb panel mount body Straight-thru	18.73
QD-PMC16042NA	1/8"	1/4" Barb panel mount body Straight-thru	16.32
QD-PLC1600412NA	1/4"	1/4" Barb panel mount body Straight-thru	31.00
QD-PLC1600612NA	1/4"	3/8" Barb panel mount body Straight-thru	23.62
QD-PMCD160112NA	1/8"	1/16" Barb panel mount body w/Shut-off	20.63
QD-PMCD160212NA	1/8"	1/8" Barb panel mount body w/Shut-off	20.98
QD-PMCD160412NA	1/8"	1/4" Barb panel mount body w/Shut-off	21.52
QD-PLCD1600412NA	1/4"	1/4" Barb panel mount body w/Shut-off	46.67
QD-PLCD1600612NA	1/4"	3/8" Barb panel mount body w/Shut-off	45.12



MEDICAL SOLUTIONS INTERNATIONAL  
 5646 MERRIAM DRIVE  
 MERRIAM, KS 66203  
[www.medicalsolutionskc.com](http://www.medicalsolutionskc.com)

800.326.5275  
 913.438.9700  
 FAX 913.438.9701

# QUICK DISCONNECT FITTINGS

55

## LOW FLOW COUPLING INSERTS

### IN-LINE FERRULESS COMPRESSION FITTING ACETAL (white)

PART NUMBER	FLOW	PRODUCT DESCRIPTION	PRICE \$
QD-PMC1304NA	1/8"	1/4" OD Inline body Straight-thru	16.76
QD-PLC13006NA	1/4"	3/8" OD Inline body Straight-thru	21.60
QD-PMCD1304NA	1/8"	1/4" OD Inline body w/Shut-off	22.20
QD-PLCD13006NA	1/4"	3/8" OD Inline body w/Shut-off	45.28



### IN-LINE FERRULESS COMPRESSION FITTING POLYPRO (beige)

PART NUMBER	FLOW	PRODUCT DESCRIPTION	PRICE \$
QD-PMC130412NA	1/8"	1/4" OD Inline body Straight-thru	28.19
QD-PLC1300612NA	1/4"	3/8" OD Inline body Straight-thru	17.24
QD-PMCD130412NA	1/8"	1/4" OD Inline body w/Shut-off	28.19
QD-PLCD1300612NA	1/4"	3/8" OD Inline body w/Shut-off	44.44

### PANEL-MOUNT FERRULESS COMPRESSION FITTING ACETAL (white)

PART NUMBER	FLOW	PRODUCT DESCRIPTION	PRICE \$
QD-PMC1204NA	1/8"	1/4" OD Panel mount body Straight-thru	18.49
QD-PLC12006NA	1/4"	3/8" OD Panel mount body Straight-thru	29.47
QD-PMCD1204NA	1/8"	1/4" OD Panel mount body w/Shut-off	18.74
QD-PLCD12006NA	1/4"	3/8" OD Panel mount body w/Shut-off	28.12



### PANEL-MOUNT FERRULESS COMPRESSION FITTING POLYPRO (beige)

PART NUMBER	FLOW	PRODUCT DESCRIPTION	PRICE \$
QD-PMC120412NA	1/8"	1/4" OD Panel mount body Straight-thru	32.74
QD-PLC1200612NA	1/4"	3/8" OD Panel mount body Straight-thru	45.12
QD-PMCD120412NA	1/8"	1/4" OD Panel mount body w/Shut-off	32.28
QD-PLCD1200612NA	1/4"	3/8" OD Panel mount body w/Shut-off	46.67

MEDICAL SOLUTIONS INTERNATIONAL  
 5646 MERRIAM DRIVE  
 MERRIAM, KS 66203  
[www.medicalsolutionskc.com](http://www.medicalsolutionskc.com)

800.326.5275  
 913.438.9700  
 FAX 913.438.9701

## LOW FLOW COUPLING INSERTS

### STRAIGHT HOSE BARB ACETAL (white)

PART NUMBER	FLOW	PRODUCT DESCRIPTION	PRICE \$
QD-PMC2201	1/8"	1/16" Barb CPLG INS Straight-thru	9.38
QD-PMC2202	1/8"	1/8" Barb CPLG INS Straight-thru	6.38
QD-PMC2204	1/8"	1/4" Barb CPLG INS Straight-thru	6.81
QD-PMC22004	1/8"	1/4" Barb CPLG INS Straight-thru	6.51
QD-PLC22006	1/4"	3/8" Barb CPLG INS Straight-thru	4.02
QD-PMCD2201	1/8"	1/16" Barb CPLG INS w/Shut-off	12.43
QD-PMCD2202	1/8"	1/8" Barb CPLG INS w/Shut-off	11.26
QD-PMCD2204	1/8"	1/8" Barb CPLG INS w/Shut-off	11.26
QD-PLCD22004	1/8"	1/4" Barb CPLG INS w/Shut-off	13.35
QD-PLCD22006	1/8"	3/8" Barb CPLG INS w/Shut-off	12.95



### STRAIGHT HOSE BARB POLYPRO (beige)

PART NUMBER	FLOW	PRODUCT DESCRIPTION	PRICE \$
QD-PMC220112	1/8"	1/16" Barb valve hose Straight-thru	9.47
QD-PMC220212	1/8"	1/8" Barb valve hose Straight-thru	8.11
QD-PMC220412	1/8"	1/4" Barb valve hose Straight-thru	8.94
QD-PLC2200412	1/4"	1/4" Barb valve hose Straight-thru	21.85
QD-PLC2200612	1/4"	3/8" Barb valve hose Straight-thru	8.51
QD-PMCD220112	1/8"	1/16" Barb valve hose w/Shut-off	25.51
QD-PMCD220212	1/8"	1/8" Barb valve hose w/Shut-off	24.82
QD-PMCD220412	1/8"	1/4" Barb valve hose w/Shut-off	27.85
QD-PLCD2200412	1/4"	1/4" Barb valve hose w/Shut-off	21.48
QD-PLCD2200612	1/4"	3/8" Barb valve hose w/Shut-off	22.42

MEDICAL SOLUTIONS INTERNATIONAL  
 5646 MERRIAM DRIVE  
 MERRIAM, KS 66203  
[www.medicalsolutionskc.com](http://www.medicalsolutionskc.com)

800.326.5275  
 913.438.9700  
 FAX 913.438.9701

## LOW FLOW COUPLING INSERTS

### STRAIGHT FERRULESS COMPRESSION FITTING ACETAL (white)

PART NUMBER	FLOW	PRODUCT DESCRIPTION	PRICE \$
QD-PMC2004NA	1/8"	1/4" OD Compression Straight-thru	16.70
QD-PMC2006NA	1/8"	3/8" OD Compression Straight-thru	15.70
QD-PLC20006NA	1/4"	3/8" OD Compression Straight-thru	12.93
QD-PMCD2004NA	1/8"	1/4" OD Compression w/Shut-off	28.42
QD-PMCD2006NA	1/8"	3/8" OD Compression w/Shut-off	37.34
QD-PLCD20006NA	1/4"	3/8" OD Compression w/Shut-off	18.48



### STRAIGHT FERRULESS COMPRESSION FITTING POLYPRO (beige)

PART NUMBER	FLOW	PRODUCT DESCRIPTION	PRICE \$
QD-PMC200412NA	1/8"	1/4" OD Compression Straight-thru	11.98
QD-PLC2000612NA	1/4"	3/8" OD Compression Straight-thru	13.04
QD-PMCD200412NA	1/8"	1/4" OD Compression w/Shut-off	26.88
QD-PLCD2000612NA	1/4"	3/8" OD Compression w/Shut-off	25.70



### PANEL MOUNT FERRULESS COMPRESSION FITTING ACETAL

PART NUMBER	FLOW	PRODUCT DESCRIPTION	PRICE \$
QD-PMC4004NA	1/8"	1/4" OD Panel mount compression Straight-thru	14.12
QD-PLC40004NA	1/4"	1/4" OD Panel mount compression Straight-thru	15.46
QD-PLC40006NA	1/4"	3/8" OD Panel mount compression Straight-thru	16.21
QD-PMCD4004NA	1/8"	1/4" OD Panel mount compression w/Shut-off	15.73
QD-PLCD40004NA	1/4"	1/4" OD Panel mount compression w/Shut-off	17.76
QD-PLCD40006NA	1/4"	3/8" OD Panel mount compression w/Shut-off	18.63



MEDICAL SOLUTIONS INTERNATIONAL  
 5646 MERRIAM DRIVE  
 MERRIAM, KS 66203  
[www.medicalsolutionskc.com](http://www.medicalsolutionskc.com)

800.326.5275  
 913.438.9700  
 FAX 913.438.9701

## LOW FLOW COUPLING INSERTS

### ELBOW HOSE BARB ACETAL (white)

PART NUMBER	FLOW	PRODUCT DESCRIPTION	PRICE \$
QD-PMC2302	1/8"	1/8" ID Barbed elbow Straight-thru	8.47
QD-PMC2304	1/8"	1/4" ID Barbed elbow Straight-thru	9.72
QD-PLC23004	1/4"	1/4" ID Barbed elbow Straight-thru	9.98
QD-PLC23006	1/4"	3/8" ID Barbed elbow Straight-thru	8.48
QD-PMCD2302	1/8"	1/8" ID Barbed elbow w/Shut-off	13.63
QD-PMCD2304	1/8"	1/4" ID Barbed elbow w/Shut-off	13.63
QD-PLCD23004	1/4"	1/4" ID Barbed elbow w/Shut-off	13.23
QD-PLCD23006	1/4"	3/8" ID Barbed elbow w/Shut-off	13.23



### ELBOW HOSE BARB POLYPRO (beige)

PART NUMBER	FLOW	PRODUCT DESCRIPTION	PRICE \$
QD-PMC230212	1/8"	1/8" ID Barbed elbow Straight-thru	12.57
QD-PMC230412	1/8"	1/4" ID Barbed elbow Straight-thru	18.98
QD-PLC2300412	1/4"	1/4" ID Barbed elbow Straight-thru	15.96
QD-PLC2300612	1/4"	3/8" ID Barbed elbow Straight-thru	25.95
QD-PMCD230212	1/8"	1/8" ID Barbed elbow w/Shut-off	27.98
QD-PMCD230412	1/8"	1/4" ID Barbed elbow w/Shut-off	18.81
QD-PLCD2300412	1/4"	1/4" ID Barbed elbow w/Shut-off	18.98
QD-PLCD2300612	1/4"	3/8" ID Barbed elbow w/Shut-off	19.01



### PANEL MOUNT HOSE BARB ACETAL (white)

PART NUMBER	FLOW	PRODUCT DESCRIPTION	PRICE \$
QD-PMC4202NA	1/8"	1/8" ID Barb panel-mount Straight-thru	14.83
QD-PMC4204NA	1/8"	1/4" ID Barb panel-mount Straight-thru	13.96
QD-PLC42004NA	1/4"	1/4" ID Barb panel-mount Straight-thru	16.98
QD-PLCD42004NA	1/4"	1/4" ID Barb panel-mount w/Shut-off	18.85
QD-PLC42006NA	1/4"	3/8" ID Barb panel-mount Straight-thru	14.67



MEDICAL SOLUTIONS INTERNATIONAL  
 5646 MERRIAM DRIVE  
 MERRIAM, KS 66203  
[www.medicalsolutionskc.com](http://www.medicalsolutionskc.com)

800.326.5275  
 913.438.9700  
 FAX 913.438.9701

## LOW FLOW COUPLING INSERTS

### ELBOW FERRULESS COMPRESSION FITTING ACETAL (white)

PART NUMBER	FLOW	PRODUCT DESCRIPTION	PRICE \$
QD-PMC2104NA	1/8"	1/4" OD Elbow Straight-thru	11.69
QD-PMC2106NA	1/8"	3/8" OD Elbow Straight-thru	11.66
QD-PMCD2104NA	1/8"	1/4" OD Elbow w/Shut-off	19.67
QD-PLCD21006NA	1/4"	3/8" OD Elbow w/Shut-off	19.47



### ELBOW FERRULESS COMPRESSION FITTING POLYPRO (beige)

PART NUMBER	FLOW	PRODUCT DESCRIPTION	PRICE \$
QD-PLC2100612NA	1/4"	3/8" OD PP Elbow Straight-thru	16.23
QD-PMCD210412NA	1/8"	1/4" OD PP Elbow w/Shut-off	24.93
QD-PLCD2100612NA	1/4"	3/8" OD PP Elbow w/Shut-off	24.63

### PIPE THREAD ACETAL (white)

PART NUMBER	FLOW	PRODUCT DESCRIPTION	PRICE \$
QD-PMC2402	1/8"	1/8" Male pipe thread Straight-thru	9.74
QD-PMC2404	1/8"	1/4" Male pipe thread Straight-thru	9.74
QD-PLC24004	1/4"	1/4" Male pipe thread Straight-thru	9.62
QD-PLC24006	1/4"	3/8" Male pipe thread Straight-thru	9.99
QD-PMCD2402	1/8"	1/8" Male pipe thread w/Shut-off	19.24
QD-PMCD2404	1/8"	1/4" Male pipe thread w/Shut-off	19.34



### PIPE THREAD POLYPRO (beige)

PART NUMBER	FLOW	PRODUCT DESCRIPTION	PRICE \$
QD-PMC240212	1/8"	1/8" PP Male pipe thread Straight-thru	12.53
QD-PLC2400412	1/4"	1/8" PP Male pipe thread Straight-thru	16.08
QD-PMCD240212	1/8"	1/8" PP Male pipe thread w/Shut-off	17.83
QD-PLCD2400412	1/4"	1/4" PP Male pipe thread w/Shut-off	19.86



MEDICAL SOLUTIONS INTERNATIONAL  
 5646 MERRIAM DRIVE  
 MERRIAM, KS 66203  
[www.medicalsolutionske.com](http://www.medicalsolutionske.com)

800.326.5275  
 913.438.9700  
 FAX 913.438.9701

## PARKER MALE CONNECTOR

PART NUMBER	PRODUCT DESCRIPTION	PRICE \$
P4MC2	1/4" Tube Compression X 1/8" Male NPT	3.84
P4MC4	1/4" Tube Compression X 1/4" Male NPT	3.99
P5MC2	5/16" Tube Compression X 1/8" Male NPT	7.60
P5MC4	5/16" Tube Compression X 1/4" Male NPT	4.48
P6MC2	3/8" Tube Compression X 1/8" Male NPT	5.22
P6MC4	3/8" Tube Compression X 1/4" Male NPT	4.84
P6MC6	3/8" Tube Compression X 3/8" Male NPT	5.48
P6MC8	3/8" Tube Compression X 1/2" Male NPT	7.20
P6MC12	3/8" Tube Compression X 1/8" Male NPT	8.97
P8MC2	1/2" Tube Compression X 1/8" Male NPT	8.99
P8MC4	1/2" Tube Compression X 1/4" Male NPT	5.99
P8MC6	1/2" Tube Compression X 3/8" Male NPT	6.46
P8MC8	1/2" Tube Compression X 1/2" Male NPT	6.90
P8MC12	1/2" Tube Compression X 3/4" Male NPT	9.99
P10MC2	5/8" Tube Compression X 1/8" Male NPT	9.67
P10MC4	5/8" Tube Compression X 1/4" Male NPT	9.66
P10MC6	5/8" Tube Compression X 3/8" Male NPT	8.83
P10MC8	5/8" Tube Compression X 1/2" Male NPT	8.64
P10MC12	5/8" Tube Compression X 3/4" Male NPT	9.88



## PARKER FEMALE CONNECTOR

PART NUMBER	PRODUCT DESCRIPTION	PRICE \$
P4FC2	1/4" Tube Compression X 1/8" Female NPT	8.34
P4FC4	1/4" Tube Compression X 1/4" Female NPT	6.48
P6FC4	3/8" Tube Compression X 1/4" Female NPT	6.08
P6FC6	3/8" Tube Compression X 3/8" Female NPT	9.34
P6FC8	3/8" Tube Compression X 1/2" Female NPT	8.82
P8FC6	1/2" Tube Compression X 3/8" Female NPT	13.40
P8FC8	1/2" Tube Compression X 1/2" Female NPT	11.30
P10FC8	5/8" Tube Compression X 1/2" Female NPT	9.66



MEDICAL SOLUTIONS INTERNATIONAL  
 5646 MERRIAM DRIVE  
 MERRIAM, KS 66203  
[www.medicalsolutionskc.com](http://www.medicalsolutionskc.com)

800.326.5275  
 913.438.9700  
 FAX 913.438.9701

## PARKER MALE BRANCH TEE

PART NUMBER	PRODUCT DESCRIPTION	PRICE \$
P4MT2	1/4" Tube Compression X 1/8" Male NPT	10.80
P4MT4	1/4" Tube Compression X 1/4" Male NPT	9.54
P5MT2	5/16" Tube Compression X 1/8" Male NPT	14.98
P5MT4	5/16" Tube Compression X 1/4" Male NPT	16.32
P6MT4	3/8" Tube Compression X 1/4" Male NPT	10.68
P6MT6	3/8" Tube Compression X 3/8" Male NPT	12.74
P8MT6	1/2" Tube Compression X 3/8" Male NPT	18.54
P8MT8	1/2" Tube Compression X 1/2" Male NPT	19.66
P10MT8	5/8" Tube Compression X 1/2" Male NPT	14.64



## PARKER MALE ELBOW

PART NUMBER	PRODUCT DESCRIPTION	PRICE \$
P4ME2	1/4" Tube Compression X 1/8" Male NPT	5.54
P4ME4	1/4" Tube Compression X 1/4" Male NPT	5.06
P4ME6	1/4" Tube Compression X 3/8" Male NPT	6.08
P5ME2	5/16" Tube Compression X 1/8" Male NPT	9.42
P5ME4	5/16" Tube Compression X 1/4" Male NPT	9.42
P5ME6	5/16" Tube Compression X 3/8" Male NPT	10.48
P6ME4	3/8" Tube Compression X 1/4" Male NPT	6.80
P6ME6	3/8" Tube Compression X 3/8" Male NPT	7.18
P6ME8	3/8" Tube Compression X 1/2" Male NPT	5.29
P8ME12	1/2" Tube Compression X 3/4" Male NPT	10.88
P8ME8	1/2" Tube Compression X 1/2" Male NPT	8.98
P10ME8	5/8" Tube Compression X 1/2" Male NPT	9.30



## PARKER FEMALE ELBOW

PART NUMBER	PRODUCT DESCRIPTION	PRICE \$
P4FE2	1/4" Tube Compression X 1/8" Female NPT	7.58
P4FE4	1/4" Tube Compression X 1/4" Female NPT	7.98
P5FE2	1/4" Tube Compression X 5/16" Female NPT	13.76
P6FE4	3/8" Tube Compression X 1/4" Female NPT	8.88
P6FE6	3/8" Tube Compression X 3/8" Female NPT	6.92
P8FE6	1/2" Tube Compression X 3/8" Female NPT	9.68
P8FE8	1/2" Tube Compression X 1/2" Female NPT	10.80
P10FE8	5/8" Tube Compression X 5/8" Female NPT	9.70



MEDICAL SOLUTIONS INTERNATIONAL  
 5646 MERRIAM DRIVE  
 MERRIAM, KS 66203  
[www.medicalsolutionskc.com](http://www.medicalsolutionskc.com)

800.326.5275  
 913.438.9700  
 FAX 913.438.9701

## PARKER TEE UNION

PART NUMBER	PRODUCT DESCRIPTION	PRICE \$
P4TU4	1/4" X 1/4" Tube Compression Tee	11.68
P5TU5	5/16" X 5/16" Tube Compression Tee	14.98
P6TU6	3/8" X 3/8" Tube Compression Tee	12.04
P6TU10	3/8" X 5/8" Tube Compression Tee	18.82
P8TU6	1/2" X 3/8" Tube Compression Tee	12.99
P8TU8	1/2" X 1/2" Tube Compression Tee	13.17
P10TU6	5/8" X 3/8" Tube Compression Tee	19.99
P10TU10	5/8" X 5/8" Tube Compression Tee	19.99



## PARKER UNION CONNECTOR

PART NUMBER	PRODUCT DESCRIPTION	PRICE \$
P4UC4	1/4" X 1/4" Tube Compression Union	5.84
P5UC4	5/16" X 1/4" Tube Compression Union	8.99
P5UC5	5/16" X 5/16" Tube Compression Union	7.30
P6UC4	3/8" X 1/4" Tube Compression Union	7.44
P6UC5	3/8" X 5/16" Tube Compression Union	8.46
P6UC6	3/8" X 3/8" Tube Compression Union	7.26
P8UC6	1/2" X 3/8" Tube Compression Union	8.84
P8UC8	1/2" X 1/2" Tube Compression Union	8.96
P10UC6	5/8" X 3/8" Tube Compression Union	10.42
P10UC8	5/8" X 1/2" Tube Compression Union	10.86
P10UC10	5/8" X 5/8" Tube Compression Union	11.58



## PARKER ELBOW UNION

PART NUMBER	PRODUCT DESCRIPTION	PRICE \$
P4EU4	1/4" X 1/4" Tube Comp Elbow Union	8.24
P5EU4	5/16" X 1/4" Tube Comp Elbow Union	14.14
P5EU5	5/16" X 5/16" Tube Comp Elbow Union	14.24
P6EU4	3/8" X 1/4" Tube Comp Elbow Union	12.60
P6EU5	3/8" X 5/16" Tube Comp Elbow Union	12.77
P6EU6	3/8" X 3/8" Tube Comp Elbow Union	10.54
P8EU6	1/2" X 3/8" Tube Comp Elbow Union	10.99
P8EU8	1/2" X 1/2" Tube Comp Elbow Union	12.86
P10EU10	5/8" X 5/8" Tube Comp Elbow Union	13.99



MEDICAL SOLUTIONS INTERNATIONAL  
 5646 MERRIAM DRIVE  
 MERRIAM, KS 66203  
[www.medicalsolutionskc.com](http://www.medicalsolutionskc.com)

800.326.5275  
 913.438.9700  
 FAX 913.438.9701

<b>MUR-LOK COMPRESSION TEE</b>		
PART NUMBER	PRODUCT DESCRIPTION	PRICE \$
ML-A0630405	3/8" Compression X 1/4" Female NPT	20.94
ML-A0630425	3/8" Compression X 1/4" ML	24.44
ML-A0630625	3/8" Compression X 3/8" ML	24.96
ML-A0630825	3/8" Compression X 1/2" ML	27.02
ML-A0830405	1/2" Compression X 1/4" Female NPT	20.94
ML-A0830425	1/2" Compression X 1/4" ML	24.44
ML-A0830625	1/2" Compression X 3/8" ML	24.96
ML-A0830825	1/2" Compression X 1/2" ML	27.02
ML-A1030405	5/8" Compression X 1/4" Female NPT	21.26
ML-A1030425	5/8" Compression X 1/4" ML	24.82
ML-A1030625	5/8" Compression X 3/8" ML	25.34
ML-A1030825	5/8" Compression X 1/2" ML	27.56



<b>MUR-LOK IN-LINE BALL VALVES</b>		
PART NUMBER	PRODUCT DESCRIPTION	PRICE \$
ML-G0400405	1/4" Female NPT X 1/4" Female NPT	16.56
ML-G0400415	1/4" Female NPT X 1/4" Male NPT	16.56
ML-G0420405	1/4" ML X 1/4" Female NPT	22.04
ML-G0420415	1/4" ML X 1/4" Male NPT	14.25
ML-G0420425	1/4" ML X 1/4" ML	14.25
ML-G0420625	1/4" ML X 3/8" ML	14.38
ML-G0420825	1/4" ML X 1/2" ML	19.46
ML-G0600605	3/8" Female NPT X 3/8" Female NPT	17.78
ML-G0600615	3/8" Female NPT X 3/8" Male NPT	17.78
ML-G0620405	3/8" ML X 1/4" Female NPT	18.92
ML-G0620415	3/8" ML X 1/4" Male NPT	18.92
ML-G0620615	3/8" ML X 3/8" Male NPT	14.25
ML-G0620625	3/8" ML X 3/8" ML	14.25
ML-G0620825	3/8" ML X 1/2" ML	19.90
ML-G0820615	1/2" ML X 3/8" Male NPT	17.08
ML-G0820825	1/2" ML X 1/2" ML	17.78



**MEDICAL SOLUTIONS INTERNATIONAL**  
 5646 MERRIAM DRIVE  
 MERRIAM, KS 66203  
[www.medicalsolutionskc.com](http://www.medicalsolutionskc.com)

800.326.5275  
 913.438.9700  
 FAX 913.438.9701

## MURLOK MALE NPTF CONNECTORS

PART NUMBER	PRODUCT DESCRIPTION	PRICE \$
ML-O0420216	1/4" ML X 1/8" Male NPT	3.12
ML-O0420416	1/4" ML X 1/4" Male NPT	3.40
ML-O0420616	1/4" ML X 3/8" Male NPT	4.90
ML-O0520416	5/16" ML X 1/4" Male NPT	3.78
ML-O0620216	3/8" ML X 1/8" Male NPT	7.16
ML-O0620416	3/8" ML X 1/4" Male NPT	5.38
ML-O0620616	3/8" ML X 3/8" Male NPT	6.16
ML-O0620816	3/8" ML X 1/2" Male NPT	9.56
ML-O0820616	1/2" ML X 3/8" Male NPT	8.34
ML-O0820816	1/2" ML X 1/2" Male NPT	8.98



## MUR-LOK FIXED NPTF ELBOWS

PART NUMBER	PRODUCT DESCRIPTION	PRICE \$
ML-P0420206	1/4" ML X 1/8" Female NPT	6.64
ML-P0420216	1/4" ML X 1/8" Male NPT	4.88
ML-P0420416	1/4" ML X 1/4" Male NPT	5.52
ML-P0420616	1/4" ML X 3/8" Male NPT	6.65
ML-P0520416	5/16" ML X 1/4" Male NPT	6.94
ML-P0620416	3/8" ML X 1/4" Male NPT	7.34
ML-P0620616	3/8" ML X 3/8" Male NPT	7.52



## MUR-LOK UNION & REDUCING ELBOWS

PART NUMBER	PRODUCT DESCRIPTION	PRICE \$
ML-Q0420426	1/4" ML X 1/4" ML	5.52
ML-Q0520426	5/16" ML X 1/4" ML	7.06
ML-Q0520526	5/16" ML X 5/16" ML	6.38
ML-Q0620426	3/8" ML X 1/4" ML	9.18
ML-Q0620526	3/8" ML X 5/16" ML	9.18
ML-Q0620626	3/8" ML X 3/8" ML	8.34
ML-Q0820626	1/2" ML X 3/8" ML	10.84
ML-Q0820826	1/2" ML X 1/2" ML	9.90



MEDICAL SOLUTIONS INTERNATIONAL  
 5646 MERRIAM DRIVE  
 MERRIAM, KS 66203  
[www.medicalsolutionskc.com](http://www.medicalsolutionskc.com)

800.326.5275  
 913.438.9700  
 FAX 913.438.9701

# MUR-LOK FITTINGS

65

## MUR-LOK REDUCERS

PART NUMBER	PRODUCT DESCRIPTION	PRICE \$
ML-S0420566	1/4" ML X 5/16" Stem	4.66
ML-S0420666	1/4" ML X 3/8" Stem	5.36
ML-S0520666	5/16" ML X 3/8" Stem	5.87
ML-S0620866	3/8" ML X 1/2" Stem	6.43



## MUR-LOK NPTF STEM ADAPTERS

PART NUMBER	PRODUCT DESCRIPTION	PRICE \$
ML-S0460216	1/4" Stem X 1/8" Male NPT	1.98
ML-S0460416	1/4" Stem X 1/4" Male NPT	1.98
ML-S0660416	3/8" Stem X 1/4" Male NPT	3.12
ML-S0660616	3/8" Stem X 3/8" Male NPT	3.98
ML-S0860816	1/2" Stem X 1/2" Male NPT	4.34



## MUR-LOK TUBE TO HOSE STEM ELBOWS

PART NUMBER	PRODUCT DESCRIPTION	PRICE \$
ML-S0460448	1/4" Stem X 1/4" BARB	3.98



## MUR-LOK TUBE TO HOSE STEMS

PART NUMBER	PRODUCT DESCRIPTION	PRICE \$
ML-S0460446	1/4" Stem X 1/4" BARB	3.12
ML-S0660646	3/8" Stem X 3/8" BARB	4.88
ML-S0660846	3/8" Stem X 1/2" BARB	6.64
ML-S0860846	1/2" Stem X 1/2" BARB	6.48



MEDICAL SOLUTIONS INTERNATIONAL  
 5646 MERRIAM DRIVE  
 MERRIAM, KS 66203  
[www.medicalsolutionskc.com](http://www.medicalsolutionskc.com)

800.326.5275  
 913.438.9700  
 FAX 913.438.9701

## MUR-LOK FITTINGS-PLUG IN ELBOWS

PART NUMBER	PRODUCT DESCRIPTION	PRICE \$
ML-T0420466	1/4" ML X 1/4" Stem	4.96
ML-T0420666	1/4" ML X 3/8" Stem	6.72
ML-T0520566	5/16" ML X 5/16" Stem	7.46
ML-T0620666	3/8" ML X 3/8" Stem	8.52
ML-T0820866	1/2" ML X 1/2" Stem	10.18



## MUR-LOK FITTINGS-UNION TEES

PART NUMBER	PRODUCT DESCRIPTION	PRICE \$
ML-V0420426	1/4" ML X 1/4" ML X 1/4" ML	6.92
ML-V0420526	1/4" ML X 1/4" ML X 5/16" ML	8.08
ML-V0520526	5/16" ML X 5/16" ML X 5/16" ML	7.26
ML-V0620426	3/8" ML X 3/8" ML X 1/4" ML	9.70
ML-V0620626	3/8" ML X 3/8" ML X 3/8" ML	6.32
ML-V0820426	1/2" ML X 1/2" ML X 1/4" ML	15.74
ML-V0820626	1/2" ML X 1/2" ML X 3/8" ML	8.86
ML-V0820826	1/2" ML X 1/2" ML X 1/2" ML	7.98
ML-V0820866	1/2" ML X 1/2" ML X 1/2" Stem	6.56



## MUR-LOK FITTINGS-FEMALE CONNECTORS

PART NUMBER	PRODUCT DESCRIPTION	PRICE \$
ML-U0420206	1/4" ML X 1/8" Female NPTF	7.02
ML-U0420406	1/4" ML X 1/4" Female NPTF	7.62
ML-U0620406	3/8" ML X 1/4" Female NPTF	8.78



MEDICAL SOLUTIONS INTERNATIONAL  
 5646 MERRIAM DRIVE  
 MERRIAM, KS 66203  
[www.medicalsolutionskc.com](http://www.medicalsolutionskc.com)

800.326.5275  
 913.438.9700  
 FAX 913.438.9701

NYLON GARDEN HOSE FITTINGS		
PART NUMBER	PRODUCT DESCRIPTION	PRICE \$
GH-TVW7	“O” RING for Garden Hose Fitting	0.50
GH-TA772	3/4” Male Garden Hose X 1/4” Male NPT	4.44
GH-TA774	3/4” Male Garden Hose X 1/2” Male NPT	3.95
GH-TA776	3/4” Male Garden Hose X 3/4” Male NPT	4.05
GH-TA792	3/4” Male Garden Hose X 1/4” Female NPT	6.78
GH-TA793	3/4” Female Garden Hose X 3/8” Male NPT	6.96
GH-TCF72	3/4" Female Garden Hose X 1/4” Barb	7.61
GH-TCF73	3/4" Female Garden Hose X 3/8” Barb	7.61
GH-TCF76	3/4" Female Garden Hose X 3/4” Barb	8.79
GH-TCM72	3/4” Male Garden Hose X 1/4” Barb	4.93
GH-TCM73	3/4” Male Garden Hose X 3/8” Barb	3.95
GH-TTA-776	3/4” Female Garden Hose X 3/4” Male NPT	7.32



NYLON WALL STATION DRAIN BARBS		
PART NUMBER	PRODUCT DESCRIPTION	PRICE \$
W-ATE2	Wallstation Drain Barb 1” Male NPT X 3/4” Barb Elbow	3.90
W-ATA1	Wallstation Drain Barb 1” Male NPT X 3/4” Barb Straight	3.22



MEDICAL SOLUTIONS INTERNATIONAL  
 5646 MERRIAM DRIVE  
 MERRIAM, KS 66203  
[www.medicalsolutionskc.com](http://www.medicalsolutionskc.com)

800.326.5275  
 913.438.9700  
 FAX 913.438.9701

TANKS		
PART NUMBER	PRODUCT DESCRIPTION	PRICE \$
T-SSTA-120	120 Gallon stackable tank	QUOTE
T-ST220	220 Gallon stackable tank w/ colored base	QUOTE
T-ST225	225 Gallon stackable tank w/colored base	QUOTE
T-SSTA-240	240 Gallon stackable tank	QUOTE
T-ST330	330 Gallon stackable tank w/colored base	QUOTE
T-10250-B	250 Gallon Conical Bottom w/ Blue Base	QUOTE
T-10250-O	250 Gallon Conical Bottom w/ Orange Base	QUOTE
T-10250-R	250 Gallon Conical Bottom w/ Red Base	QUOTE
T-10250-Y	250 Gallon Conical Bottom w/ Yellow Base	QUOTE
T-10300	300 Gallon storage tank	QUOTE
T-10500-FB	500 Gallon storage tank flat bottom	QUOTE
T-10500-CB	500 Gallon storage tank conical bottom	QUOTE
T-VC-200	Ventilation Cap for square stackable tank	47.56



ALL FORMS OF TANKS ARE AVAILABLE, WE ARE PLEASED TO QUOTE CUSTOM ORDERS.





# Medical Solutions

I N T E R N A T I O N A L

5646 Merriam Drive Merriam, Kansas 66203  
913-438-9700 Fax 913-438-9701 800-326-5275  
[www.medicalsolutionskc.com](http://www.medicalsolutionskc.com)

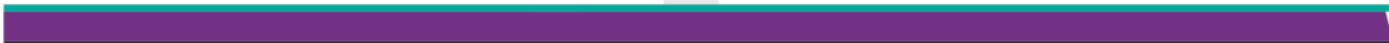

# PRODUCT OPTIONS

Image	Item	Brand	Store	Cost	Selected	Notes
	Range	Theta	Oven Shop	\$5,499	<input type="checkbox"/>	
	Range	Zeta	Oven Shop	\$3,699	<input checked="" type="checkbox"/>	
	Refrigerator	Beta	Cold Fridges	\$2,599	<input checked="" type="checkbox"/>	
	Refrigerator	Theta	Appliance Store	\$6,399	<input type="checkbox"/>	
	Dishwasher	Theta	Appliance Store	\$999	<input type="checkbox"/>	
	Dishwasher	Zeta	Appliance Store	\$1,295	<input checked="" type="checkbox"/>	
	Microwave	Theta	Appliance Store	\$359	<input checked="" type="checkbox"/>	
	Microwave	Zeta	Appliance Store	\$489	<input type="checkbox"/>	
<b>Total</b>				<b>\$7,952</b>		

# COST SUMMARY

Costs		
Task	Total Cost	Notes
Appliances	\$7,952.00	
Cabinets	\$4,500.00	
Cabinet Hardware	\$250.00	
Electrician	\$2,600.00	
Plumber	\$1,250.00	
Furniture	\$1,200.00	
Floor	\$3,200.00	
Lighting	\$475.00	
Paint	\$650.00	
<b>Total</b>	<b>\$22,077.00</b>	



Cost Overview

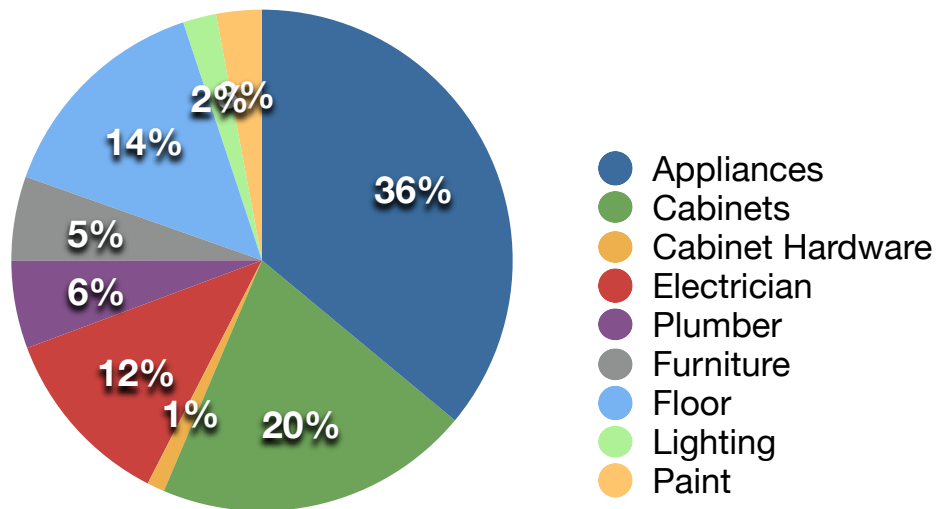

# CONTACT LIST

Company	Phone	Email	Address
Electrician	(123) 456 7890	electrician@noreply.com	1234 Main Street Anytown, State 54321
Plumber	(123) 456 7890	plumber@noreply.com	1234 Main Street Anytown, State 54321
Painter	(123) 456 7890	paint@noreply.com	1234 Main Street Anytown, State 54321